

ARTICLE FOUR DIRECTION
HERTSMERE BOROUGH COUNCIL
TOWN AND COUNTRY PLANNING ACT 1990
TOWN AND COUNTRY PLANNING GENERAL DEVELOPMENT ORDER 1988 (as amended)

Direction under Article 4 of the Town and Country Planning General Development Order 1988 (as amended) restricting permitted development rights.

RECITALS

1. Hertsmere Borough Council ('the Authority') is the local planning authority in respect of the area of land specified in this Direction.
2. The Authority is satisfied that it is expedient that development described in Schedule 2 to the Town and Country Planning General Development Order 1988 (as amended) ('the Order'), and specified in this Direction, should not be carried out unless specific permission is granted for it on a planning application.

NOW THEREFORE the Authority in pursuance of Article 4 of the Order and all other powers thereby enabling

DIRECTS THAT

The permission granted by Article 3 of the Order shall not apply to the development specified in the First Schedule to this Direction in the area specified in the Second Schedule to this Direction.

FIRST SCHEDULE

- a) **Schedule 2, Part 1, Class E:** the provision within the curtilage of a dwellinghouse of any building or enclosure, swimming or other pool required for a purpose incidental to the enjoyment of the dwellinghouse as such, or the maintenance, improvement, or other alteration of such a building or enclosure being development comprised within Part 1, Class E of Schedule 2 to the said Order and not being development comprised within any other Part or Class.

SECOND SCHEDULE

All of the land at 28 The Avenue, Radlett, in the County of Hertfordshire outlined in black on the plan annexed hereto, which equates to a strip of land 5.0 metres wide directly adjacent to the south eastern boundary of that property running from a point 5.0 metres to the rear of the house to the rear boundary.

Given under The Common Seal
of Hertsmere Borough Council

this 29th day of Jan 1994



Mr. G. L. [Signature]
Mayor

SJ/CAB/6153/DC2-10

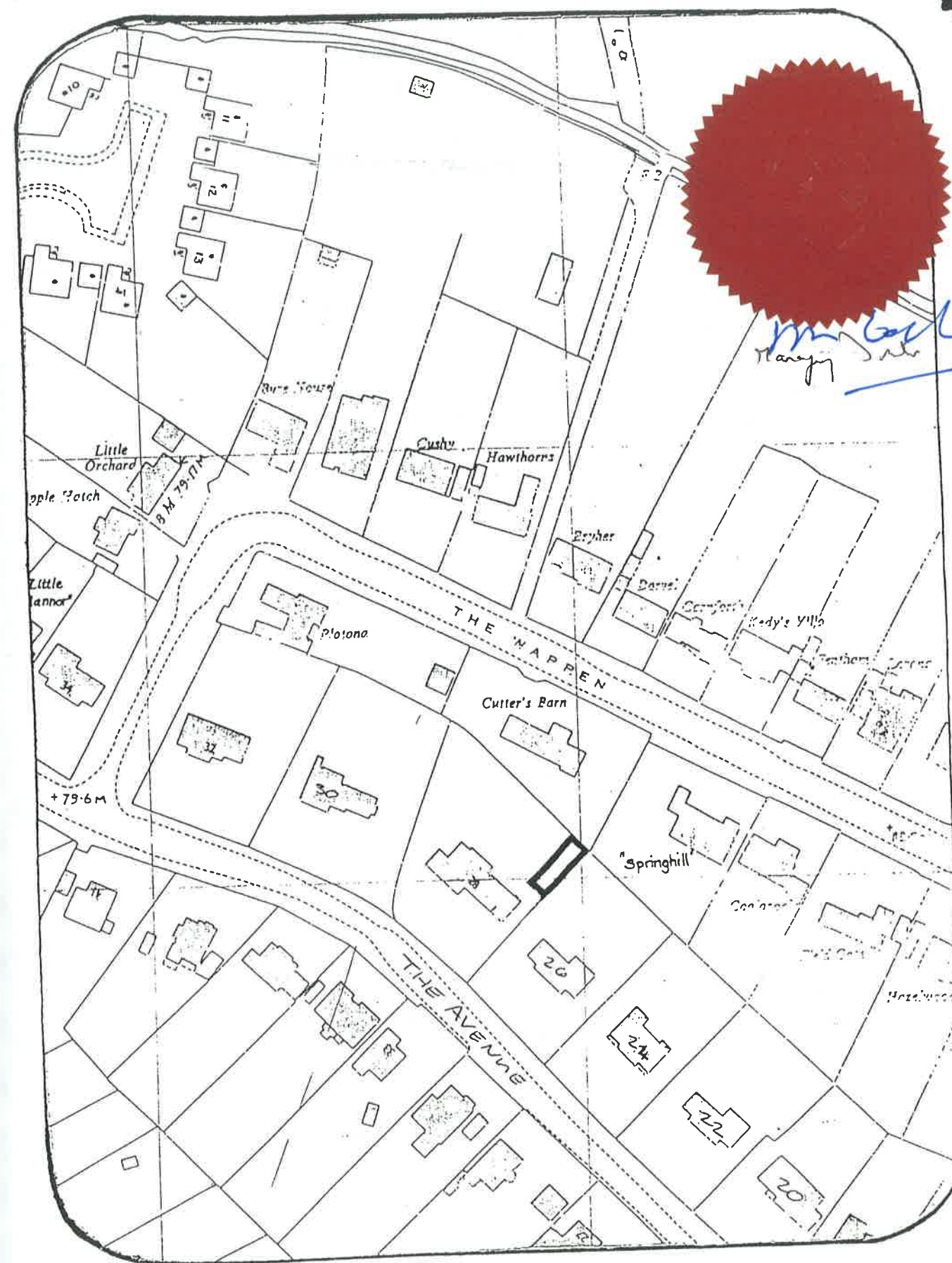

Reproduced from the Ordnance Survey
Maps with the permission of the Controller
of Her Majesty's Stationery Office.

Crown Copyright Reserved.