

# TOWN AND COUNTRY PLANNING (TREES) REGULATIONS 1999

Plan referred to in THE HERTSMERE TREE PRESERVATION ORDER (17a, 19 and 19a Watford Road, Radlett, Herts) No 21/2008

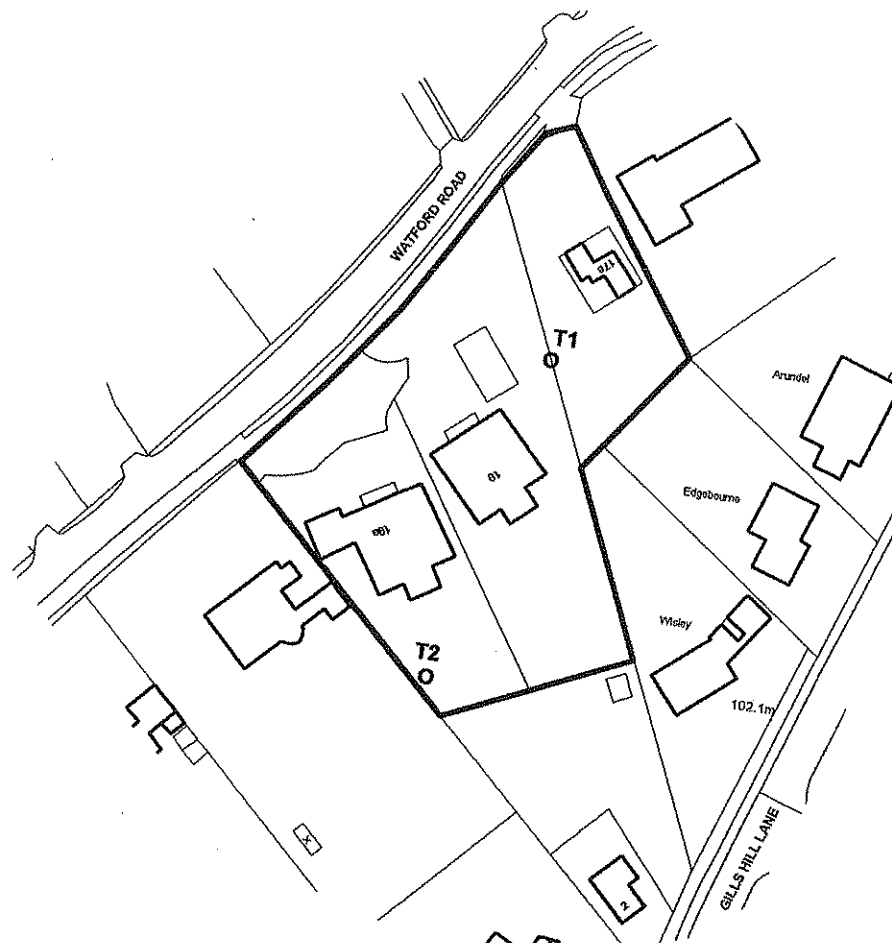

## SCHEDULE OF TREES

No	Type
T1	Copper Beech
T2	Copper Beech

This Order was confirmed by the  
Hertsmere Borough Council  
without modification  
on the SEVENTEENTH day  
of FEBRUARY in the year 2009

Signed on behalf of Hertsmere Borough Council Ninth day of  
December 2008

Authorised by the Council to sign in that behalf

*Mark Silverman*

Print name and Position MARK SILVERMAN (POLICY AND TRANSPORT MANAGER)

Reproduced from the Ordnance Survey mapping with the permission of the Controller of Her Majesty's Stationery Office.  
© Crown Copyright reserved. Unauthorised reproduction infringes Crown copyright and may lead to prosecution or civil proceedings.  
Licence Number LA078238 Hertsmere, 2001.

Map Ref: TQ 1572,9970

Hertsmere Borough Council  
Civic Offices  
Borehamwood  
Herts WD6 1WA

SCALE: 1:1250 DATE: 09/12/2008

DRAWN BY: SW CHECKED *MS*

DRAWING NUMBER: 21/2008