

TOWN AND COUNTRY PLANNING (TREES) REGULATIONS 1999

Plan referred to in THE HERTSMERE TREE PRESERVATION ORDER (20 Oakmere Lane, Potters Bar, Herts) No 20/2009

SCHEDULE OF T

No	Type
T1	Oak

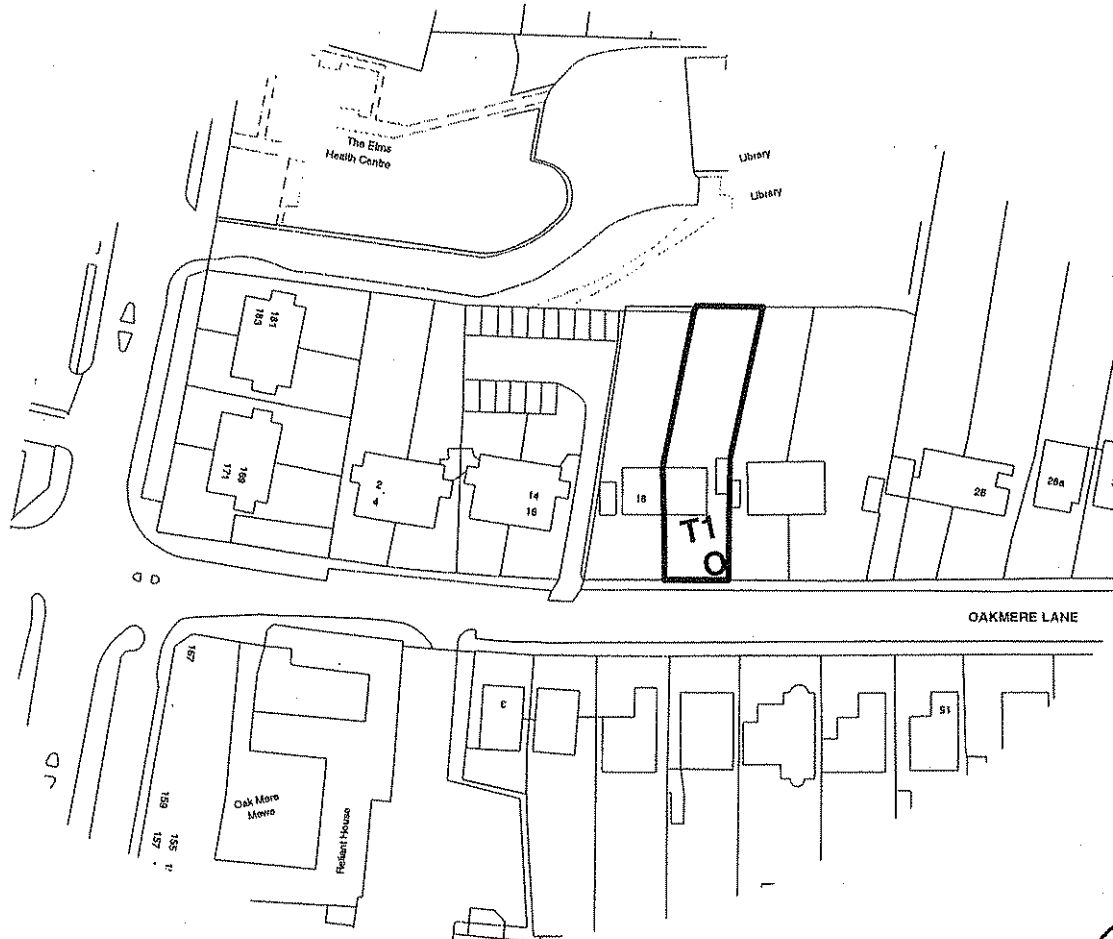

This Order was confirmed by the Hertsmeire Borough Council without modification on the TWENTY FIRST day of OCTOBER in the year



[Handwritten Signature]

Signed on behalf of Hertsmeire Borough Council Twenty First day of July 2009

Authorised by the Council to sign in that behalf:

Map Ref: TL 2631,014:

Hertsmeire Borough
Civic Office
Borehamwo
Herts WD6 1

SCALE: 1:1250