

TOWN AND COUNTRY PLANNING (TREES) REGULATIONS 1999

Plan referred to in THE HERTSMERE TREE PRESERVATION ORDER (87 Hartfield Avenue, Elstree, Herts) No 20/2010

SCHEDULE OF 1

No Type

T1 Ash

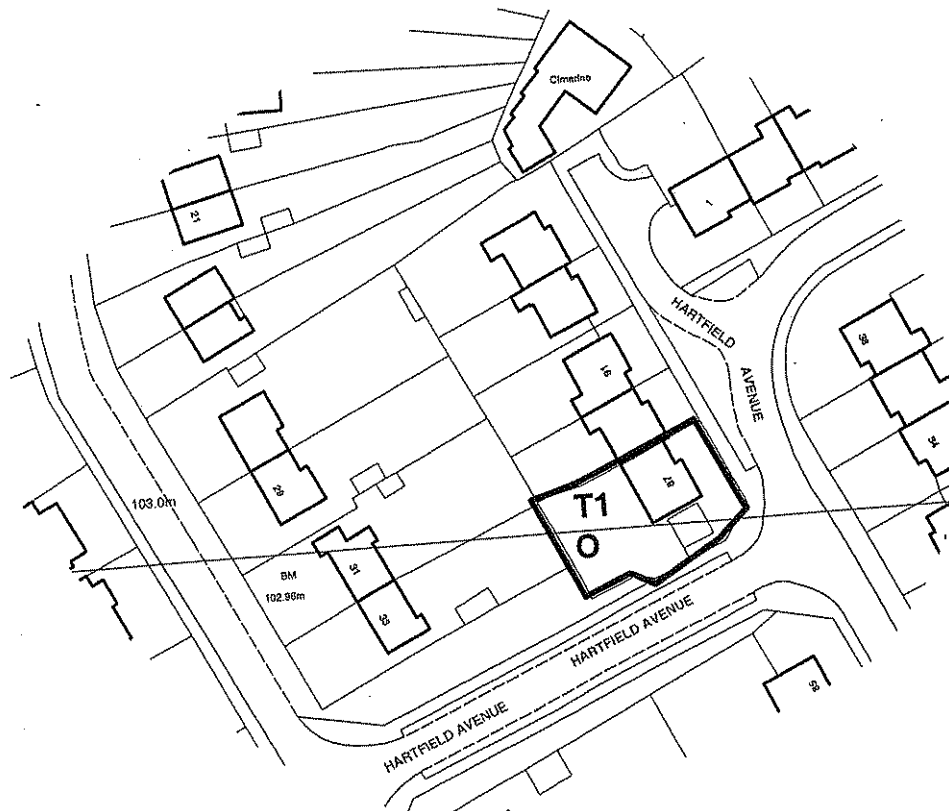

This Order was confirmed by the
Hertsmere Borough Council subject
to the modifications indicated by
the CHANCE OF ADDRESS FROM
HARTFIELD ROAD TO HALTFIELD
on the SECOND day
of JUNE in the year 2010

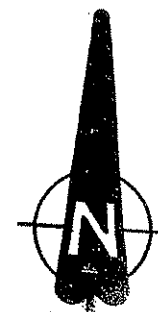

Signed on behalf of Hertsmere Borough Council Third day of
March 2010

Authorised by the Council to sign in that behalf:

[Handwritten signature]

Map Ref: TQ 1901,96

Hertsmere Borough
Civic Office
Borehamw
Herts WD6

SCALE: 1:1250