

**TOWN AND COUNTRY PLANNING  
(GENERAL PERMITTED DEVELOPMENT) ORDER 2015, AS AMENDED  
DIRECTION MADE UNDER ARTICLE 4(1)**

**HERTSMERE BOROUGH COUNCIL**

**WHEREAS** Hertsmere Borough Council (“the Council”) being the appropriate local planning authority within the meaning of article 4(5) of the Town and Country Planning (General Permitted Development) Order 2015 (“the Order”), as amended, are satisfied that it is expedient that development of the description(s) set out in the Schedule below should not be carried out on the land shown edged/coloured in red on the attached plans unless planning permission is granted on an application made under Part III of the Town and Country Planning Act 1990, as amended.

**NOW THEREFORE** the said Council in pursuance of the power conferred on them by Article 4(1) of the Order, **HEREBY DIRECT** that the permission granted by Class O of Part 3, Schedule 2 of the said Order shall not apply to the land described in the Schedule below.

**THIS DIRECTION** is made under Article 4(1) of the said Order and, in accordance with paragraph 1 of Schedule 3 of the Order shall come into force on 27 April 2020.

**SCHEDULE**

(the Permitted Development excluded by this Direction)

1. Development consisting of a change use of a building and any land within its curtilage from a use falling within Class B1(a) (offices) of the Schedule to the Town and Country Planning (Use Classes) Order 1987 (as amended), to a use falling within Class C3 (dwellinghouses) of that Schedule being development comprised within Class O of Part 3 of Schedule 2 to the Order and not being development comprised within any other Class within the identified locations listed below and as indicated in the attached plans.
  - Employment Areas – (1) Elstree Way and (2) Stirling Way, Borehamwood; (3) Cranborne Road and (4) Station Close, Potters Bar; and (5) Otterspool Way, Bushey;
  - Key Employment Site – (1) Centennial Park, Elstree; and
  - Locally Significant Employment Sites – (1) Wrotham Business Park; (2) Borehamwood Enterprise Centre and (3) Theobald Court, Borehamwood; (4) Lismirrane Industrial Park, Elstree; (5) Hollies Way, Potters Bar; (6) Beaumont Gate, Radlett; (7) Farm Close, Shenley.

Made under the Common Seal of  
Hertsmere Borough Council

this 26<sup>th</sup> day of April 2019

The Common Seal of Hertsmere Borough Council  
was affixed to this Direction in the presence of

  
.....  
Duly Authorised Officer



Confirmed under the Common Seal of  
Hertsmere Borough Council

this 22 day of April 2020

The Common Seal of Hertsmere Borough Council  
was affixed to this Direction in the presence of

  
.....  
Duly Authorised Officer



THIS DIRECTION COMES INTO FORCE ON 27 APRIL 2020 IF CONFIRMED



Duty Authorised Officer

This is the plan referred to under the Article 4(1)  
Direction made by Hertsmere Borough Council

this ... 26<sup>th</sup> ... day of April 2019

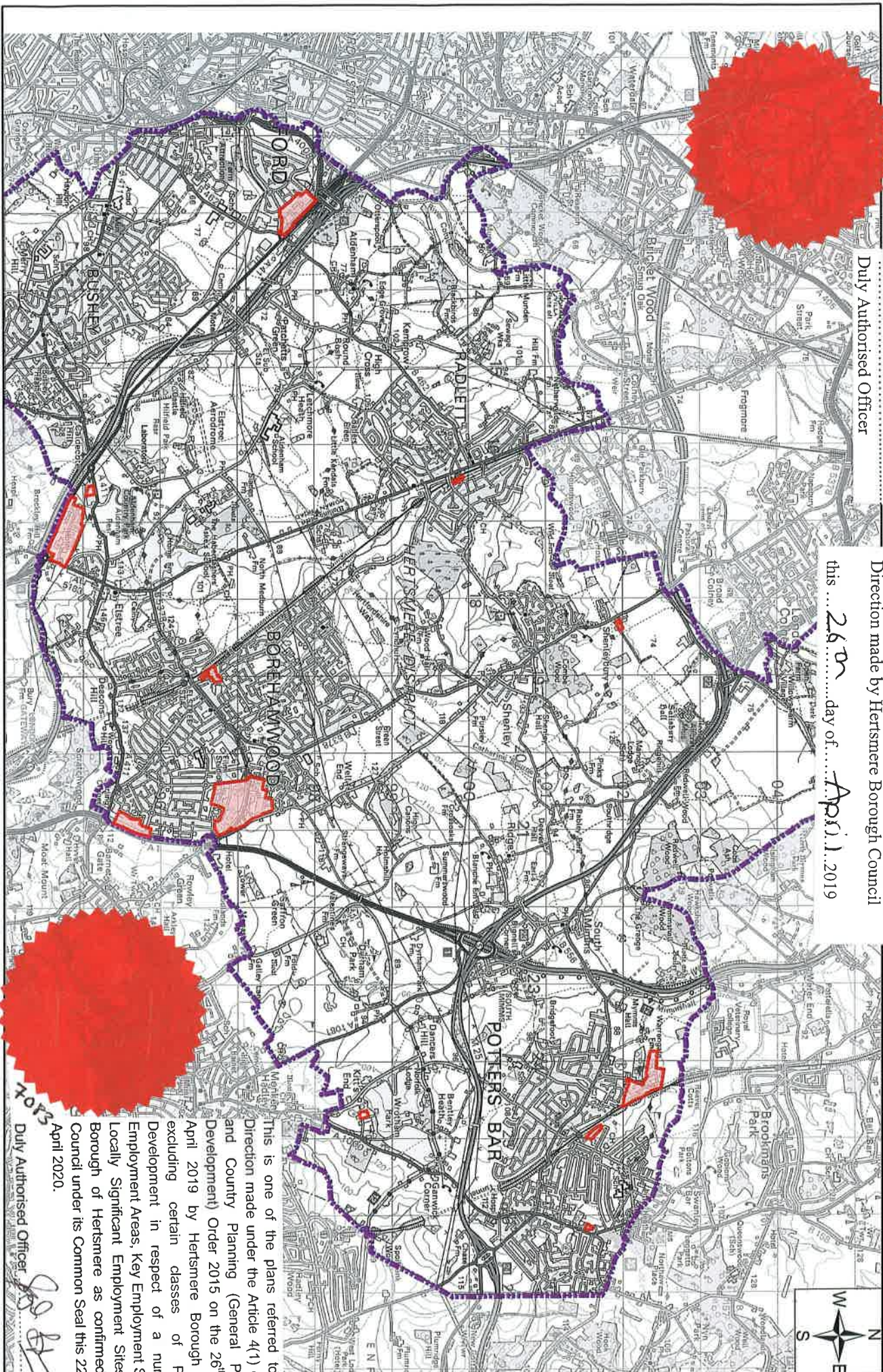



This is the plan referred to under the Article 4(1) Direction made by Hertsmere Borough Council

this 26<sup>th</sup> day of April 2019

By the Affixing of its Common Seal to this Direction in the presence of

Duly Authorised Officer

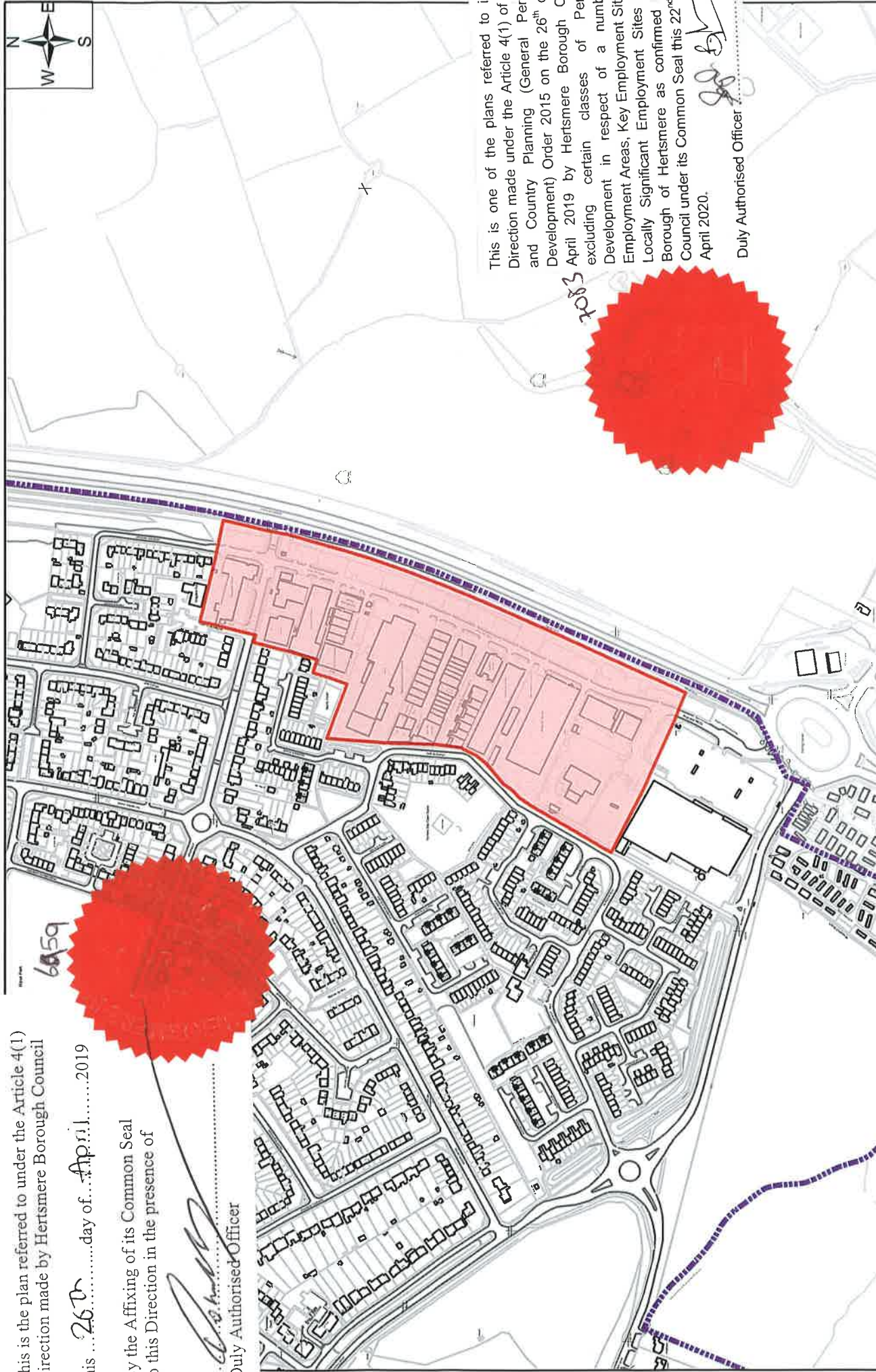
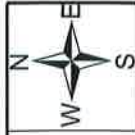

## Legend



Area to which Article 4 direction applies



Hertsmere Borough Council Boundary

## Stirling Way

0 0.032 0.065 0.13 0.195 0.26 1:5,000 Miles

This is one of the plans referred to in the Direction made under the Article 4(1) of Town and Country Planning (General Permitted Development) Order 2015 on the 26<sup>th</sup> day of April 2019 by Hertsmere Borough Council excluding certain classes of Permitted Development in respect of a number of Employment Areas, Key Employment Sites and Locally Significant Employment Sites in the Borough of Hertsmere as confirmed by the Council under its Common Seal this 22<sup>nd</sup> day of April 2020.

Duly Authorised Officer

© Crown copyright and database rights 2016 OS EUL 100017428  
You are not permitted to copy, sub-licence, distribute or sell any of this data to third parties in any form.  
You are permitted to use this data solely to enable you to respond to, or interact with, the organisation that provided you with the data.

This is the plan referred to under the Article 4(1)  
Direction made by Hertsmere Borough Council

this ~~1st~~ 26<sup>th</sup> day of April 2019

By the Affixing of its Common Seal  
to this Direction in the presence of

Duly Authorised Officer



This is one of the plans referred to in the  
Direction made under the Article 4(1) of Town  
and Country Planning (General Permitted  
Development) Order 2015 on the 26<sup>th</sup> day of  
April 2019 by Hertsmere Borough Council  
excluding certain classes of Permitted  
Development in respect of a number of  
Employment Areas, Key Employment Sites and  
Locally Significant Employment Sites in the  
Borough of Hertsmere as confirmed by the  
Council under its Common Seal this 22<sup>nd</sup> day of  
April 2020.

Duly Authorised Officer



6154

Home Farm

Vine  
Cottage

Stewards  
House

Gardeners  
Cottage

Wrotham  
Business  
Park

Engine Room

El Sub Sta

Pond

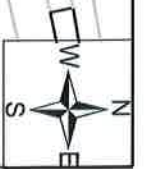

## Legend

Area to which Article 4 direction applies

## Wrotham Business Park

Hertsmere Borough Council Boundary

You are permitted to use this data solely to enable you to respond to, or interact with, the organisation that provided you with the data.

0 0.0075.015

0.03

0.045

0.06

1:1,250

Miles



© Crown copyright and database rights 2016 OS EUL 100017428



This is the plan referred to under the Article 4(1)  
Direction made by Hertsmere Borough Council

this... 26<sup>th</sup> day of April 2019

By the Affixing of its Common Seal  
to this Direction in the presence of

*[Signature]*  
Duly Authorised Officer

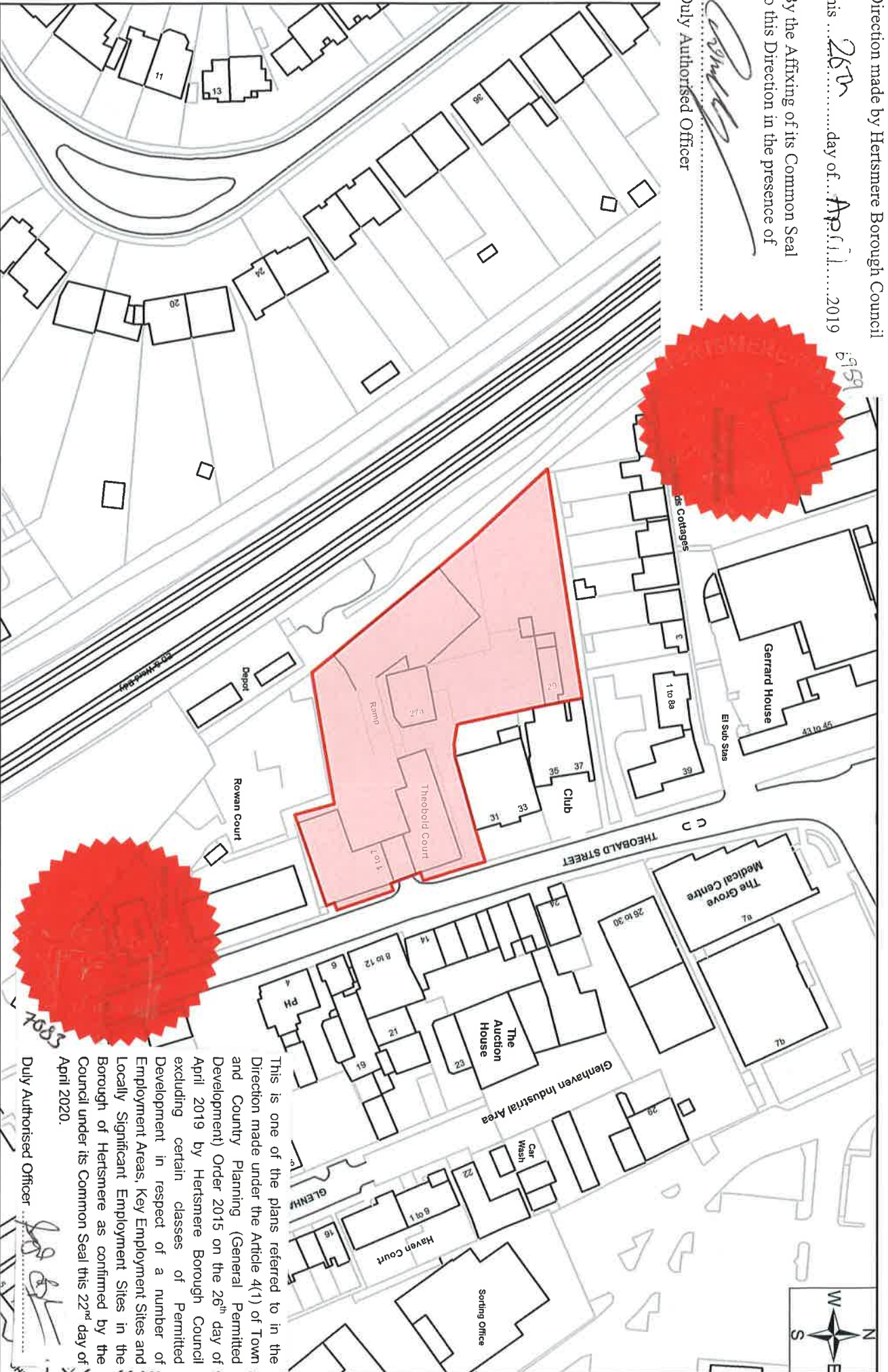

This is one of the plans referred to in the  
Direction made under the Article 4(1) of Town  
and Country Planning (General Permitted  
Development) Order 2015 on the 26<sup>th</sup> day of  
April 2019 by Hertsmere Borough Council  
excluding certain classes of Permitted  
Development in respect of a number of  
Employment Areas, Key Employment Sites and  
Locally Significant Employment Sites in the  
Borough of Hertsmere as confirmed by the  
Council under its Common Seal this 22<sup>nd</sup> day of  
April 2020.

Duly Authorised Officer

*[Signature]*



Legend

Theobald Court

Area to which Article 4 direction applies

Hertsmere Borough Council Boundary

You are permitted to use this data solely to enable you to respond to, or interact with, the organisation that provided you with the data.

You are not permitted to copy, sub-licence, distribute or sell any of this data to third parties in any form.

© Crown copyright and database rights 2016 OS EUL 100017428

0 0.0075 0.015 0.03 0.045 0.06 1:1,250  
Miles



This is the plan referred to under the Article 4(1)  
Direction made by Hertsmere Borough Council

this ... 25th day of April 2019

By the Affixing of its Common Seal  
to this Direction in the presence of

*[Signature]*  
Duly Authorised Officer

This is one of the plans referred to in the  
Direction made under the Article 4(1) of Town  
and Country Planning (General Permitted  
Development) Order 2015 on the 26th day of  
April 2019 by Hertsmere Borough Council  
excluding certain classes of Permitted  
Development in respect of a number of  
Employment Areas, Key Employment Sites and  
Locally Significant Employment Sites in the  
Borough of Hertsmere as confirmed by the  
Council under its Common Seal this 22nd day of  
April 2020.

Duly Authorised Officer  
*[Signature]*

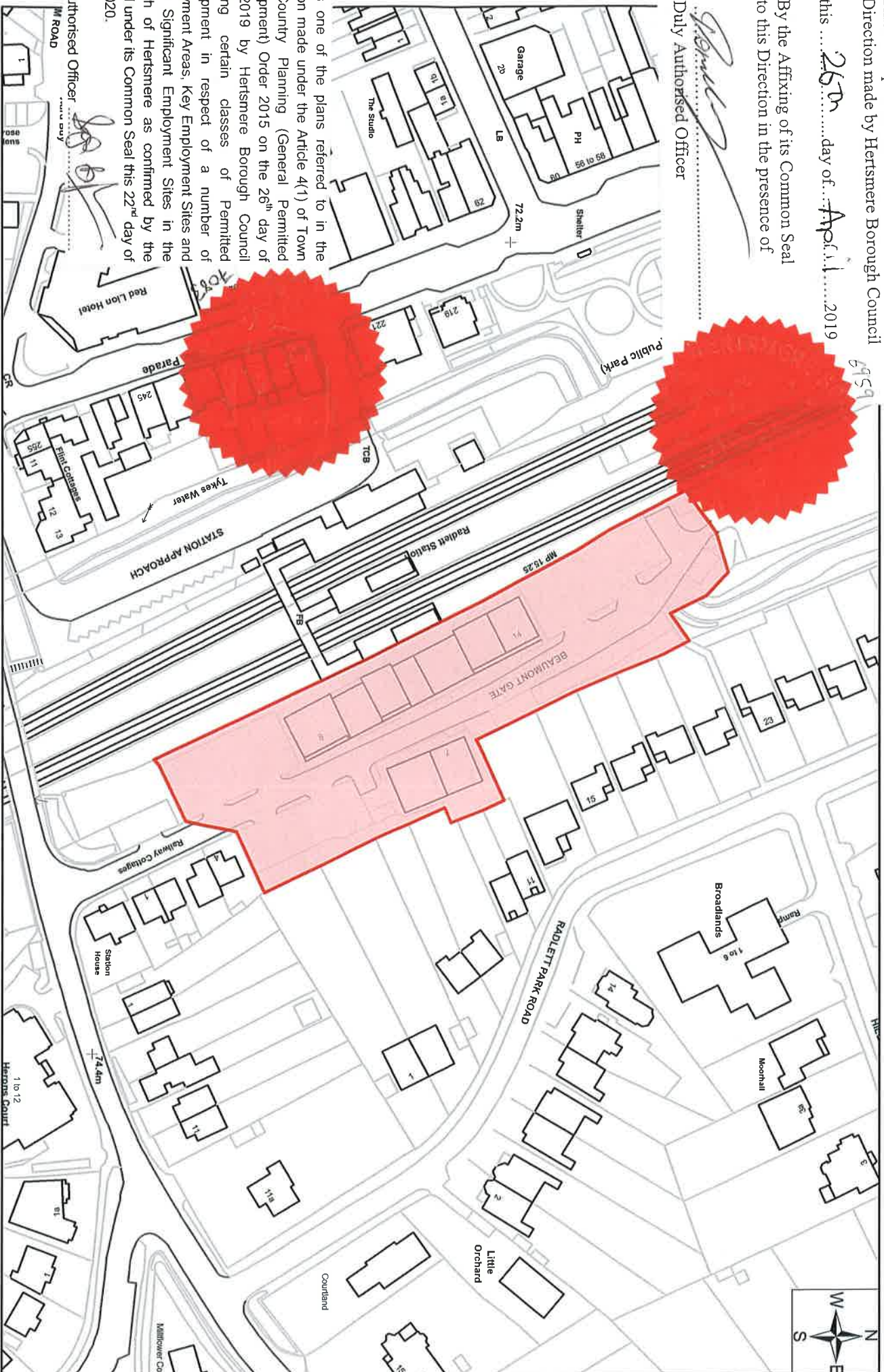

## Legend

 Area to which Article 4 direction applies

 Hertsmere Borough Council Boundary

## Beaumont Gate

0 0.0075.015 0.03 0.045 0.06 1:1,250  
Miles



HERTSMERE



This is the plan referred to under the Article 4(1) Direction made by Hertsmere Borough Council

this 26<sup>th</sup> day of April 2019

By the Affixing of its Common Seal to this Direction in the presence of

Duly Authorised Officer

This is one of the plans referred to in the Direction made under the Article 4(1) of Town and Country Planning (General Permitted Development) Order 2015 on the 26<sup>th</sup> day of April 2019 by Hertsmere Borough Council excluding certain classes of Permitted Development in respect of a number of Employment Areas, Key Employment Sites and Locally Significant Employment Sites in the Borough of Hertsmere as confirmed by the Council under its Common Seal this 22<sup>nd</sup> day of April 2020.

Duly Authorised Officer



## Legend

Area to which Article 4 direction applies

## Borehamwood Enterprise Centre

0 0.0078 0.015

0.03

0.045

0.06

Miles

1:1,250



HERTSMERE



Hertsmere Borough Council Boundary

You are permitted to use this data solely to enable you to respond to, or interact with, the organisation that provided you with the data.

You are not permitted to copy, sub-licence, distribute or sell any of this data to third parties in any form.

© Crown copyright and database rights 2016 OS EUL 100017428



This is the plan referred to under the Article 4(1) Direction made by Hertsmere Borough Council

this 26<sup>th</sup> day of April 2019

By the Affixing of its Common Seal to this Direction in the presence of

Duly Authorised Officer

This is one of the plans referred to in the Direction made under the Article 4(1) of Town and Country Planning (General Permitted Development) Order 2015 on the 26<sup>th</sup> day of April 2019 by Hertsmere Borough Council excluding certain classes of Permitted Development in respect of a number of Employment Areas, Key Employment Sites and Locally Significant Employment Sites in the Borough of Hertsmere as confirmed by the Council under its Common Seal this 22<sup>nd</sup> day of April 2020.

Duly Authorised Officer

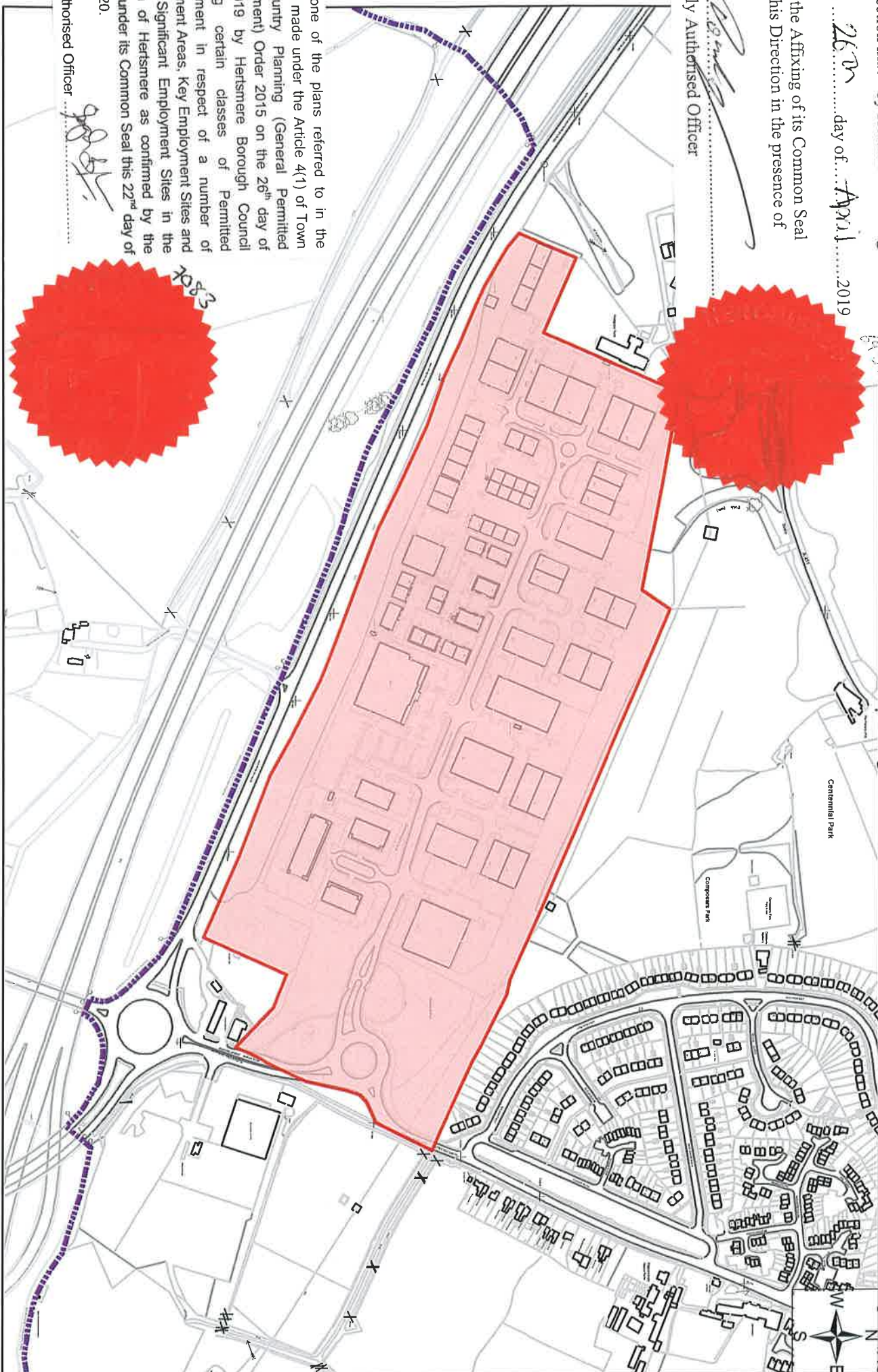

## Legend

Area to which Article 4 direction applies

## Centennial Park

Hertsmere Borough Council Boundary

You are permitted to use this data solely to enable you to respond to, or interact with, the organisation that provided you with the data.



© Crown copyright and database rights 2016 OS EUL 100017428  
You are not permitted to copy, sub-licence, distribute or sell any of this data to third parties in any form.



This is the plan referred to under the Article 4(1) Direction made by Hertsmere Borough Council

this 26<sup>th</sup> day of April 2019

By the Affixing of its Common Seal to this Direction in the presence of

*[Signature]*  
Duly Authorised Officer

This is one of the plans referred to in the Direction made under the Article 4(1) of Town and Country Planning (General Permitted Development) Order 2015 on the 26<sup>th</sup> day of April 2019 by Hertsmere Borough Council excluding certain classes of Permitted Development in respect of a number of Employment Areas, Key Employment Sites and Locally Significant Employment Sites in the Borough of Hertsmere as confirmed by the Council under its Common Seal this 22<sup>nd</sup> day of April 2020.

Duly Authorised Officer

*[Signature]*

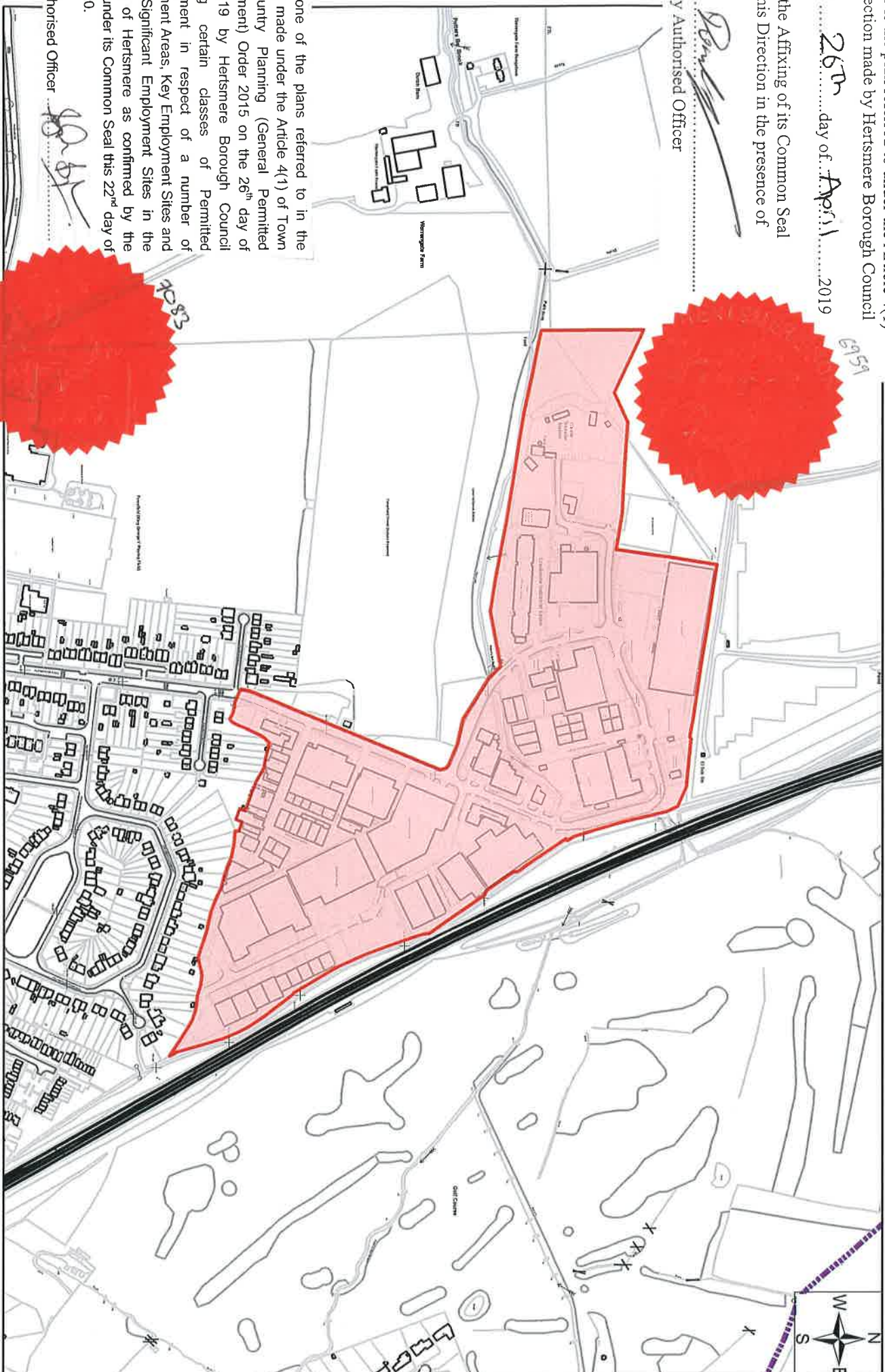

# Legend

Area to which Article 4 direction applies

Hertsmere Borough Council Boundary

# Cranbourne Road

0 0.0325 0.065 0.13 0.195 0.26 1.5,000 Miles



Hertsmere Borough Council Boundary

You are permitted to use this data solely to enable you to respond to, or interact with, the organisation that provided you with the data.

You are not permitted to copy, sub-licence, distribute or sell any of this data to third parties in any form.

© Crown copyright and database rights 2016 OS EUL 100017428



This is the plan referred to under the Article 4(1) Direction made by Hertsmere Borough Council

this ... 26<sup>th</sup> ... day of ... April ... 2019

By the Affixing of its Common Seal to this Direction in the presence of

Duly Authorised Officer



This is one of the plans referred to in the Direction made under the Article 4(1) of Town and Country Planning (General Permitted Development) Order 2015 on the 26<sup>th</sup> day of April 2019 by Hertsmere Borough Council excluding certain classes of Permitted Development in respect of a number of Employment Areas, Key Employment Sites and Locally Significant Employment Sites in the Borough of Hertsmere as confirmed by the Council under its Common Seal this 22<sup>nd</sup> day of April 2020.

Duly Authorised Officer

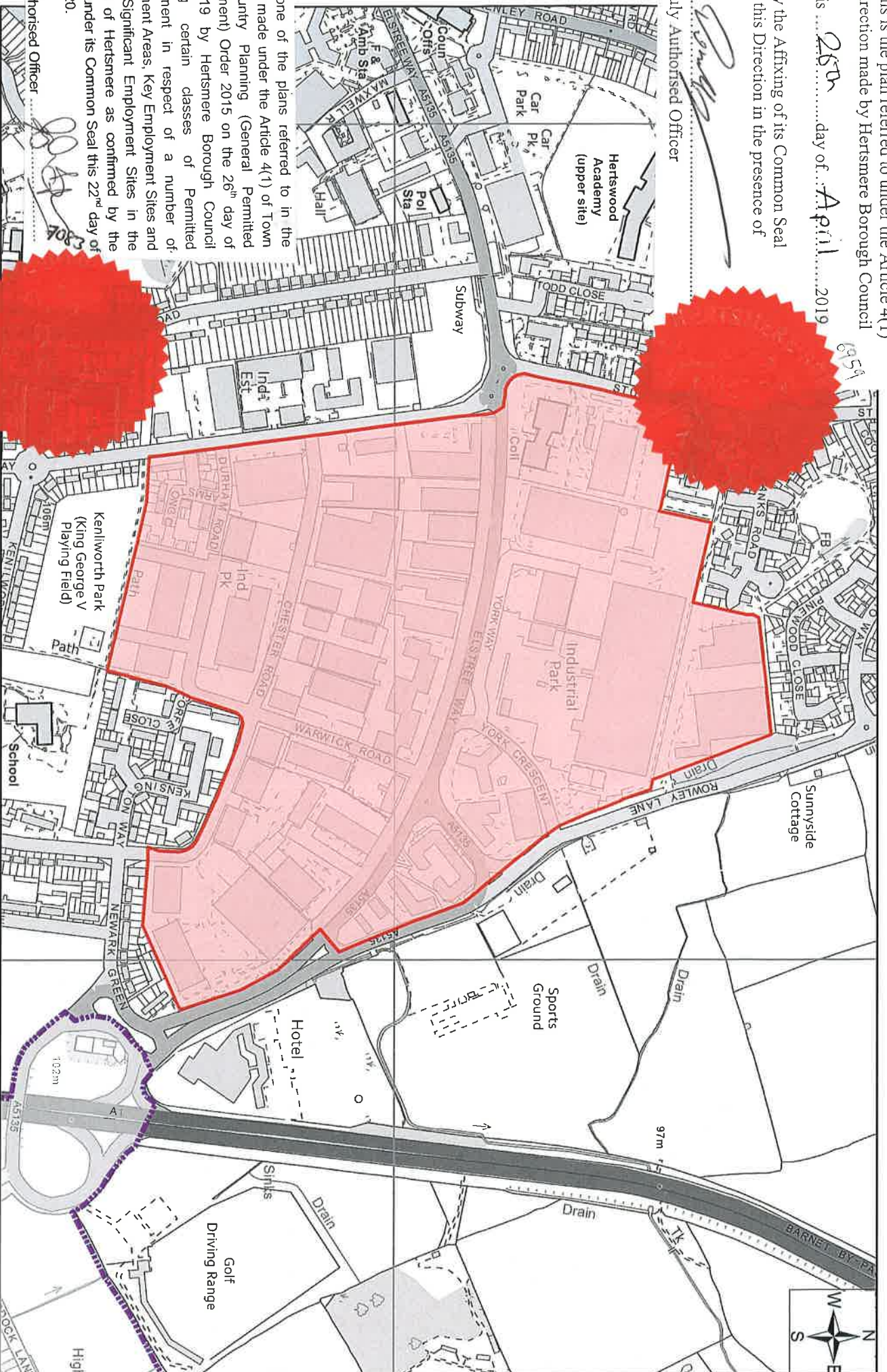

## Legend

Area to which Article 4 direction applies

## Elstree Way

Hertsmere Borough Council Boundary

You are permitted to use this data solely to enable you to respond to, or interact with, the organisation that provided you with the data.

You are not permitted to copy, sub-licence, distribute or sell any of this data to third parties in any form.

© Crown copyright and database rights 2016 OS EUL 100017428





This is the plan referred to under the Article 4(1)  
Direction made by Hertsmere Borough Council

this 26<sup>th</sup> day of April 2019

By the Affixing of its Common Seal  
to this Direction in the presence of

Duly Authorised Officer

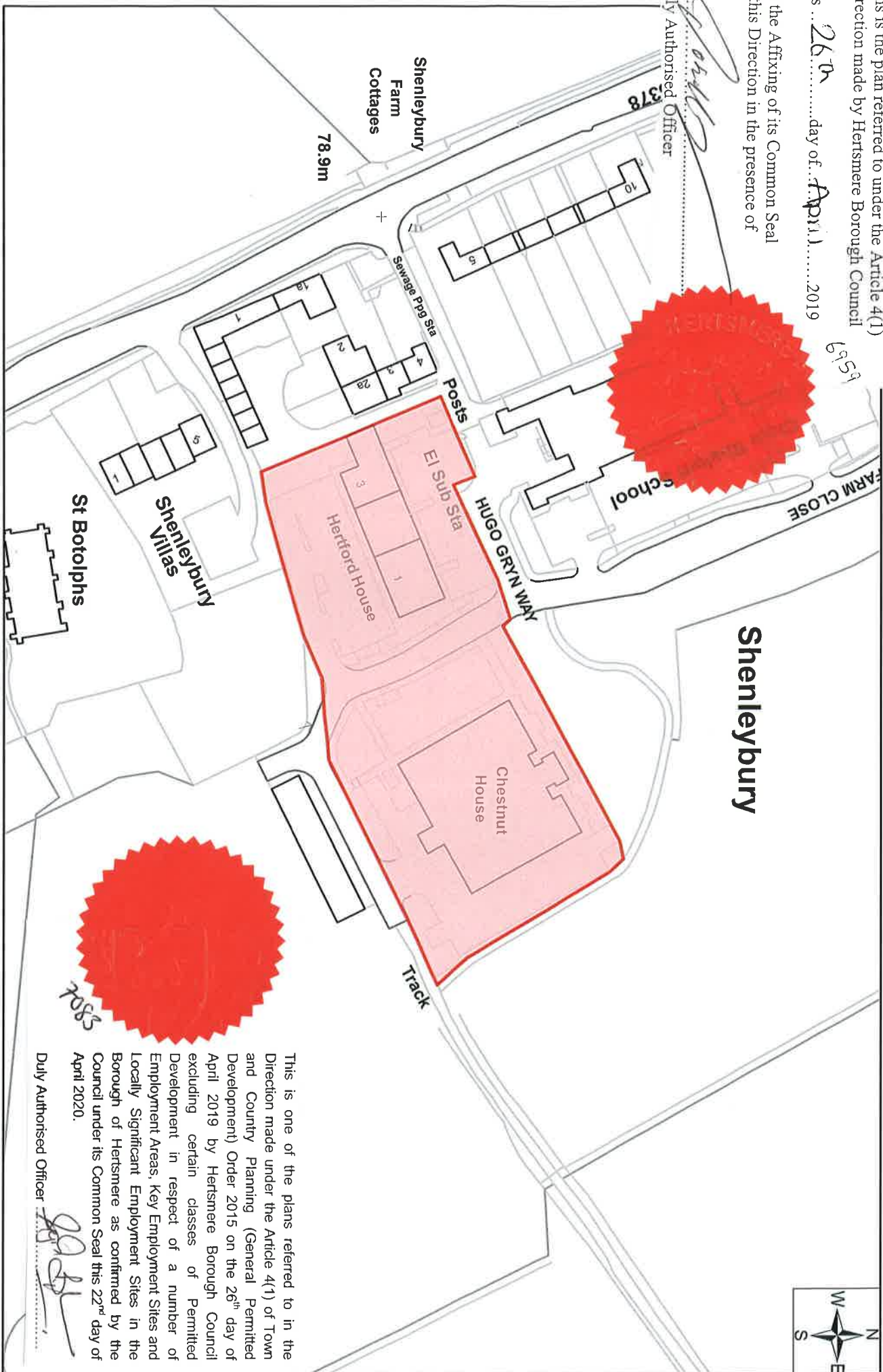

Shenleybury  
Farm  
Cottages

78.9m

10  
5  
3/8

Sewage Pp Sta

Posts

El Sub Sta

Hertford House

HUGO GRYN WAY

Chestnut  
House

Track

Shenleybury  
Villas

St Botolphs

# Legend

Area to which Article 4 direction applies

## Farm Close

0 0.0078.015

0.03

0.045

0.06

1:1,250

Miles

This is one of the plans referred to in the  
Direction made under the Article 4(1) of Town  
and Country Planning (General Permitted  
Development) Order 2015 on the 26<sup>th</sup> day of  
April 2019 by Hertsmere Borough Council  
excluding certain classes of Permitted  
Development in respect of a number of  
Employment Areas, Key Employment Sites and  
Locally Significant Employment Sites in the  
Borough of Hertsmere as confirmed by the  
Council under its Common Seal this 22<sup>nd</sup> day of  
April 2020.

Duly Authorised Officer

*[Signature]*



Hertsmere Borough Council Boundary

You are permitted to use this data solely to enable you to respond to, or interact with, the organisation that provided you with the data.

You are not permitted to copy, sub-licence, distribute or sell any of this data to third parties in any form.

© Crown copyright and database rights 2016 OS EUL 100017428



this 25<sup>th</sup> day of April 2019

By the Affixing of its Common Seal to this Direction in the presence of

Duly Authorised Officer

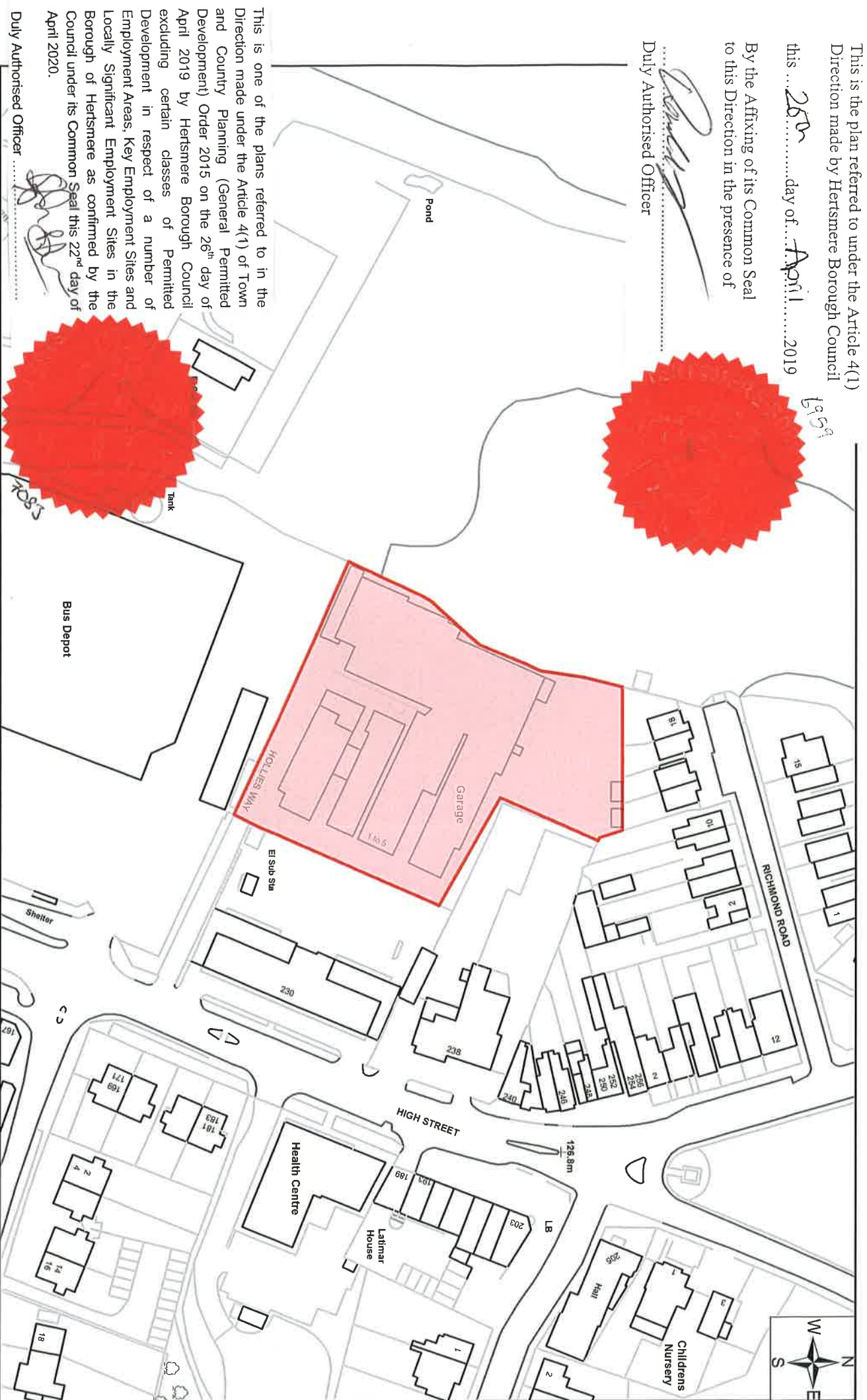

## Legend

## Hollies Way Business Park

0	0.0075	0.03	0.045	0.06	1:1,250
---	--------	------	-------	------	---------



Area to which Article 4 direction applies

You are not permitted to copy, sub-licence, distribute or sell any of this data to third parties in any form. You are permitted to use this data solely to enable you to respond to, or interact with, the organisation that provided you with the data.

You are not permitted to copy, sub-licence, distribute or sell any of this data to third parties in any form, or to use the data solely to enable you to respond to, or interact with, the organisation that provided you with the data.



This is the plan referred to under the Article 4(1)  
Direction made by Hertsmere Borough Council

this ..... 26<sup>th</sup> ..... day of ... April ..... 2019

By the Affixing of its Common Seal  
to this Direction in the presence of

Duly Authorised Officer

This is one of the plans referred to in the  
Direction made under the Article 4(1) of Town  
and Country Planning (General Permitted  
Development) Order 2015 on the 26<sup>th</sup> day of  
April 2019 by Hertsmere Borough Council  
excluding certain classes of Permitted  
Development in respect of a number of  
Employment Areas, Key Employment Sites and  
Locally Significant Employment Sites in the  
Borough of Hertsmere as confirmed by the  
Council under its Common Seal this 22<sup>nd</sup> day of  
April 2020.

Duly Authorised Officer

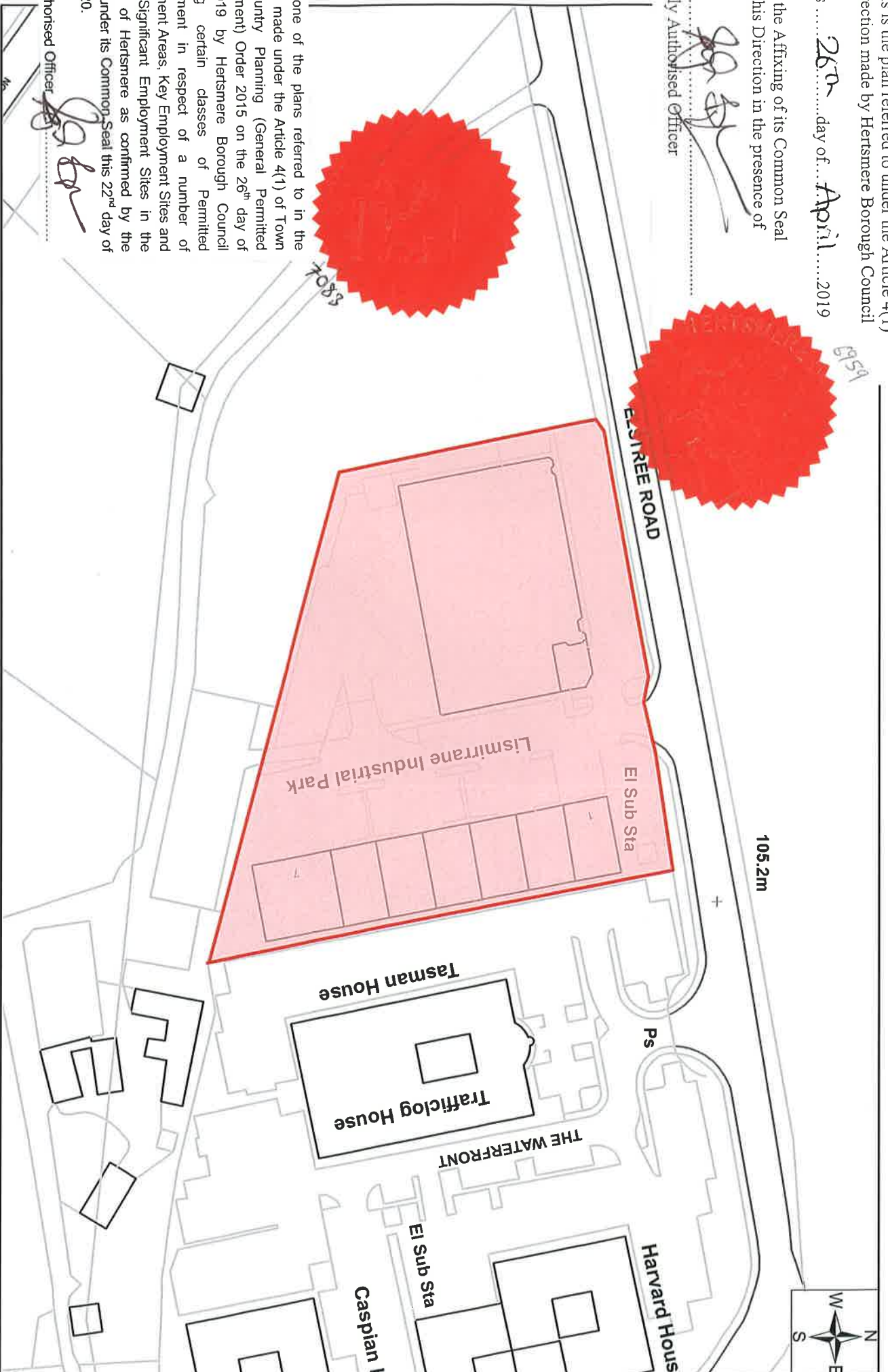

## Legend

## Lismirrane Industrial Park

Area to which Article 4 direction applies  
Hertsmere Borough Council Boundary

You are not permitted to copy, sub-licence, distribute or sell any of this data to third parties in any form.  
You are permitted to use this data solely to enable you to respond to, or interact with, the organisation that provided you with the data.



0 0.0075.015 0.03 0.045 0.06 1:1,250  
Miles

© Crown copyright and database rights 2016 OS EUL 100017428



This is the plan referred to under the Article 4(1)  
Direction made by Hertsmere Borough Council

this 26<sup>th</sup> day of April 2019

By the Affixing of its Common Seal  
to this Direction in the presence of

Duly Authorised Officer



This is one of the plans referred to in the  
Direction made under the Article 4(1) of Town  
and Country Planning (General Permitted  
Development) Order 2015 on the 26<sup>th</sup> day of  
April 2019 by Hertsmere Borough Council  
excluding certain classes of Permitted  
Development in respect of a number of  
Employment Areas, Key Employment Sites and  
Locally Significant Employment Sites in the  
Borough of Hertsmere as confirmed by the  
Council under its Common Seal this 22<sup>nd</sup> day of  
April 2020.

Duly Authorised Officer



## Legend

Area to which Article 4 direction applies

## Otterspool way

Hertsmere Borough Council Boundary

You are permitted to use this data solely to enable you to respond to, or interact with, the organisation that provided you with the data.

© Crown copyright and database rights 2016 OS EUL 100017428





This is the plan referred to under the Article 4(1)  
Direction made by Hertsmere Borough Council

this ... 26<sup>th</sup> ... day of ... April ... 2019

By the Affixing of its Common Seal  
to this Direction in the presence of

Duly Authorised Officer

This is one of the plans referred to in the  
Direction made under the Article 4(1) of Town  
and Country Planning (General Permitted  
Development) Order 2015 on the 26<sup>th</sup> day of  
April 2019 by Hertsmere Borough Council  
excluding certain classes of Permitted  
Development in respect of a number of  
Employment Areas, Key Employment Sites and  
Locally Significant Employment Sites in the  
Borough of Hertsmere as confirmed by the  
Council under its Common Seal this 22<sup>nd</sup> day of  
April 2020.

Duly Authorised Officer

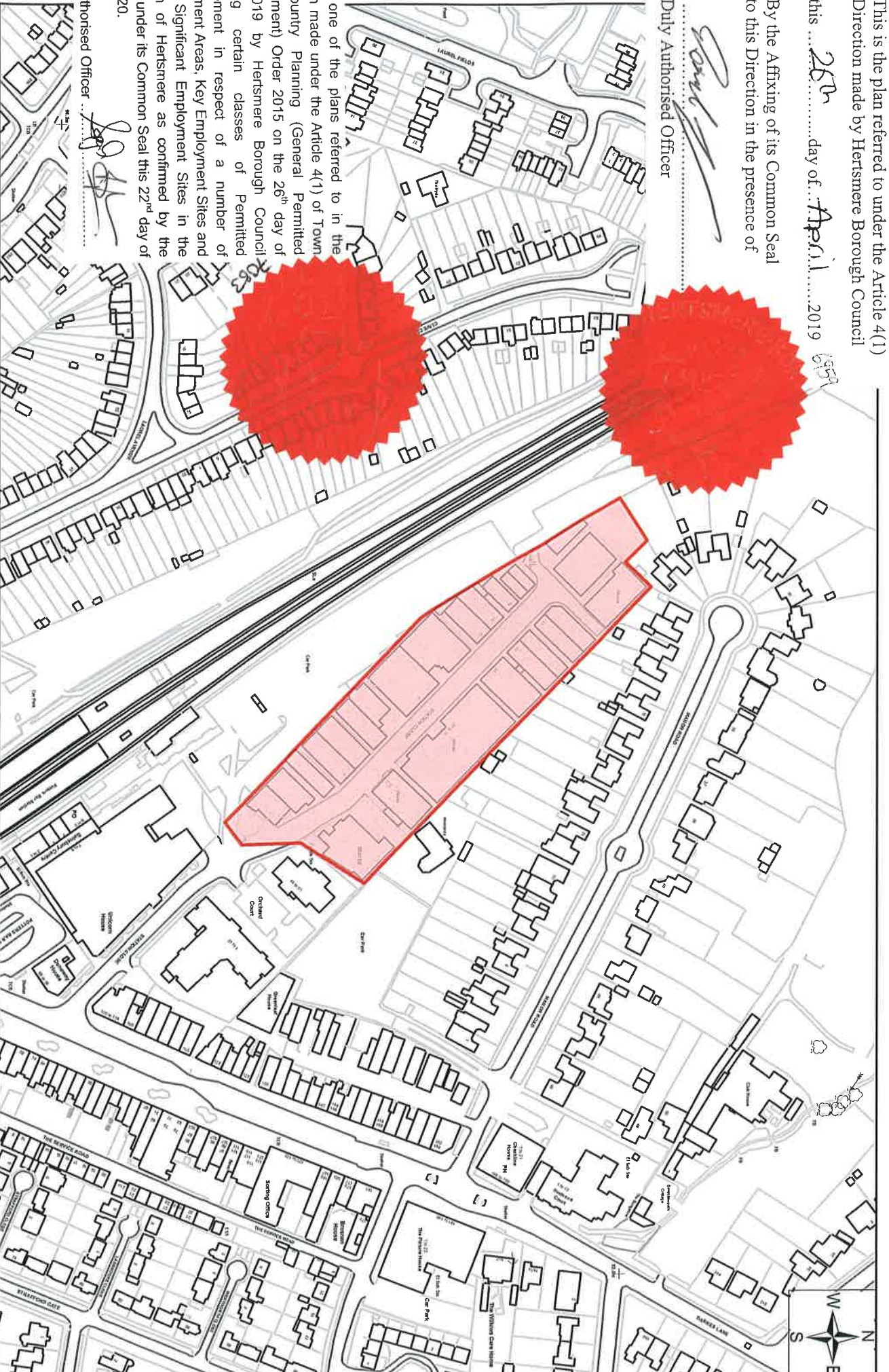

## Legend

## Station Close



Area to which Article 4 direction applies

Hertsmere Borough Council Boundary

You are permitted to use this data solely to enable you to respond to, or interact with, the organisation that provided you with the data.

© Crown copyright and database rights 2016 OS EUL 100017428  
You are not permitted to copy, sub-licence, distribute or sell any of this data to third parties in any form.

