

TOWN AND COUNTRY PLANNING (TREES) REGULATIONS 1999

Plan referred to in THE HERTSMERE TREE PRESERVATION ORDER (87 Hartfield Avenue, Elstree, Herts) No 20/2010

SCHEDULE OF 1

No	Type
T1	Ash

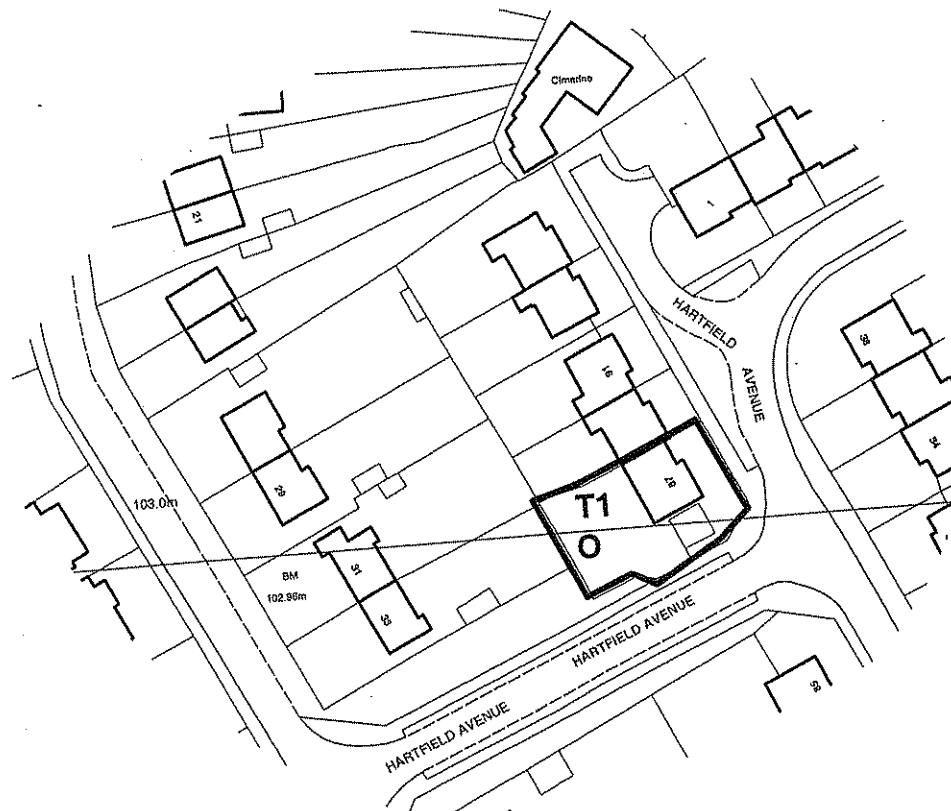

This Order was confirmed by the Hertsmere Borough Council subject to the modifications indicated by the change of address from HARTFIELD ROAD TO HARTFIELD on the SECOND day of JUNE in the year 2010

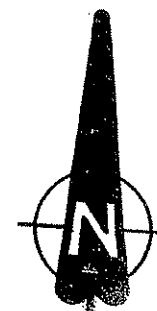

Signed on behalf of Hertsmere Borough Council Third day of March 2010

Authorised by the Council to sign in that behalf:

[Handwritten signature]

Map Ref: TQ 1901,96

Hertsmere Borough
Civic Office
Borehamw
Herts WD6

SCALE: 1:1250