

TOWN AND COUNTRY PLANNING ACTS 1971-1974

Plan referred to in

THE HERTSMERE BOROUGH COUNCIL

(23 and land at rear of 17-23 CHRISTCHURCH
CRESCENT RADLETT)

TREE PRESERVATION ORDER No. 206 /1989

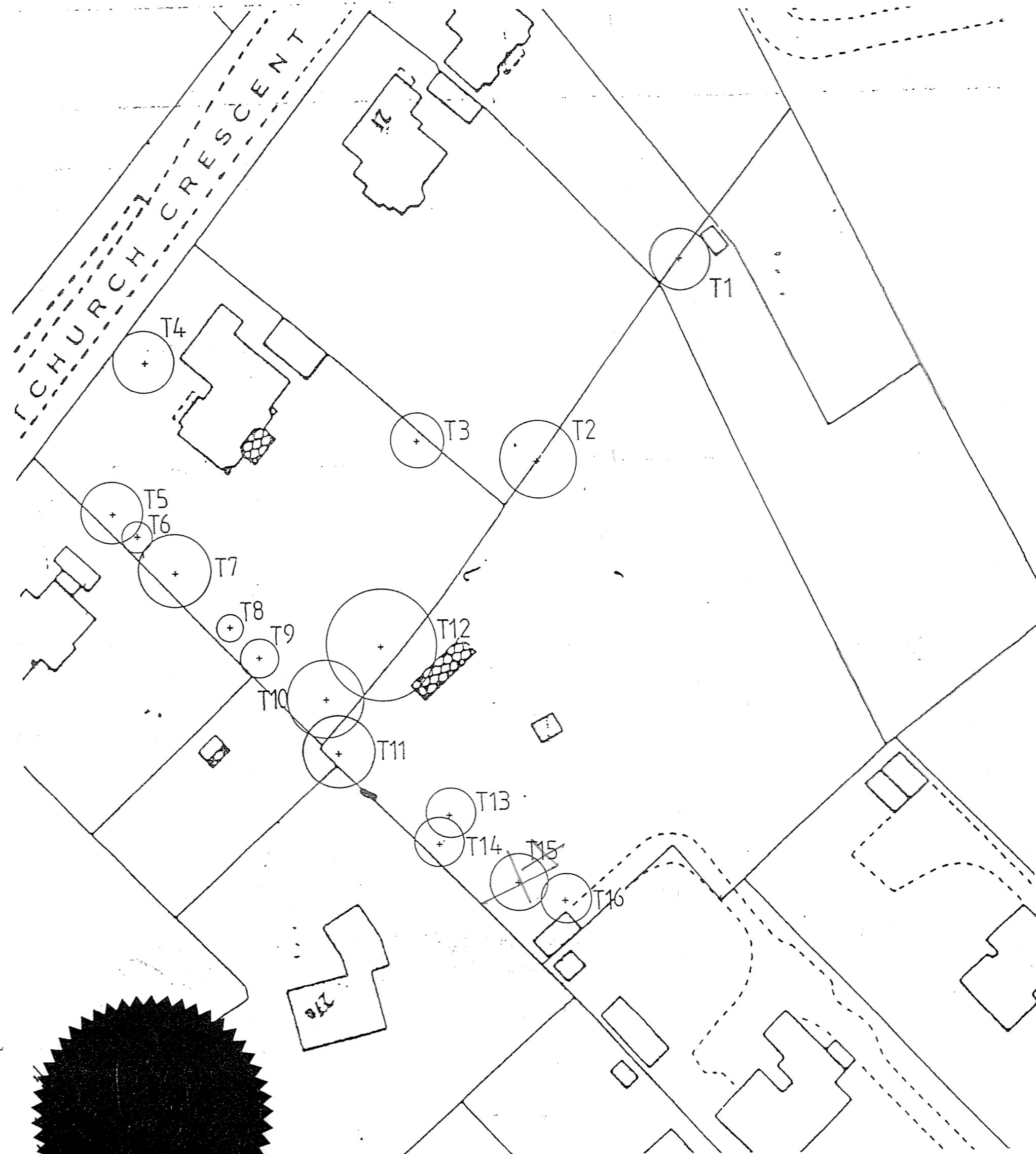
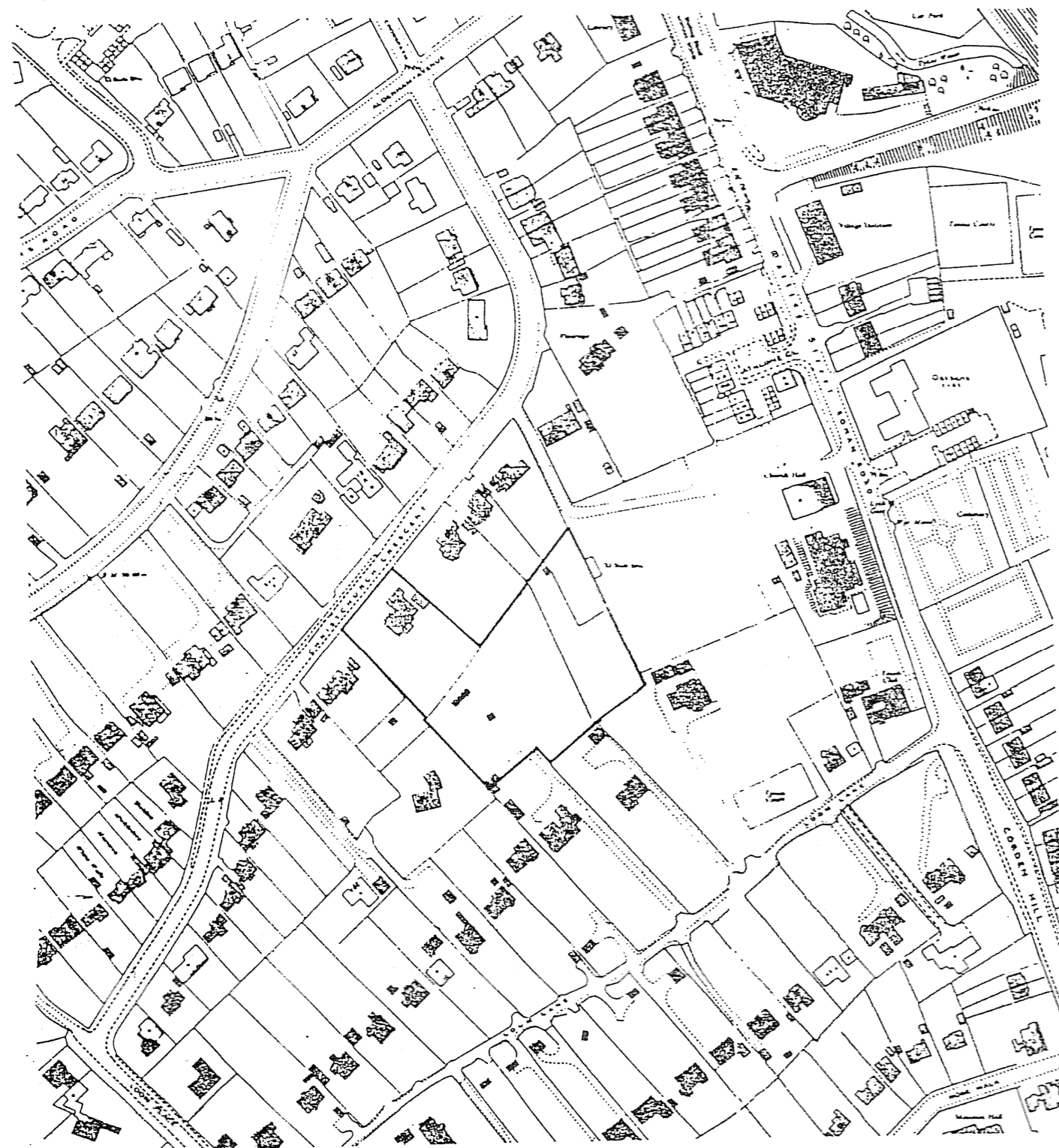

SCHEDULE OF TREES

No.	TYPE
T1	SPRUCE
T2	ASH
T3	HOLM OAK
T4	RED H.CHESTNUT
T5	MAPLE
T6	CYPRESS
T7	MAPLE
T8	SPRUCE
T9	CYPRESS
T10	WALNUT
T11	MAPLE
T12	C. BEECH
T13	WALNUT
T14	BIRCH
T15	WALNUT Removed
T16	YEW

THE COMMON SEAL OF HERTSMERE BOROUGH COUNCIL
WAS HEREUNTO AFFIXED THIS TENTH DAY OF
OCTOBER 1989 IN THE PRESENCE OF:

M. J. Schum MAYOR

P. Thew SOLICITOR

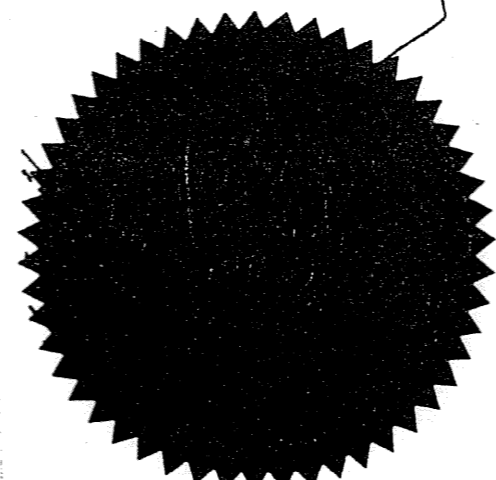

HERTSMERE
BOROUGH COUNCIL
Civic Offices
Elstree Way
Borehamwood
Herts WD6 1WA

SCALE	1:500	DATE	9/10/89
DRAWN	S.D.M.	CHECKED	B.R.A.
DRAWING No.	TP 522		

Reproduced from the Ordnance Survey map with the permission of the
Controller of Her Majesty's Stationery Office. Crown Copyright
reserved.