

# TOWN AND COUNTRY PLANNING ACT 1990

Plan referred to in  
THE HERTSMERE BOROUGH COUNCIL  
( 22 Watford Road, Radlett)  
TREE PRESERVATION ORDER No.289../1994..

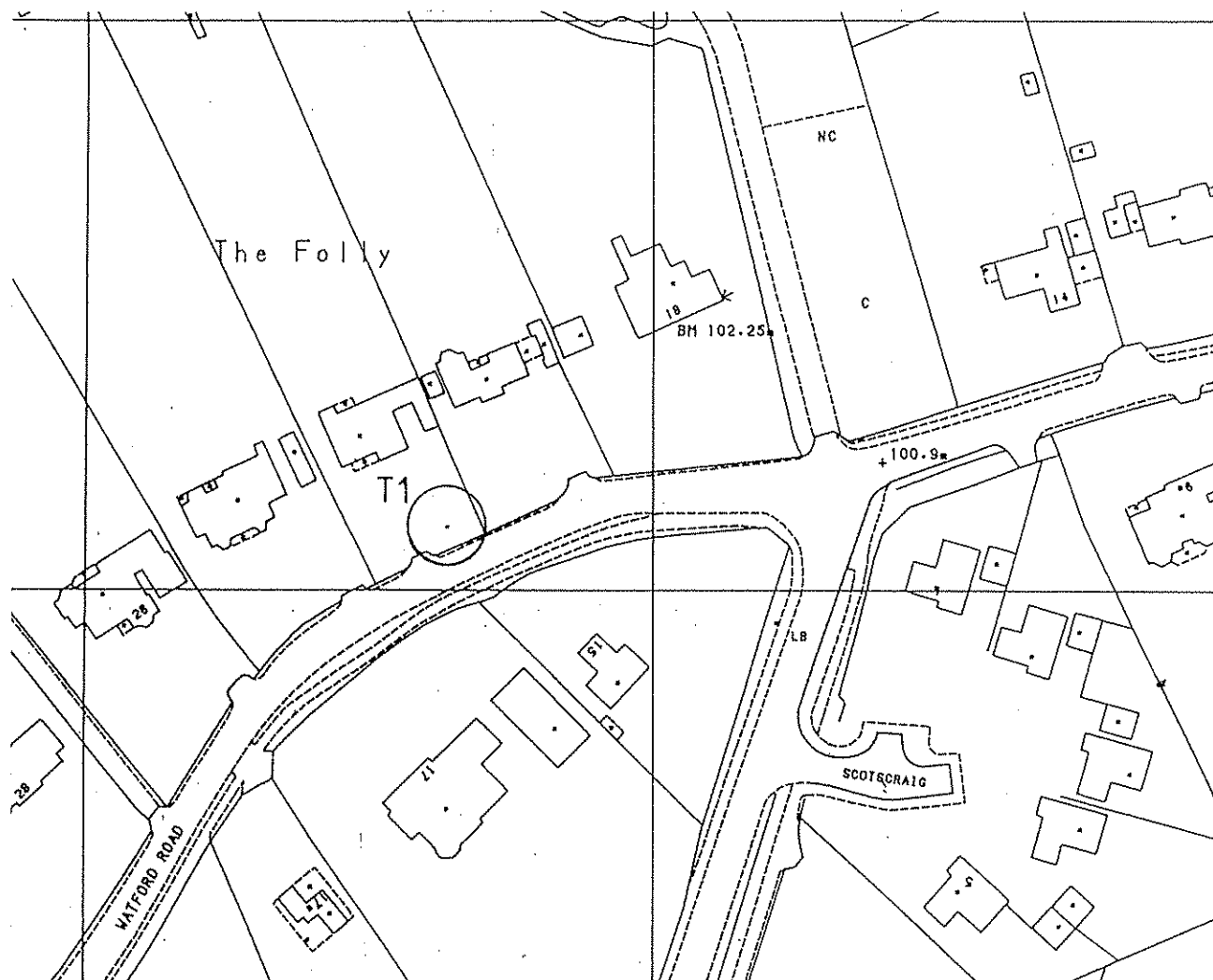

## SCHEDULE OF TREES

No	TYPE
T1	Beech

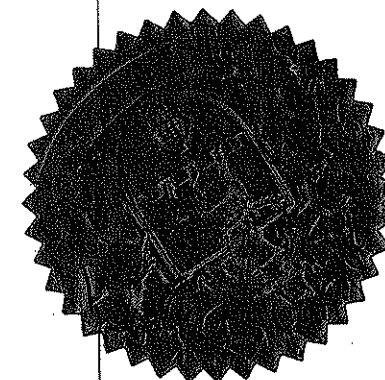

Map Ref. TQ 1599 NE

HERTSMERE  
BOROUGH COUNCIL  
Civic Offices  
Borehamwood  
Herts WD6 1WA

THE COMMON SEAL OF HERTSMERE BOROUGH COUNCIL  
WAS HEREUNTO AFFIXED THIS..FOURTH..DAY OF  
NOVEMBER....1994... IN THE PRESENCE OF :

*M. G. A. Hand*

MANAGING DIRECTOR

(Signed)

Reproduced from the Ordnance Survey map with the permission of the  
Controller of Her Majesty's Stationery Office.  
Crown Copyright reserved.

SCALE 1:1250 DATE 2/11/94

DRAWN S.D.M CHECKED

DRAWING No

TP 609