

TOWN AND COUNTRY PLANNING ACT 1990

Plan referred to in
THE HERTSMERE BOROUGH COUNCIL
(14 Risingholme Close, Bushey, Herts.)
TREE PRESERVATION ORDER No. 336 / 1996..

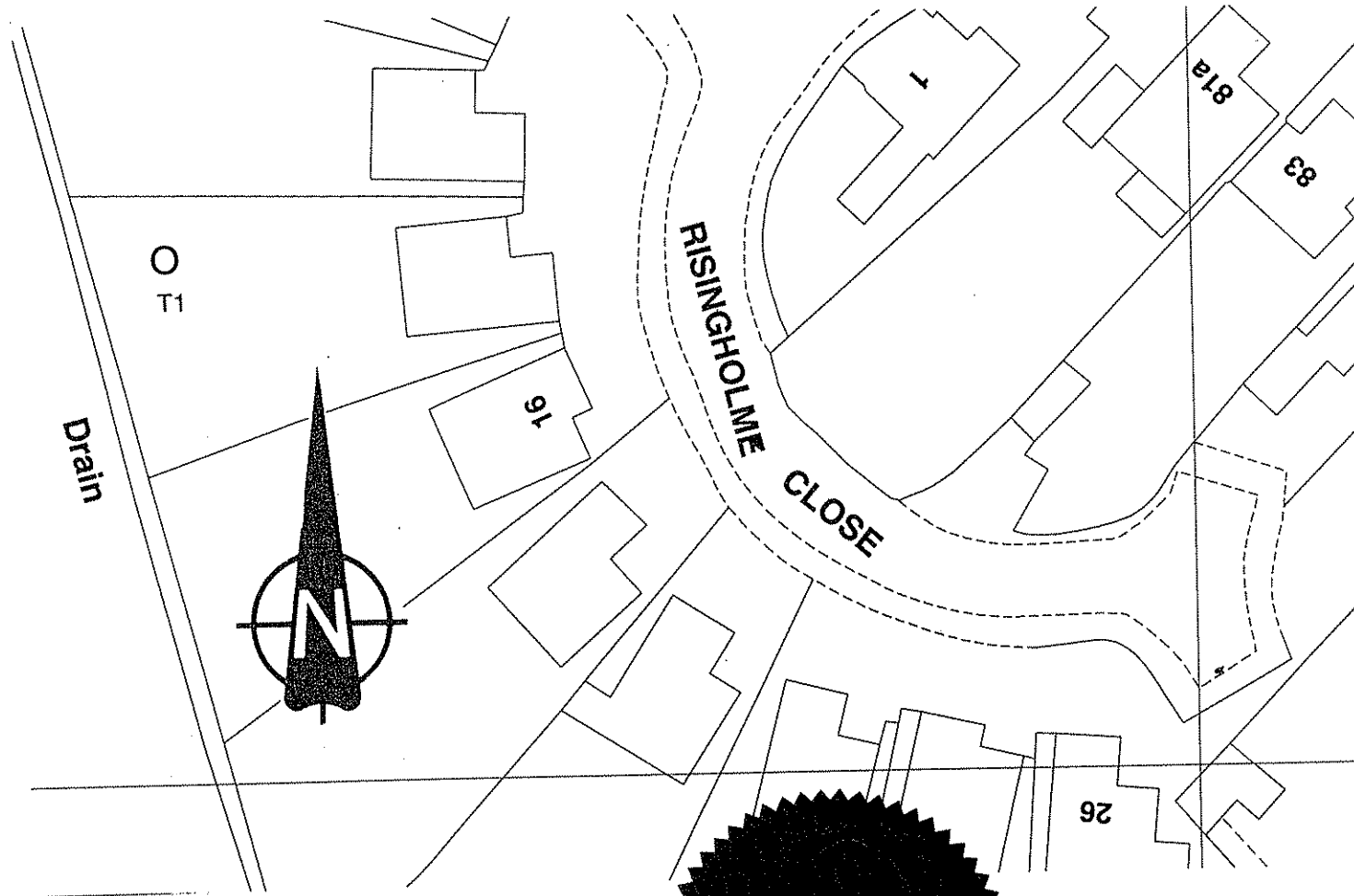

THE COMMON SEAL OF HERTSMERE BOROUGH COUNCIL
WAS HEREUNTO AFFIXED THIS.. TWENTY-SIXTH ..DAY OF
. APRIL ...1996... IN THE PRESENCE OF :

(Signed)

[Signature]
MANAGING DIRECTOR

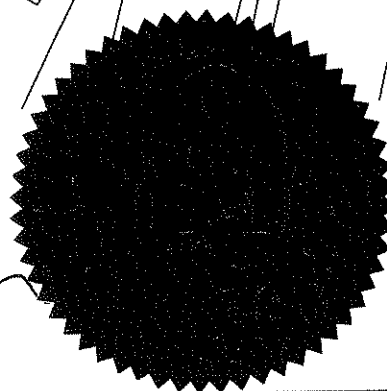

SCHEDULE OF TREES

No	TYPE
T1	Oak

Map Ref. TQ 136-948

HERTSMERE
BOROUGH COUNCIL
Civic Offices
Borehamwood
Herts. WD6 1WA

SCALE 1: 500	DATE 16/4/96
DRAWN P.J.B	CHECKED
DRAWING No	TP 655

Reproduced from the Ordnance Survey map with the permission of the
Controller of Her Majesty's Stationary Office.
Crown Copyright reserved.