

TOWN AND COUNTRY PLANNING ACT 1990

Plan referred to in
THE HERTSMERE BOROUGH COUNCIL
(Pathways, The Pathway, Radlett, Hertfordshire.)
TREE PRESERVATION ORDER No. 346/1996..

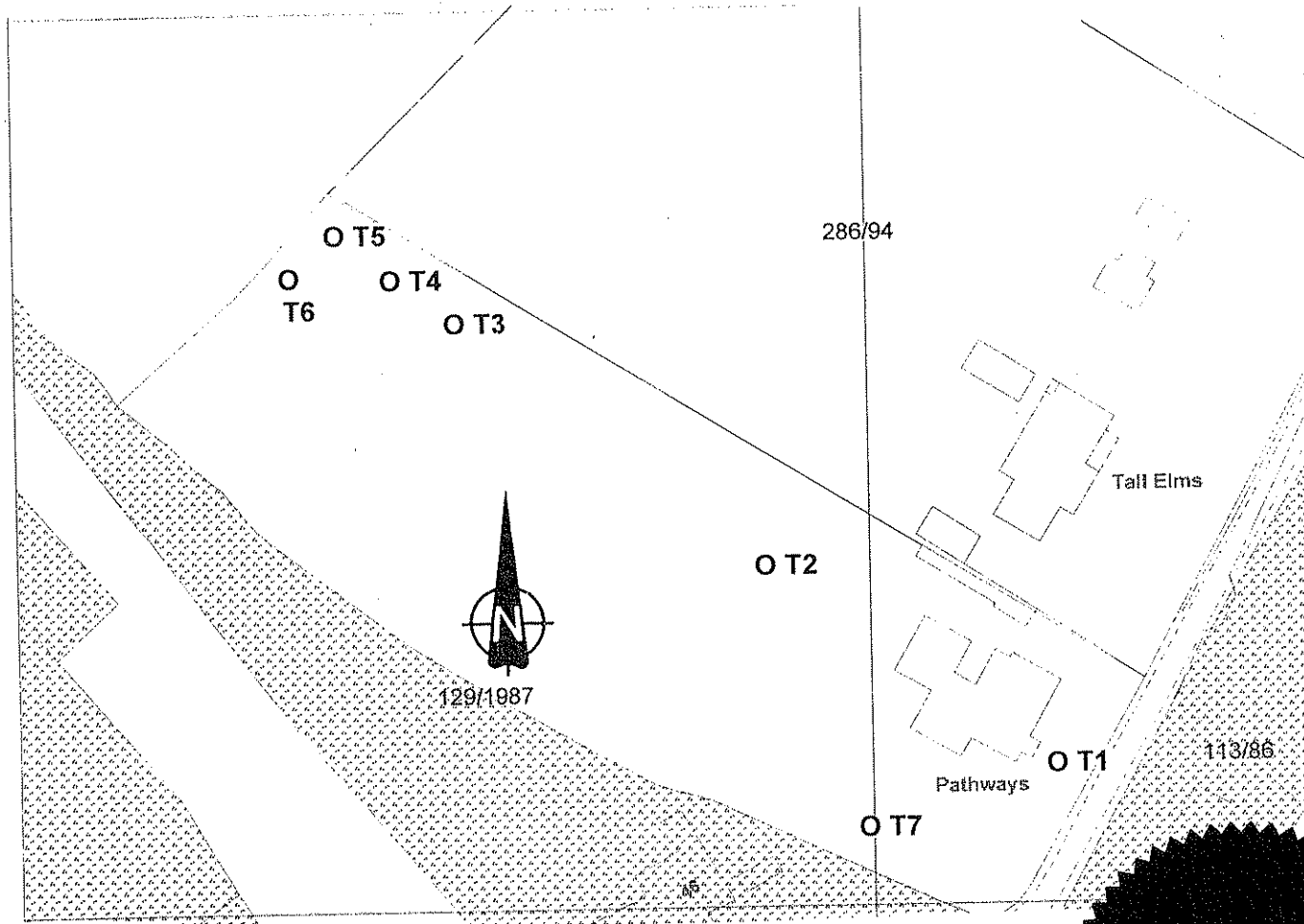

SCHEDULE

No	
T1	Larch
T2	Pine
T3	Waln
T4	Larch
T5	Abies
T6	Eucal
T7	Cypre

Map Ref. TQ

HERTSMERE
BOROUGH COUNCIL
Civil Engineer
Boreham
Herts.

THE COMMON SEAL OF HERTSMERE BOROUGH COUNCIL
WAS HEREUNTO AFFIXED THIS..Twenty Sixth..DAY OF
November ...1996... IN THE PRESENCE OF :