

# TOWN AND COUNTRY PLANNING ACT 1990

Plan referred to in  
THE HERTSMERE BOROUGH COUNCIL  
TREE PRESERVATION ORDER No. 389 / 1997  
37 COLDHARBOUR LANE, BUSHEY, HERTS.

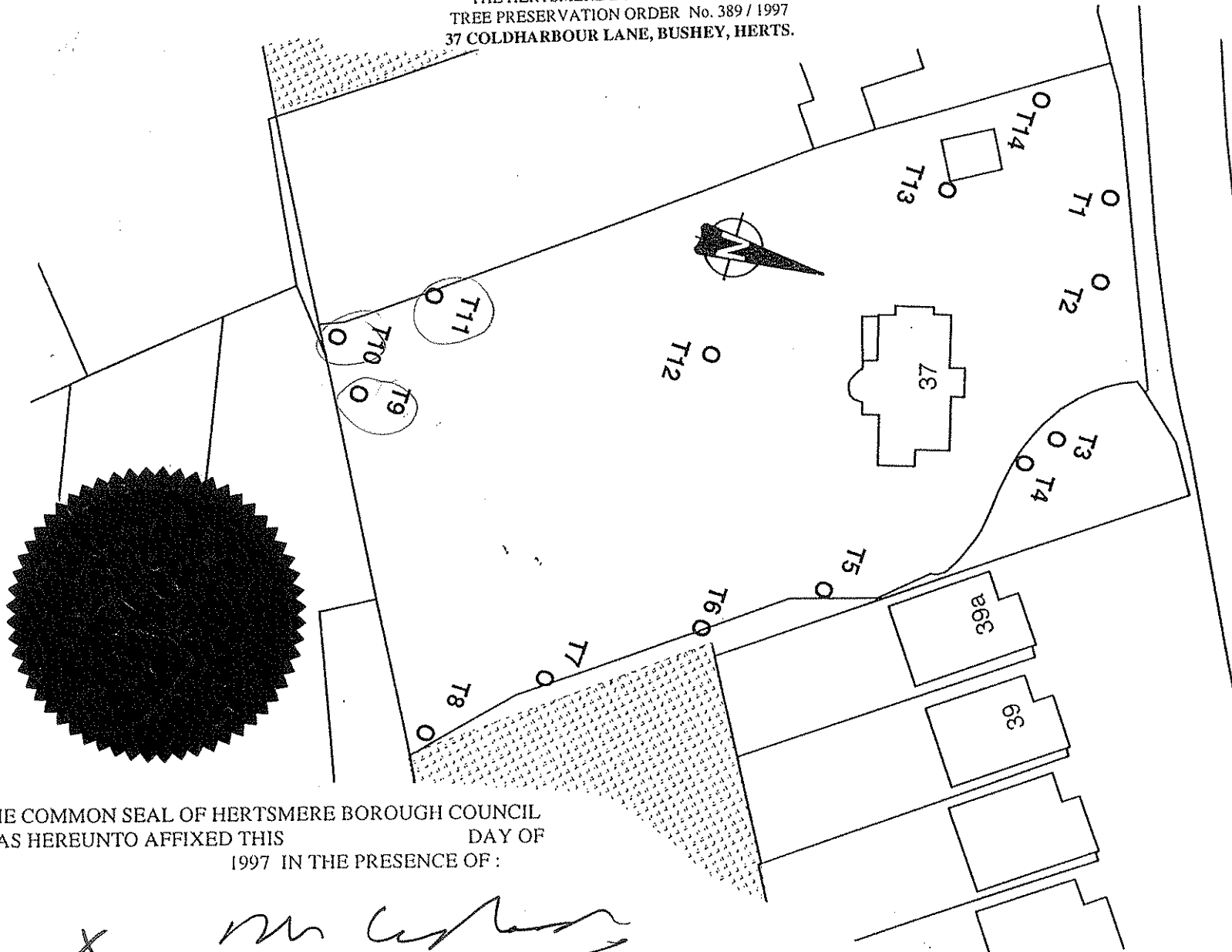

THE COMMON SEAL OF HERTSMERE BOROUGH COUNCIL  
WAS HEREUNTO AFFIXED THIS DAY OF  
1997 IN THE PRESENCE OF :

## SCHEDULE

No	
T1	Lime
T2	Ash
T3	Maple
T4	Maple
T5	Maple
T6	Maple
T7	Yew
T8	2 x Ma comm
T9	Horse
T10	Ash
T11	Oak
T12	Cypres
T13	Sycam
T14	2 x Asl crown

Map Ref. TQ14

HERTS  
BOROUGH  
Civic  
Borcha  
Herts. W

SCALE 1:500