

TOWN AND COUNTRY PLANNING ACT 1990

Plan referred to in
THE HERTSMERE BOROUGH COUNCIL
TREE PRESERVATION ORDER No. 413 / 1998
14 The Ridgeway, Radlett, Herts.

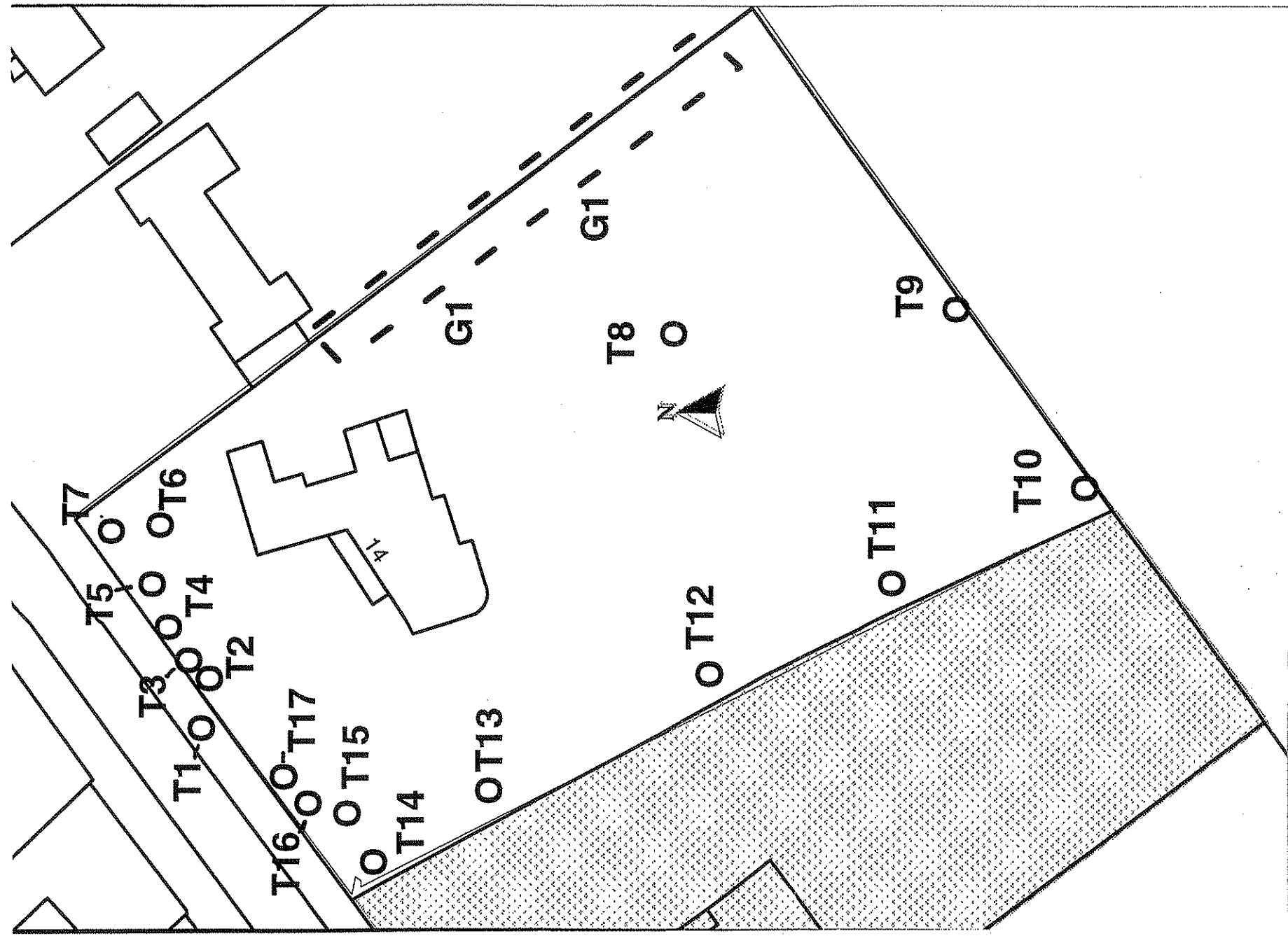

THE COMMON SEAL OF HERTSMERE BOROUGH COUNCIL
WAS HEREUNTO AFFIXED THIS THIRTIETH DAY OF JULY
1998 IN THE PRESENCE OF :

(Signed) B CONNOR

SENIOR SOLICITOR

SCHEDULE OF TREES

No	TYPE
T1	Horse Chestnut
T2	Beech
T3	Beech
T4	Beech
T5	Acer
T6	Acer
T7	Beech
T8	Oak
T9	Silver Birch
T10	Silver Birch
T11	Oak
T12	Oak
T13	Rowan
T14	Ash
T15	Ash
T16	Beech
T17	Beech

G1 Consists of 1 Horse Chestnut, 10 Hawthorn, 2 Sycamore, 4 Beech

Conn

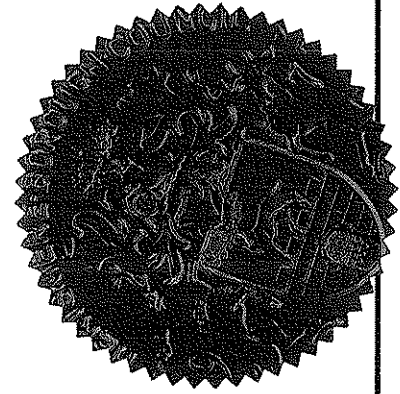

Map Ref. TQ 160 986 7

HERTSMERE
BOROUGH COUNCIL
Civic Offices
Borehamwood
Herts. WD6 1WA

SCALE 1: 500 DATE 20.7.98

DRAWN P.J.B CHECKED

DRAWING No

TP 732

Reproduced from the Ordnance Survey map with the permission of the
Controller of Her Majesty's Stationery Office.
Crown Copyright reserved.
Licence Number LA078239 Hertsmere