

# TOWN AND COUNTRY PLANNING ACT 1990

Plan referred to in  
THE HERTSMERE BOROUGH COUNCIL  
TREE PRESERVATION ORDER No 422. / 1998  
19 Berkley Close, Elstree, Herts.

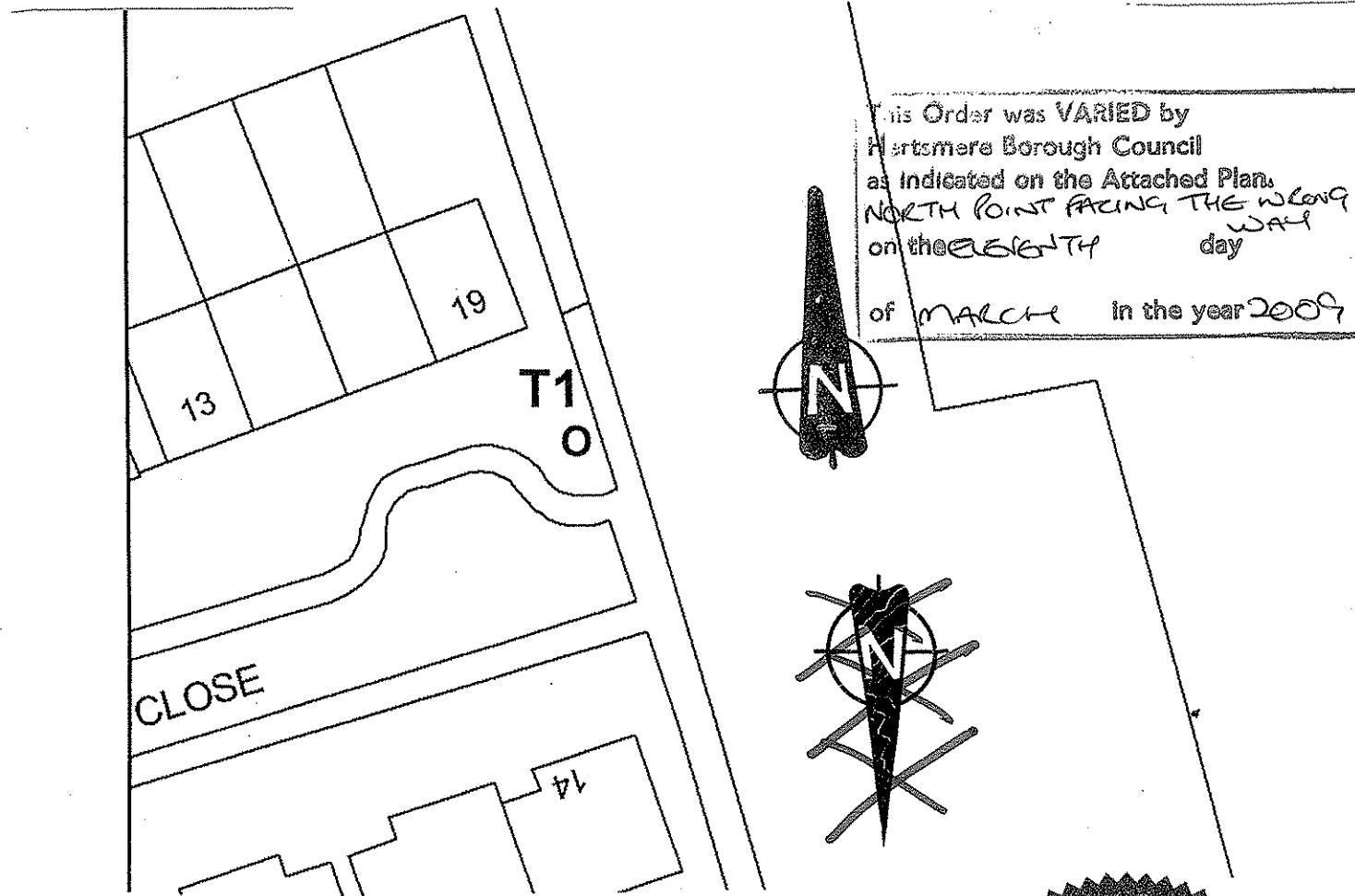

THE COMMON SEAL OF HERTSMERE BOROUGH COUNCIL  
WAS HEREUNTO AFFIXED THIS *fourteenth* DAY OF  
*October* 1998 IN THE PRESENCE OF :

(Signed) P.H. COPLAND

*[Signature]*  
CHIEF EXECUTIVE

## SCHEDULE OF TREES

No	TYPE
T1	Silver Birch

Map Ref. TQ 1922 9582

HERTSMERE  
BOROUGH COUNCIL  
Civic Offices  
Borehamwood  
Herts. WD6 1WA

SCALE 1:500	DATE 26/8/98
DRAWN FM	CHECKED

DRAWING No TP 741

The Ordnance Survey map with the permission of the  
Controller of Her Majesty's Stationery Office.  
Crown Copyright reserved.  
Licence Number LA072239 Hertsmere