

TOWN AND COUNTRY PLANNING ACT 1990

Plan referred to in
THE HERTSMERE BOROUGH COUNCIL
TREE PRESERVATION ORDER No 743 / 1998
34 Lemsford Court, Borehamwood, Herts.

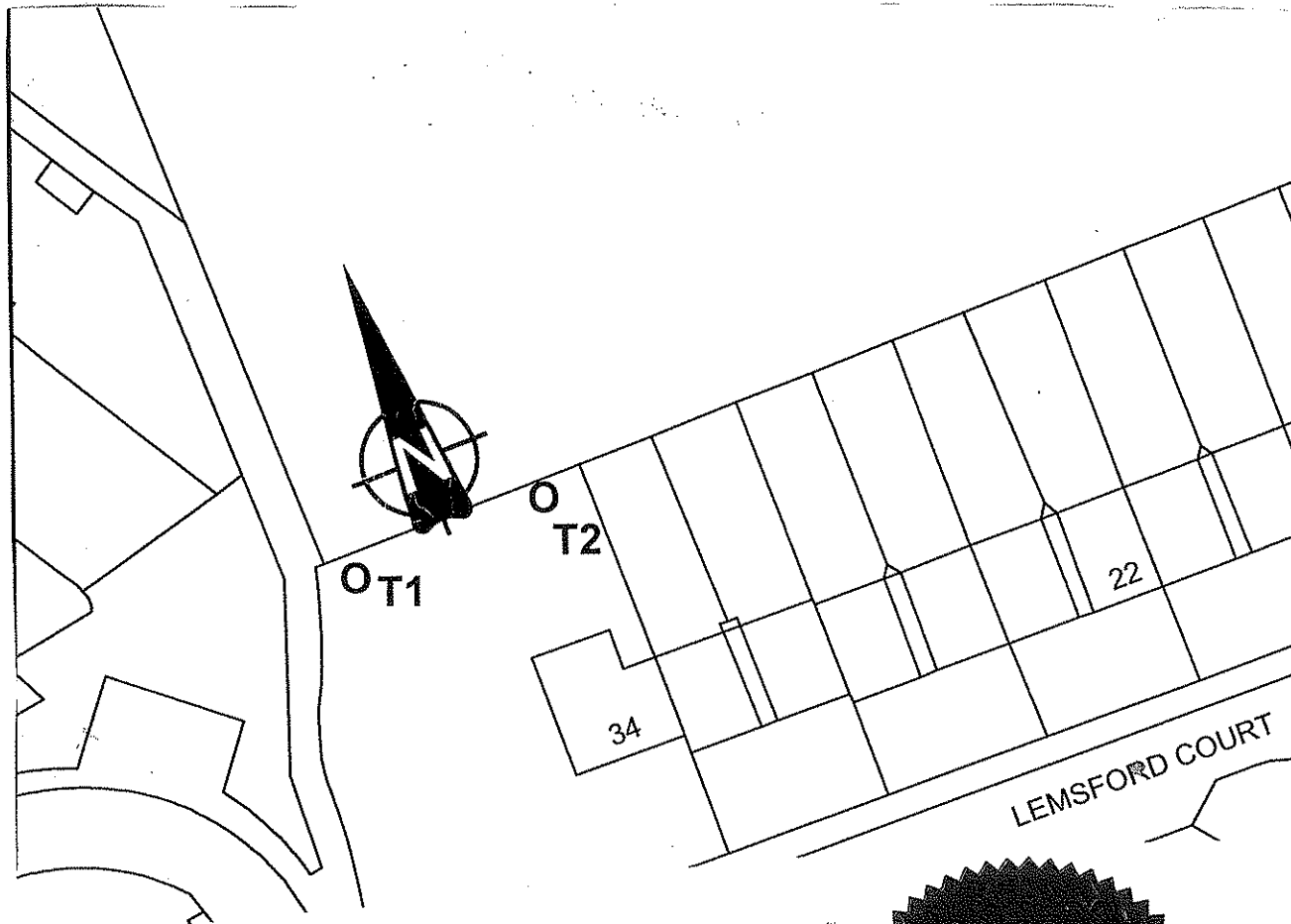

THE COMMON SEAL OF HERTSMERE BOROUGH COUNCIL
WAS HEREUNTO AFFIXED THIS *Fourteenth* DAY OF
October 1998 IN THE PRESENCE OF :

(Signed) P.H. COPLAND

CHIEF EXECUTIVE

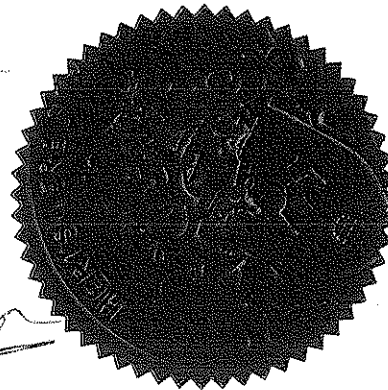

Reproduced from the Ordnance Survey map with the permission of the
Controller of Her Majesty's Stationery Office.
Crown Copyright reserved.
Licence Number LA074239 Hertsmere

SCHEDULE OF TREES

No	TYPE
T1	Oak
T2	Oak

Map Ref. TQ 9628 2009

HERTSMERE
BOROUGH COUNCIL
Civic Offices
Borehamwood
Herts. WD6 1WA

SCALE 1:500 DATE 2/10/98

DRAWN FM CHECKED

DRAWING No

TP 743