

TOWN AND COUNTRY PLANNING (TREES) REGULATIONS 1999

Plan referred to in
THE HERTSMERE (Rear of 69 Mimms Hall Road, Potters Bar, Herts)
TREE PRESERVATION ORDER No 1004 / 2000

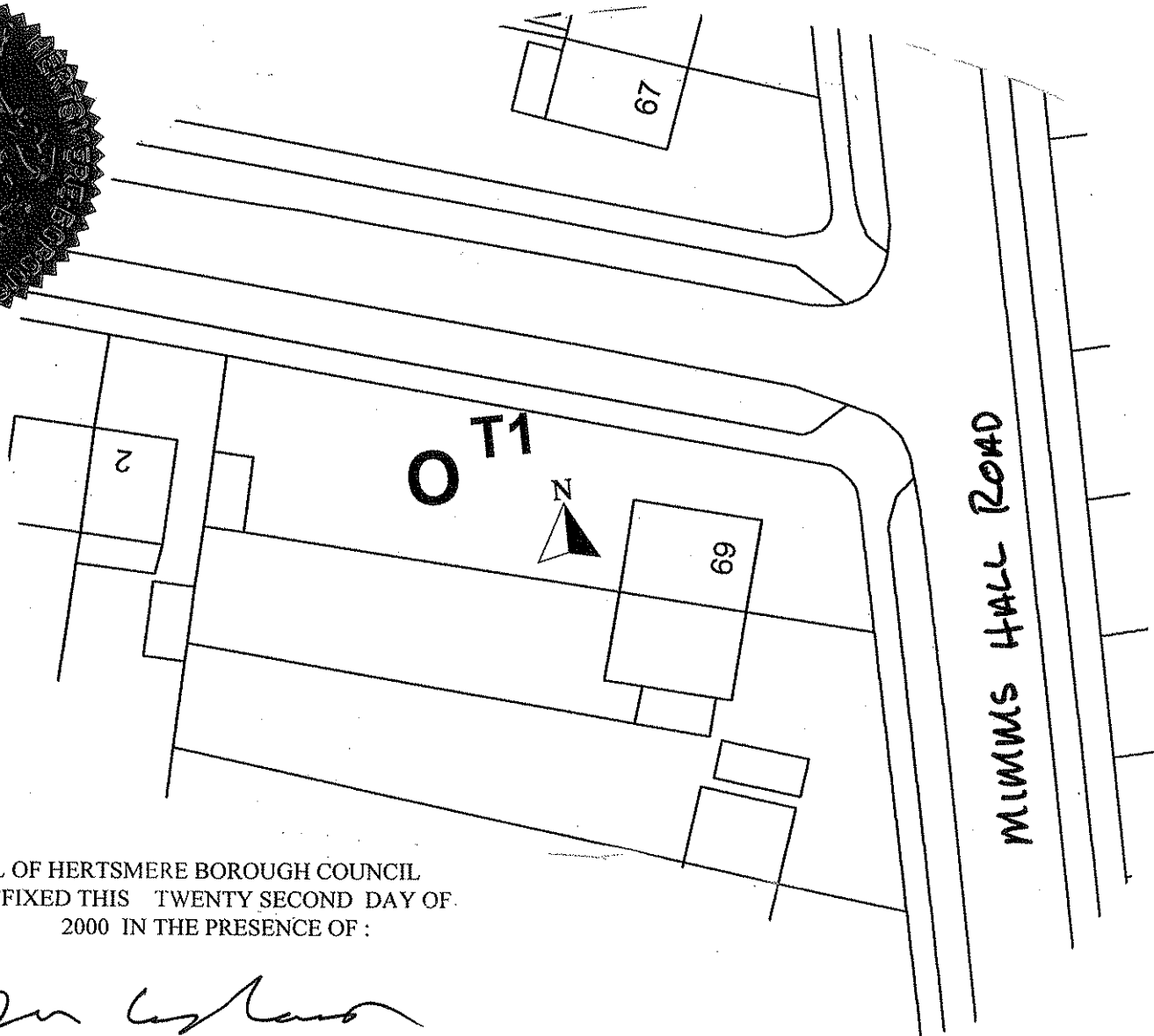
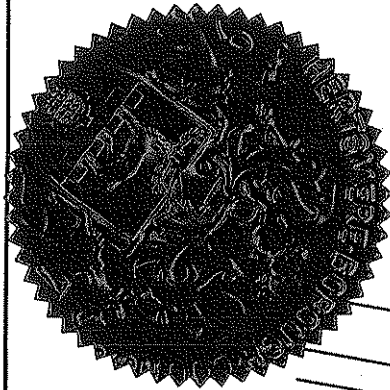

THE COMMON SEAL OF HERTSMERE BOROUGH COUNCIL
WAS HEREUNTO AFFIXED THIS TWENTY SECOND DAY OF
MAY 2000 IN THE PRESENCE OF :

Rev. C. J. Lamb

SCH 1

No

T1

D2

Map Ref. T

HE
BOROU
Civ
Bor