

# TOWN AND COUNTRY PLANNING (TREES) REGULATIONS 1999

Plan referred to in  
THE HERTSMERE (1 Billy Lows Lane, Potters Bar, Herts.)  
TREE PRESERVATION ORDER No 1065 / 2002

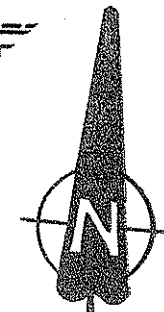
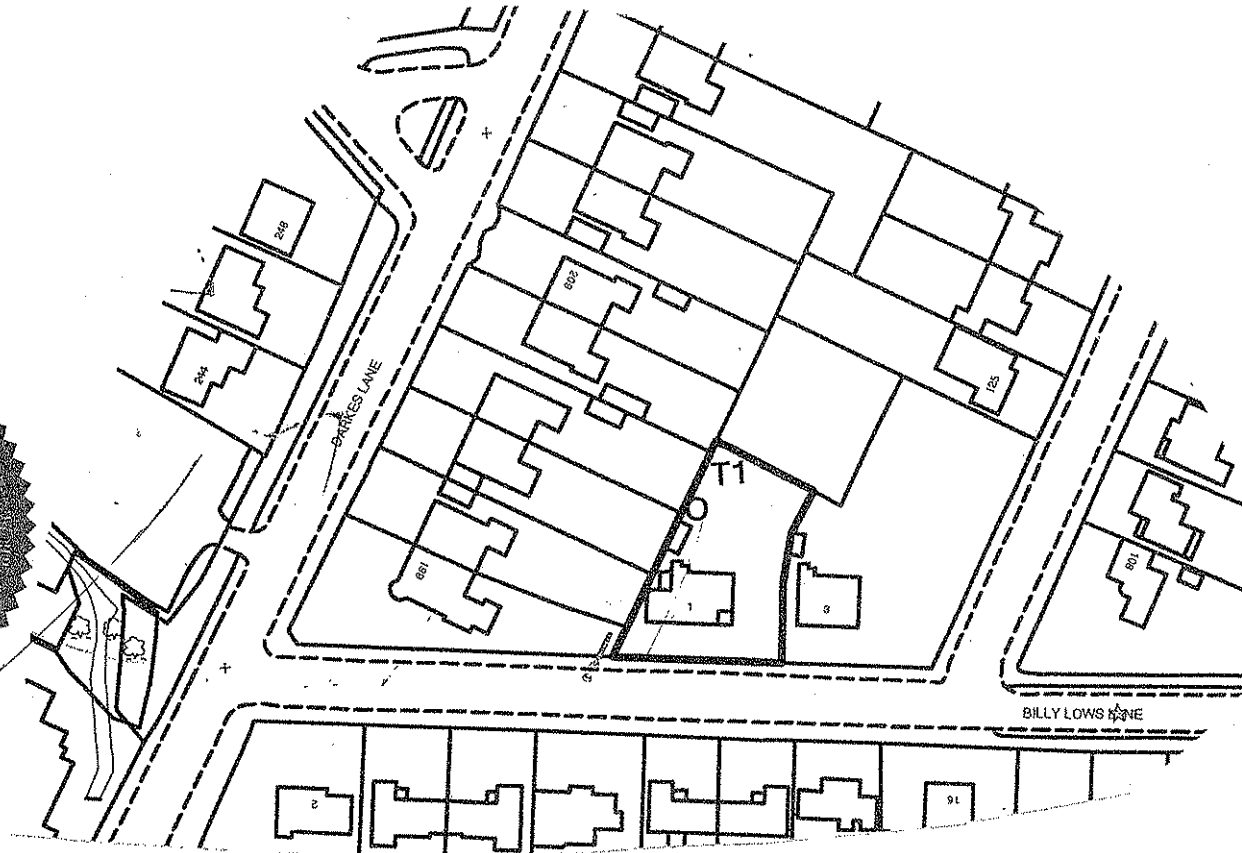

THE COMMON SEAL OF HERTSMERE BOROUGH COUNCIL  
WAS HEREUNTO AFFIXED THIS FIFTEENTH DAY OF  
MAY 2002 IN THE PRESENCE OF :

*Boyd Fisher*

SCHEDULE

No

T1

HORT

Map Ref. TL 0

HERT  
BOROUGH  
Civic  
Borough  
Herts. V