

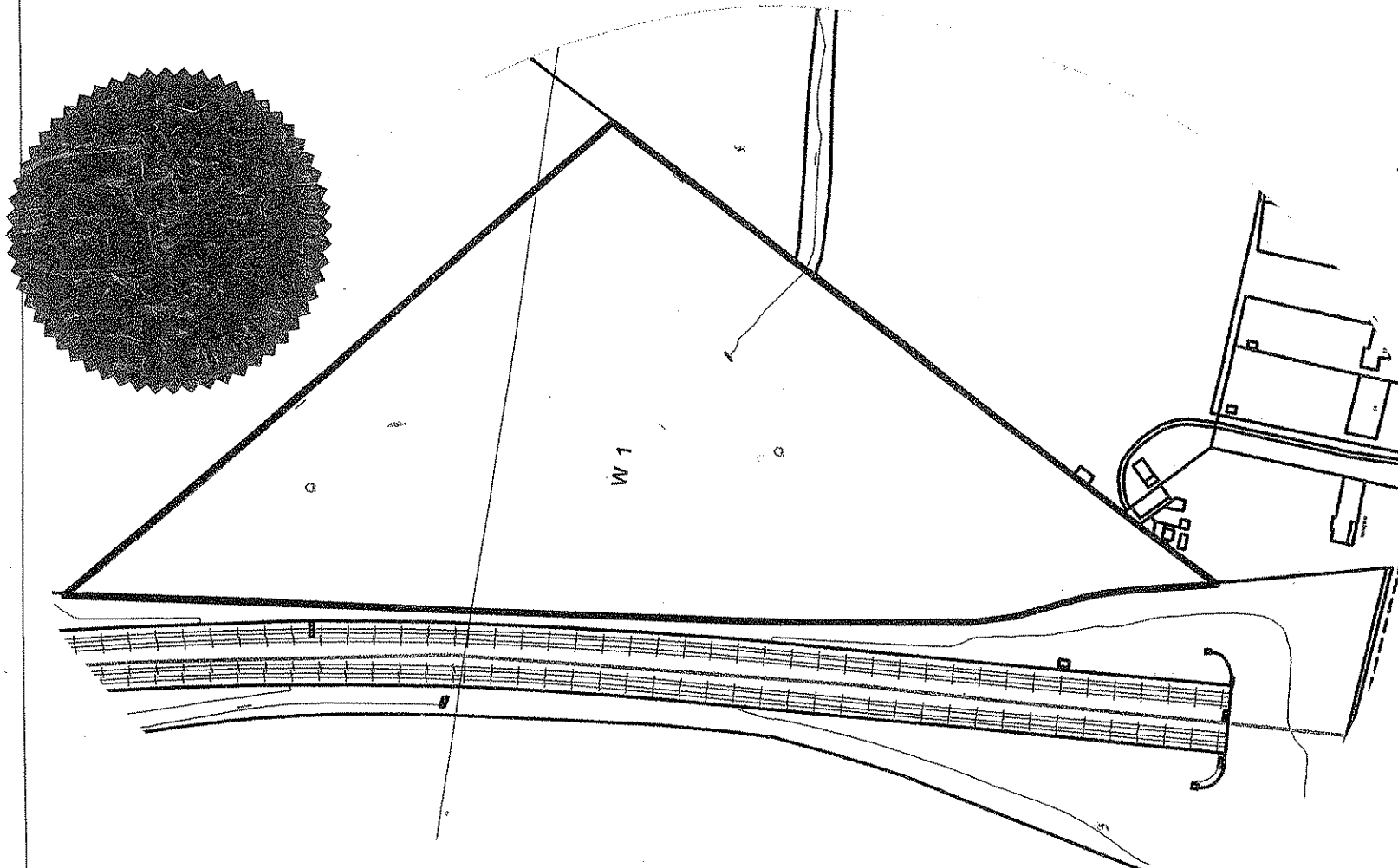

TOWN AND COUNTRY PLANNING (TREES) REGULATIONS 1999

Plan referred to in THE HERTSMERE TREE PRESERVATION ORDER (Spoilbank Wood, Wagon Road, Hadley Wood, Barnet, Herts) No 6/2004



THE COMMON SEAL OF HERTSMERE BOROUGH COUNCIL
WAS HEREUNTO AFFIXED THIS Eleventh day of February 2004

IN THE PRESENCE OF:

(Signed) BERYL FOSTER - HEAD OF LEGAL SERVICES

Reproduced from the Ordnance Survey mapping with the permission of the Controller of Her Majesty's Stationery Office.
© Crown Copyright reserved. Unauthorised reproduction infringes Crown copyright and may lead to prosecution or civil proceedings.
Licence Number LA078239 Hertsmere, 2001.

SCHEDULE OF TREES

No	Type
W1	All broadleaf trees including OAK, HORNBEAM, ASH, HAWTHORN, FIELD MAPLE and POPLAR

Map Ref: TQ 2627,9891

Hertsmere Borough Council
Civic Offices
Borehamwood
Herts WD6 1WA

SCALE: 1:2500 DATE: 11/02/04

DRAWN BY: SW CHECKED CH

DRAWING NUMBER: 6/2004