

TOWN AND COUNTRY PLANNING (TREES) REGULATIONS 1999

Plan referred to in THE HERTSMERE TREE PRESERVATION ORDER (87 and 103a Cowley Hill, Borehamwood, Herts) No 37/2004

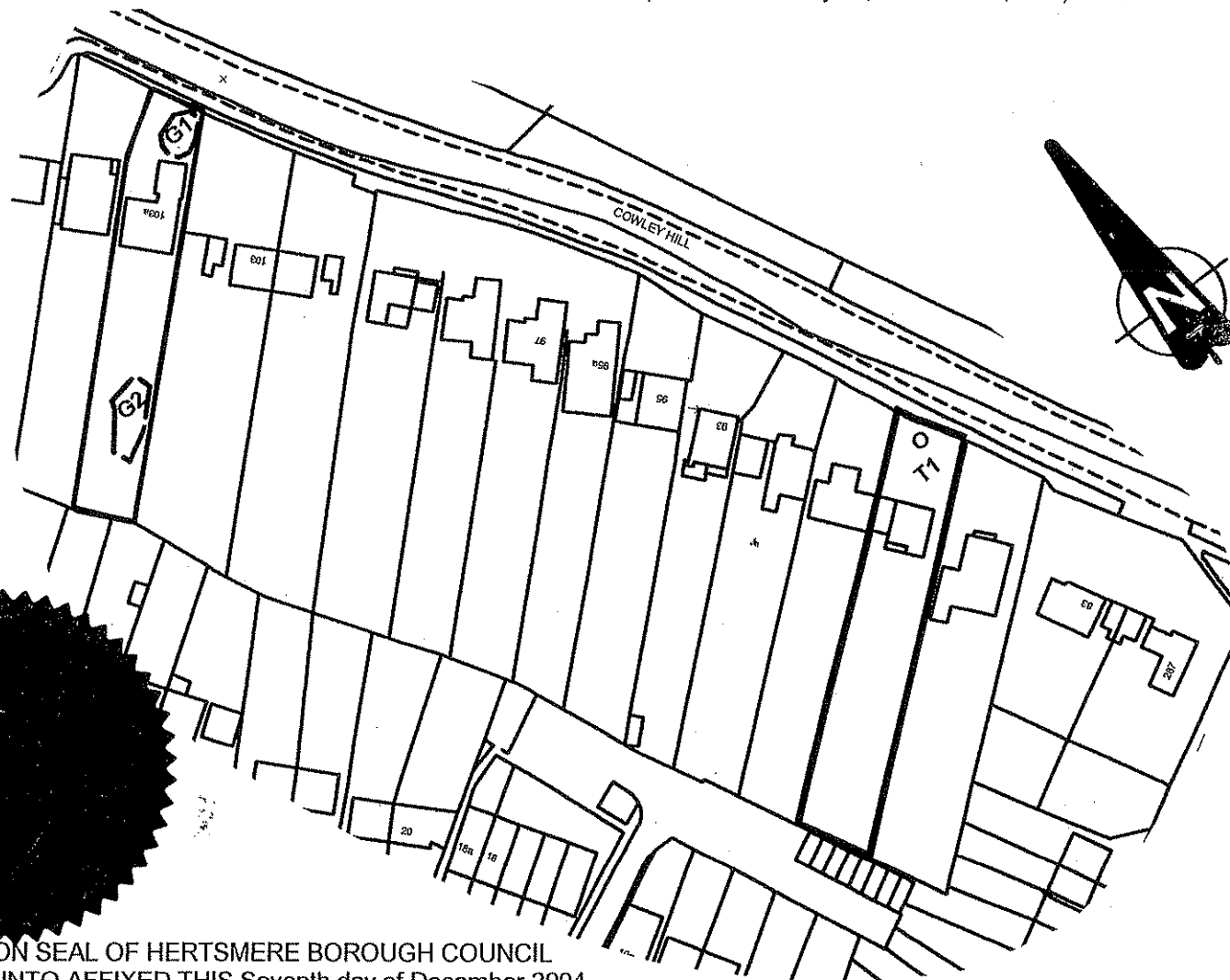

SCHEDULE OF TR

No	Type
T1	Oak
G1	2 no. Cypri
G2	2 no. Silve

This Order was confirmed
Hertsmere Borough Council
without modification
on the THIRTY FIRST
of MAY in the

Map Ref: TQ 1975,9817

Hertsmere Borough C
Civic Offices
Borehamwood
Herts WD6 1W.

THE COMMON SEAL OF HERTSMERE BOROUGH COUNCIL
WAS HEREUNTO AFFIXED THIS Seventh day of December 2004

IN THE PRESENCE OF:

SCALE: 1:1250 DA