

TOWN AND COUNTRY PLANNING (TREES) REGULATIONS 1999

Plan referred to in THE HERTSMERE TREE PRESERVATION ORDER (The Briars, Bushey Heath, Bushey, Herts) No 2/2005

This Order was confirmed by the
Hertsmere Borough Council
without modification
on the TWENTY FOURTH day
of MAY
in the year 2005

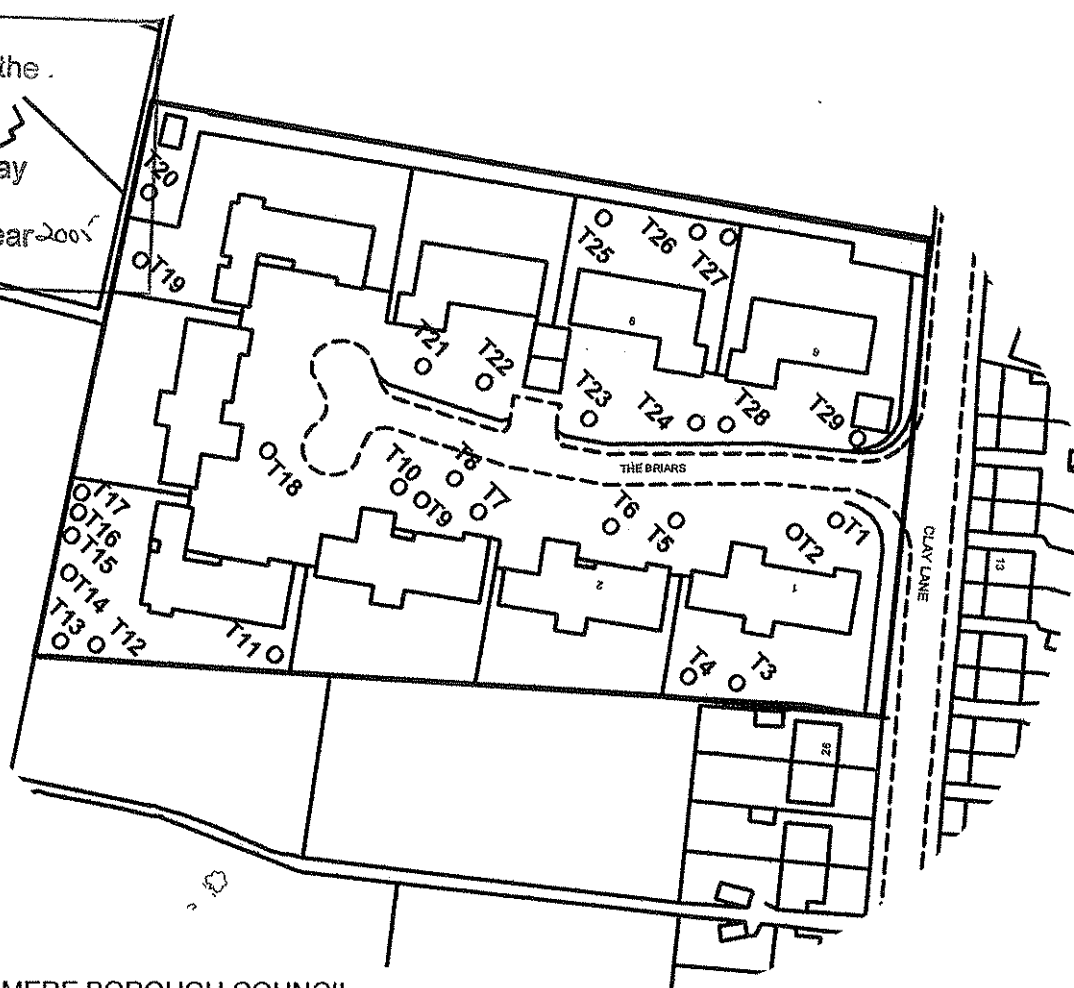

SCHEDULE OF

No	Type
T1	Oak
T2	Oak
T3	Oak
T4	Oak
T5	Oak
T6	Silver Birch
T7	Oak
T8	Oak
T9	Oak
T10	Oak
T11	Oak
T12	Oak
T13	Oak
T14	Oak
T15	Oak
T16	Hornbeam
T17	Hornbeam
T18	Oak
T19	Oak
T20	Oak
T21	Oak
T22	Oak
T23	Oak
T24	Oak
T25	Oak
T26	Oak
T27	Oak
T28	Oak
T29	Silver Birch

Map Ref: TQ 1532,945

Hertsmere Borough
Civic Office
Borehamwood
Herts WD6 1J

SCALE: 1:1250

THE COMMON SEAL OF HERTSMERE BOROUGH COUNCIL
WAS HEREUNTO AFFIXED THIS Twenty Seventh day of
January 2005

IN THE PRESENCE OF: