

# TOWN AND COUNTRY PLANNING (TREES) REGULATIONS 1999

Plan referred to in THE HERTSMERE TREE PRESERVATION ORDER (22 & 29 Aldenham Avenue, Radlett, Herts) No 35/2005

## SCHEDULE OF T

No	Type
T1	Copper B
T2	Ash

This Order was confirmed by Hertsme Borough Co without modification on the ELEVENTH of JANUARY in

Map Ref: TQ 1642,96

Hertsmere Borou  
Civic Offi  
Borehamv  
Herts WD6

SCALE: 1:1250

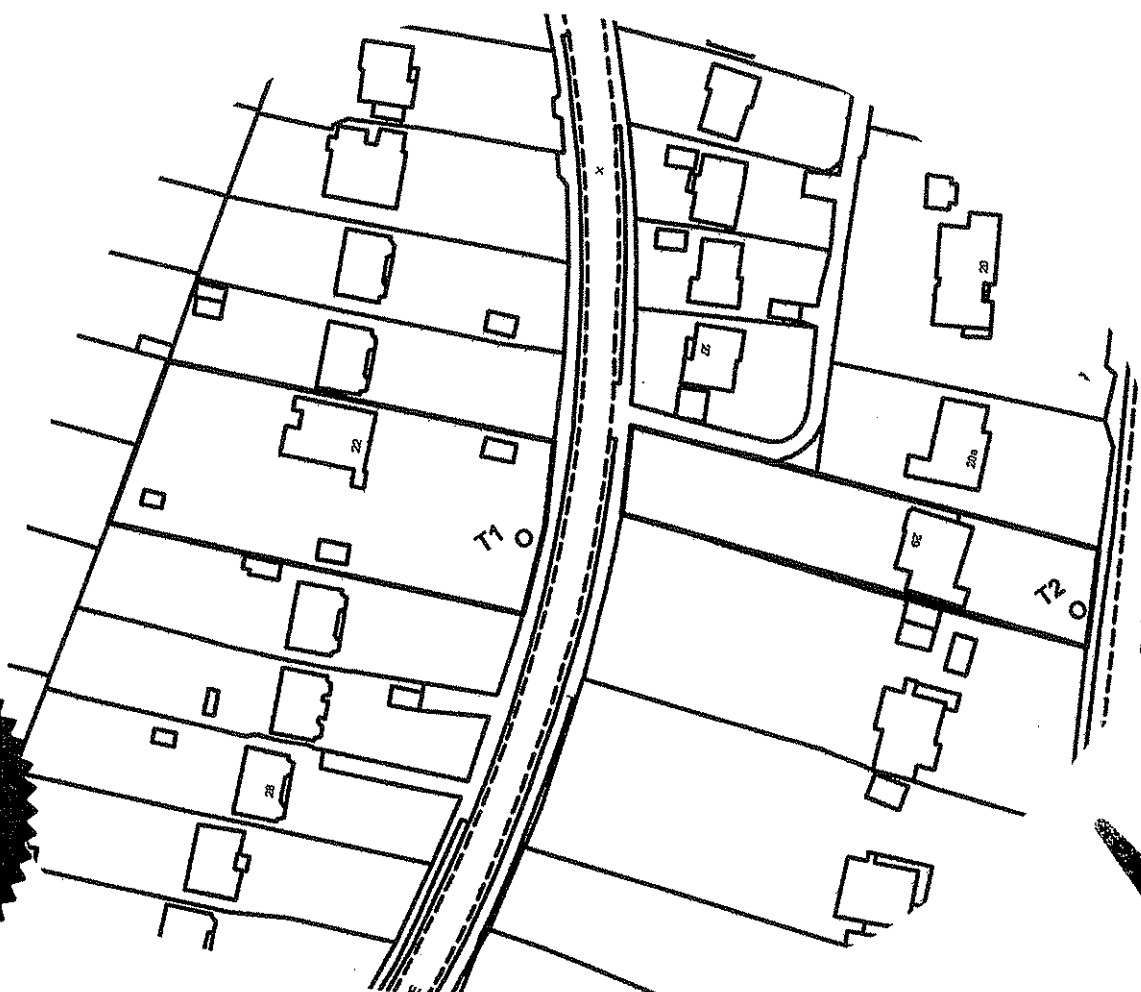

THE COMMON SEAL OF HERTSMERE BOROUGH COUNCIL  
WAS HEREUNTO AFFIXED THIS Third day of November 2005

IN THE PRESENCE OF: