

TOWN AND COUNTRY PLANNING (TREES) REGULATIONS 1999

Plan referred to in THE HERTSMERE TREE PRESERVATION ORDER (20 The Birches, Bushey, Herts) No 12/2007

SCHEDULE OF TREES

No. Type

T1 Ash

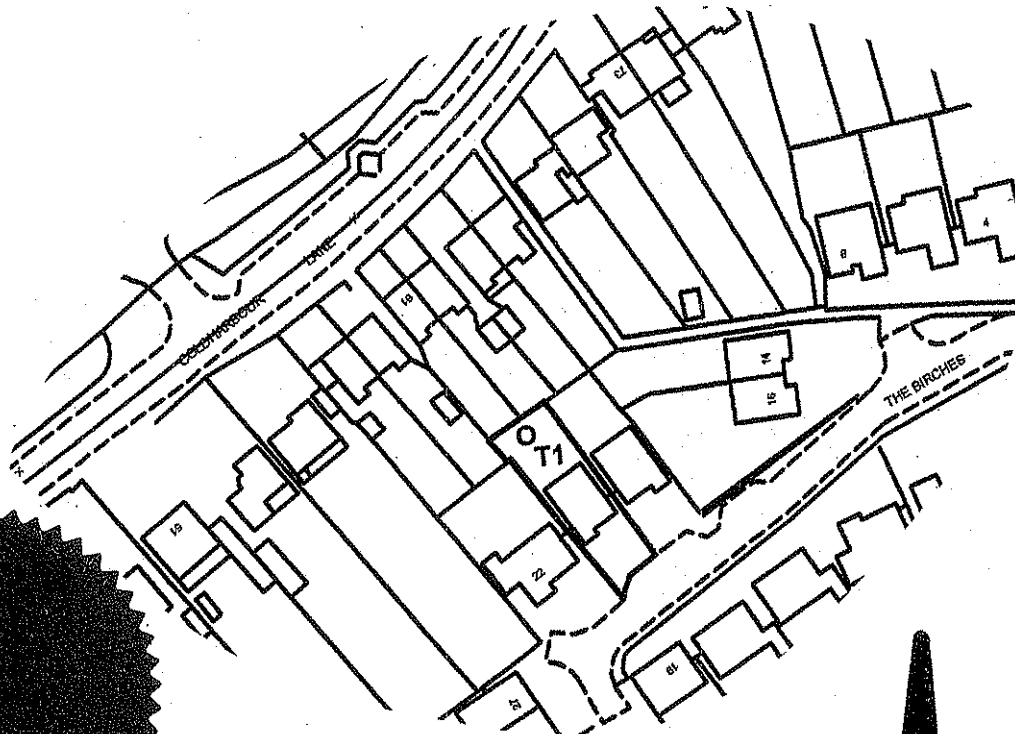

This Order was confirmed by the
Hertsmere Borough Council
without modification
on the SEVENTEENTH day
of APRIL in the year

Map Ref: TQ 1431,9558

Hertsmere Borough
Civic Offices
Borehamwood
Herts WD6 1V

SCALE: 1:1250 D

THE COMMON SEAL OF HERTSMERE BOROUGH COUNCIL
WAS HEREUNTO AFFIXED THIS Fourteenth day of February
2007