

TOWN AND COUNTRY PLANNING (TREES) REGULATIONS 1999

Plan referred to in THE HERTSMERE TREE PRESERVATION ORDER (9 Oakridge Avenue, Radlett, Herts) No 33/2007

SCHEDULE OF TR

| No | Type |
|----|-----------|
| T1 | Red Horse |
| T2 | Birch |

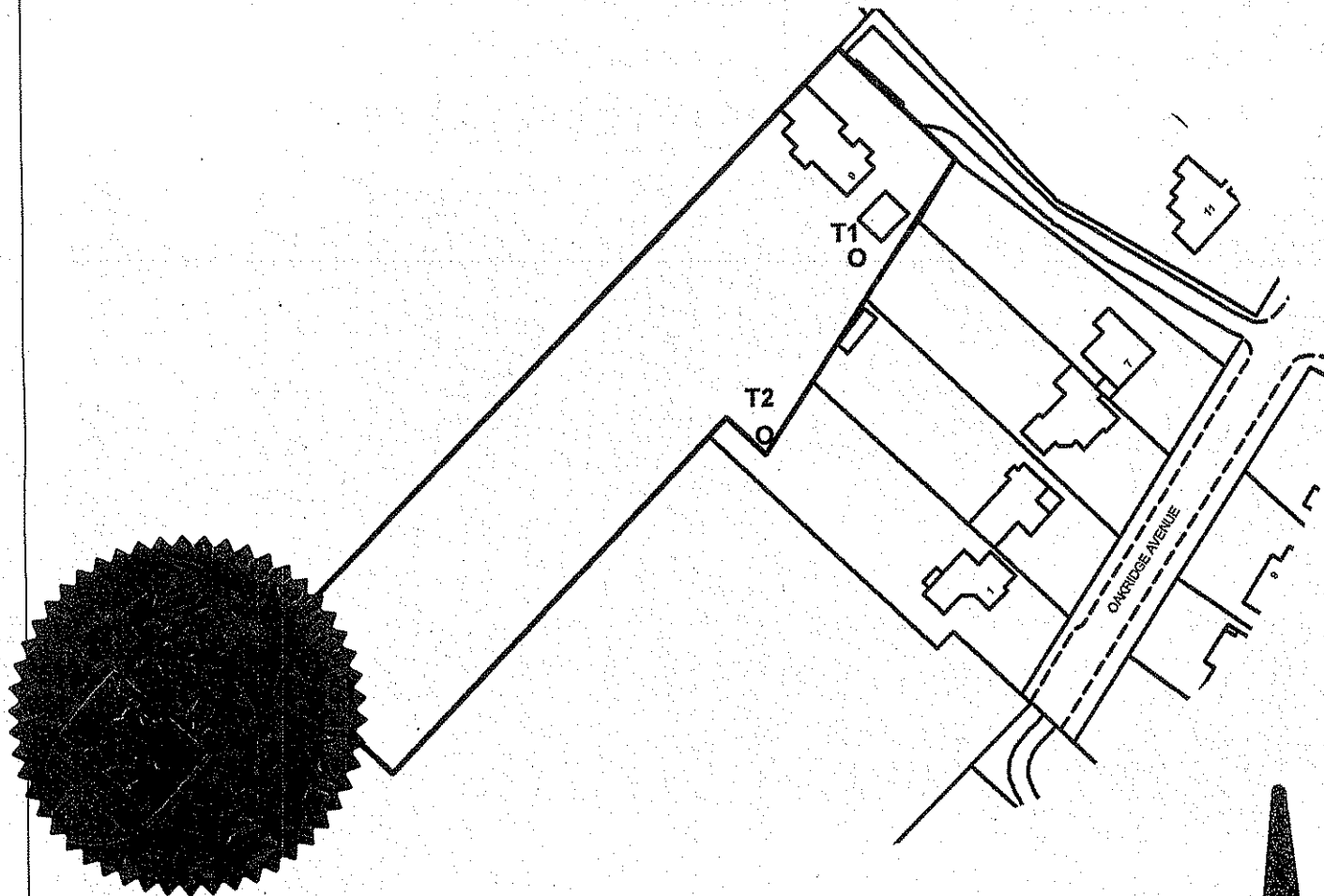

This Order was confirmed by the
Hertsmere Borough Council
without modification
on the TWENTY NINTH day
of AUGUST in the year 2007

Map Ref: TL 1552,0050

Hertsmere Borough
Civic Offices
Borehamwood
Herts WD6 1V

THE COMMON SEAL OF HERTSMERE BOROUGH COUNCIL
WAS HEREUNTO AFFIXED THIS Thirteenth day of June 2007

IN THE PRESENCE OF:

