

# TOWN AND COUNTRY PLANNING (TREES) REGULATIONS 1999

Plan referred to in THE HERTSMERE TREE PRESERVATION ORDER (87 Hartfield Avenue, Elstree, Herts) No 20/2010

## SCHEDULE OF 1

No Type

T1 Ash

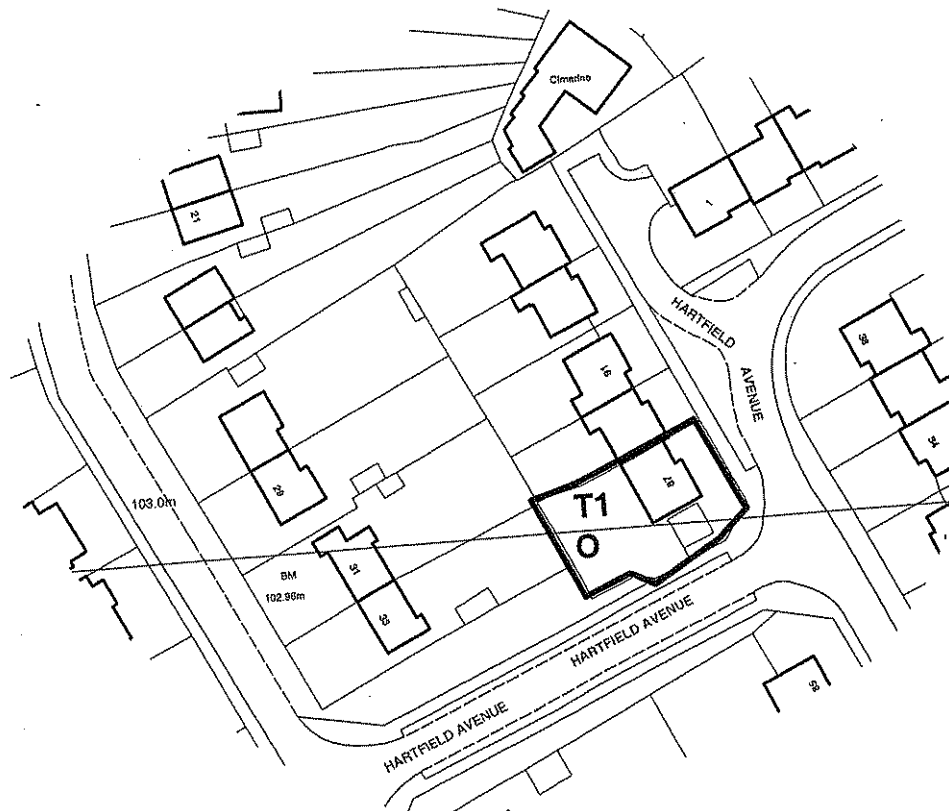

This Order was confirmed by the  
Hertsmere Borough Council subject  
to the modifications indicated by  
the modifications indicated by  
CHANGE OF ADDRESS FROM  
HARTFIELD ROAD TO HALTFIELD  
on the SECOND day  
of JUNE  
In the year 2

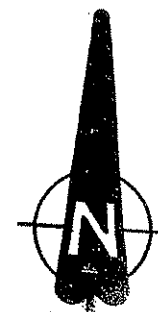

Signed on behalf of Hertsmere Borough Council Third day of  
March 2010

Authorised by the Council to sign in that behalf:

*[Handwritten signature]*

Map Ref: TQ 1901,96

Hertsmere Borough  
Civic Office  
Borehamw  
Herts WD6

SCALE: 1:1250