

**Hertsmere Borough Council  
Strategic Housing Land Availability Assessment**

**Part Two - Section 3**

**BUSHEY, ALDENHAM  
AND PATCHETS GREEN**

**LOCATION PLANS**

## **IMPORTANT INFORMATION – PLEASE READ**

### **Development Status**

This document contains details of land and sites identified to the Council as available for development. It is part of a technical study to assess future housing land supply. The Council is not at this stage proposing these sites as development land. Inclusion in the study does not oblige or imply that the Council will grant planning permission for residential development. Any planning application that comes forward will continue to be considered against current policies in national guidance, the Hertsmere Local Plan (Adopted 2003) and emerging Core Strategy.

### **Sites on Green Belt Land**

The SHLAA study considers urban sites as well as greenfield and Green Belt land. This does not mean the Council have accepted the principle of the release any land from the Green Belt. The assessment made in the study that a site has potential does not amount to 'special circumstances' for development or alter its Green Belt status. The Council will continue to resist speculative applications for housing development on Green Belt land until changes are agreed in an adopted development plan. The Council's future approach to the Green Belt will be set out in its Core Strategy document which will be subject to full public consultation.

### **Consultation on sites**

The SHLAA is a necessary technical exercise produced in consultation with local development stakeholders. The purpose of the study is to assess the amount of land with **potential** for housing and not to test whether each individual site is acceptable. Sites identified have not been subject to neighbour or wider public consultation as there is no certainty they will be allocated for development. If a planning application is received, then local consultation will take place in accordance with planning regulations. Following the adoption of a Core Strategy, the Council will publish preferred options for specific development sites which will be subject to extensive public consultation.

### **Limitations of site and Assessment Information**

Details of site constraints and boundaries are based on the information provided from agents and landowners. The SHLAA does not limit an extension or contraction of these boundaries for the purpose of a planning application. Other constraints may exist which have not been identified.

### **Ownership**

The majority of sites assessed are in private ownership. The inclusion of a site owned by the Council or County Council does not mean a formal decision has been made to sell, develop or dispose of it.

## S03 Closed swimming pool, Falconer Road, Bushey

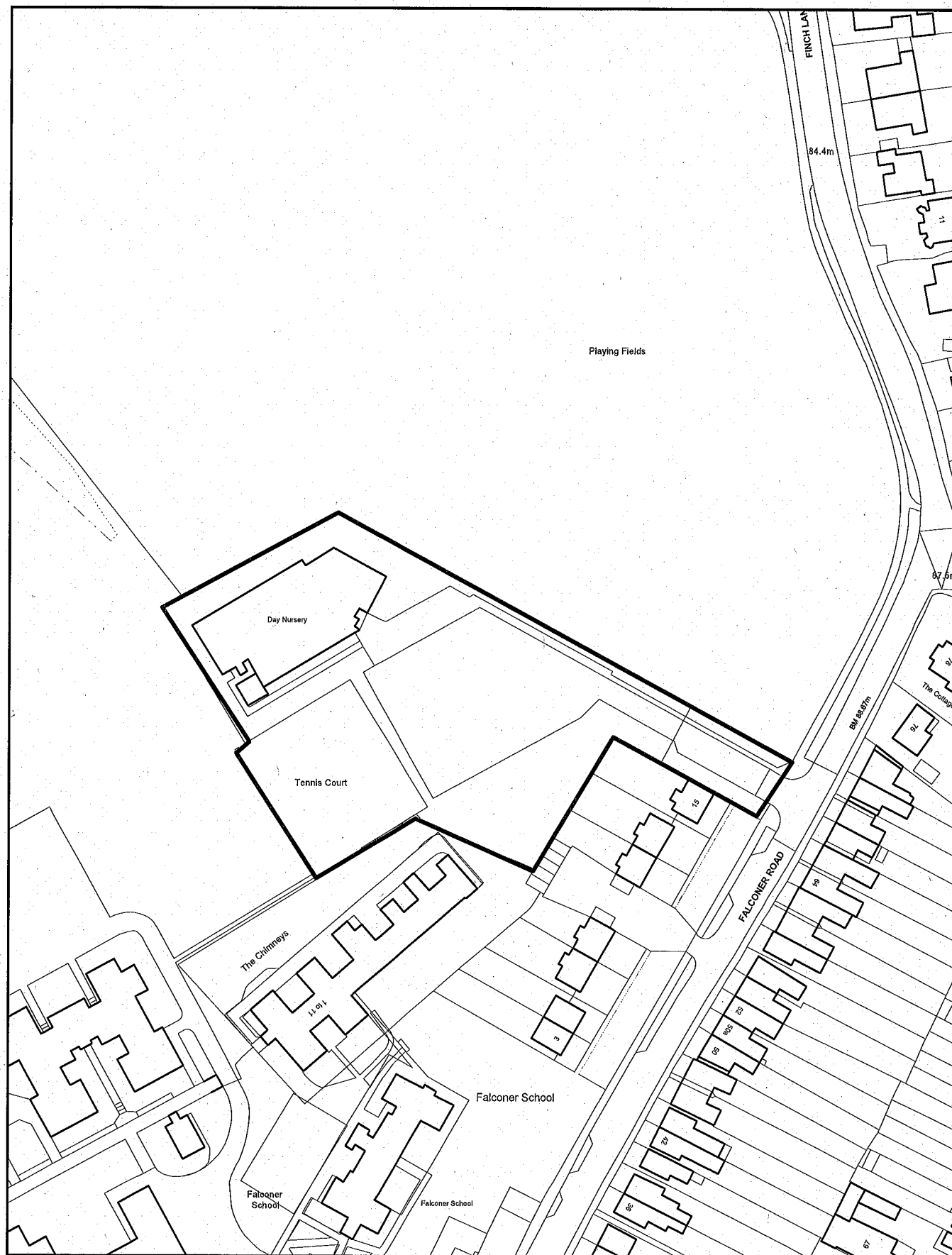

Reproduced from the Ordnance Survey mapping with the permission of the controller of Her Majesty's Stationery Office. Crown copyright. Unauthorised reproduction infringes Crown copyright and may lead to prosecution or civil proceedings.

Hertsmere Borough Council. Licence No:10017428



Scale: 1:1250

Date: 28.10.2009

# S9 Birchville Court, Heathbourne Road

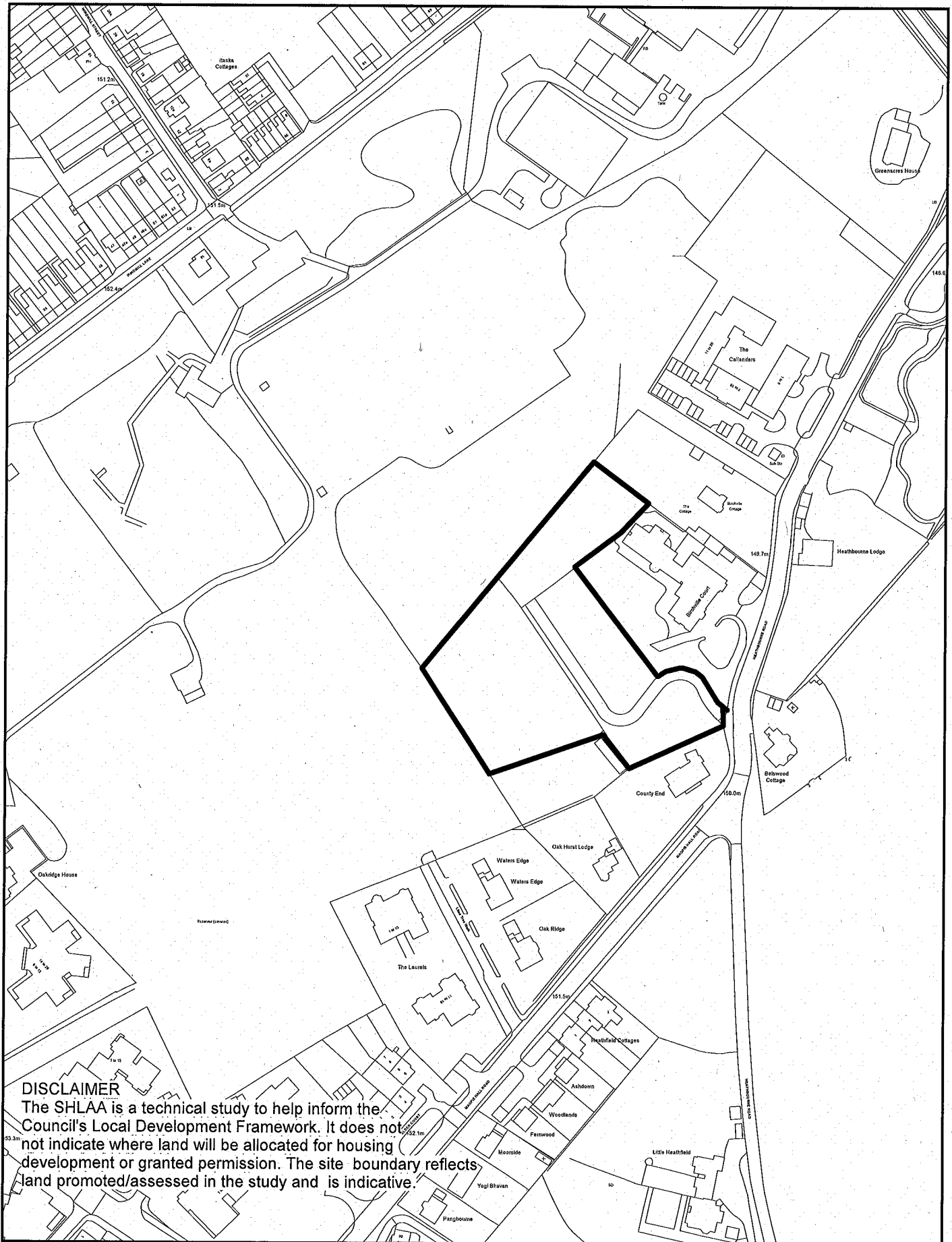

Reproduced from the Ordnance Survey mapping with the permission of the controller of Her Majesty's Stationery Office. Crown copyright. Unauthorised reproduction infringes Crown copyright and may lead to prosecution or civil proceedings. Hertsmere Borough Council Licence 10017428.;



**NOT TO SCALE**

# S10 Bushey Hall Farm Site

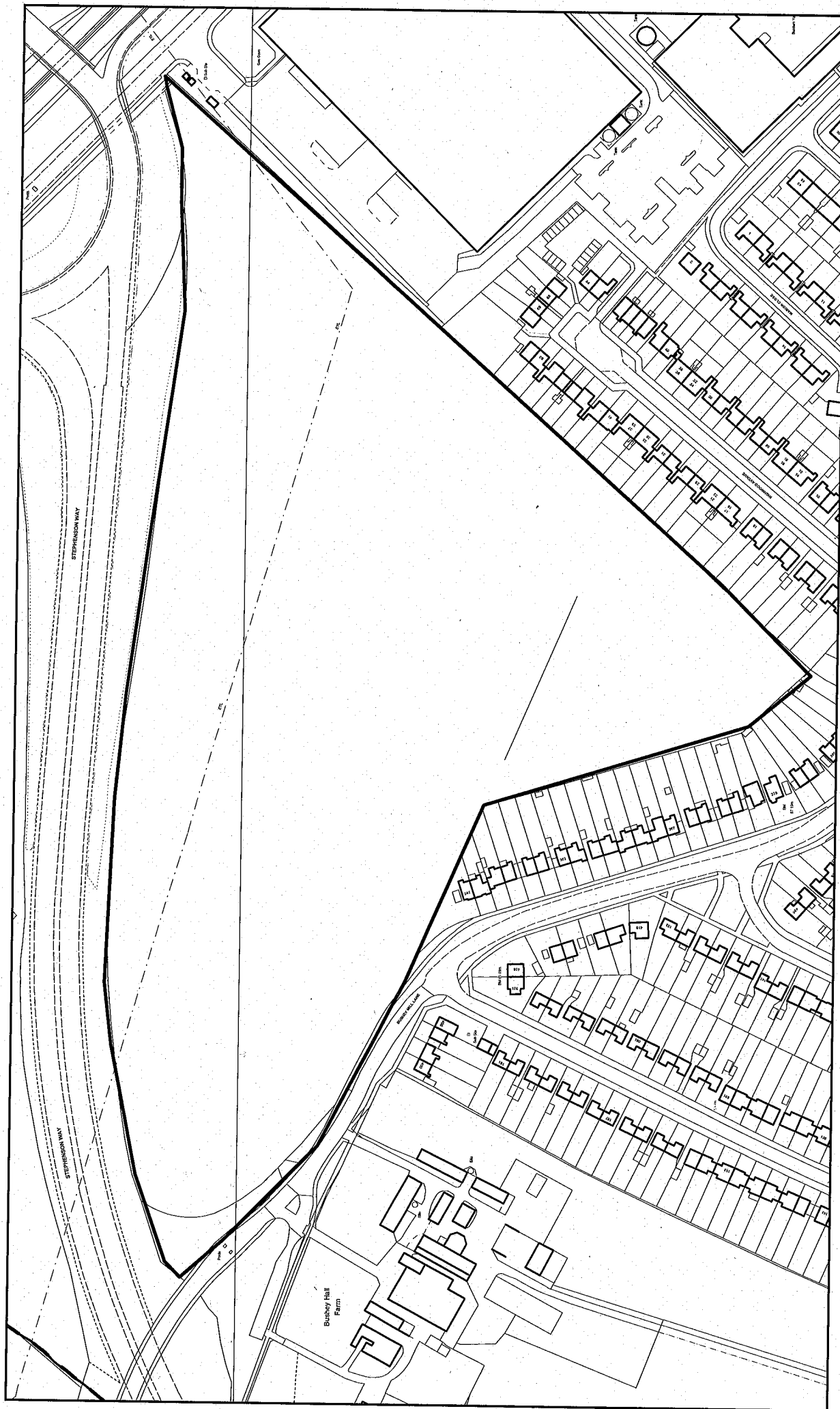

Reproduced from the Ordnance Survey mapping with the permission of the controller of Her Majesty's Stationery Office. Crown copyright. Unauthorised reproduction infringes Crown copyright and may lead to prosecution or civil proceedings.

Scale: 1:2500

Hertsmere Borough Council. Licence No:10017428

Date: 20091030

# S21 Metropolitan Sports Club, Aldenham Road, Bushey



Reproduced from the Ordnance Survey mapping with the permission of the controller of Her Majesty's Stationery Office. Crown copyright. Unauthorised reproduction infringes Crown copyright and may lead to prosecution or civil proceedings.

Scale: 1:2500  
Date: 20091030



Hertsmere Borough Council. Licence No:10017428

# S23 23 Glencoe Road, Bushey



This copy has been produced specifically for Land and Property Search purposes only. No further copies may be made. Reproduced from the Ordnance Survey mapping with the permission of the controller of Her Majesty's Stationery Office. Crown copyright. Unauthorised reproduction infringes Crown copyright and may lead to prosecution or civil proceedings. Hertsmere Borough Council. Licence No:10017428



Scale 1:500

Date: 28.10.2009

# **S24 Land Adjacent to the Ramada Hotel, A41 Watford Bypass**

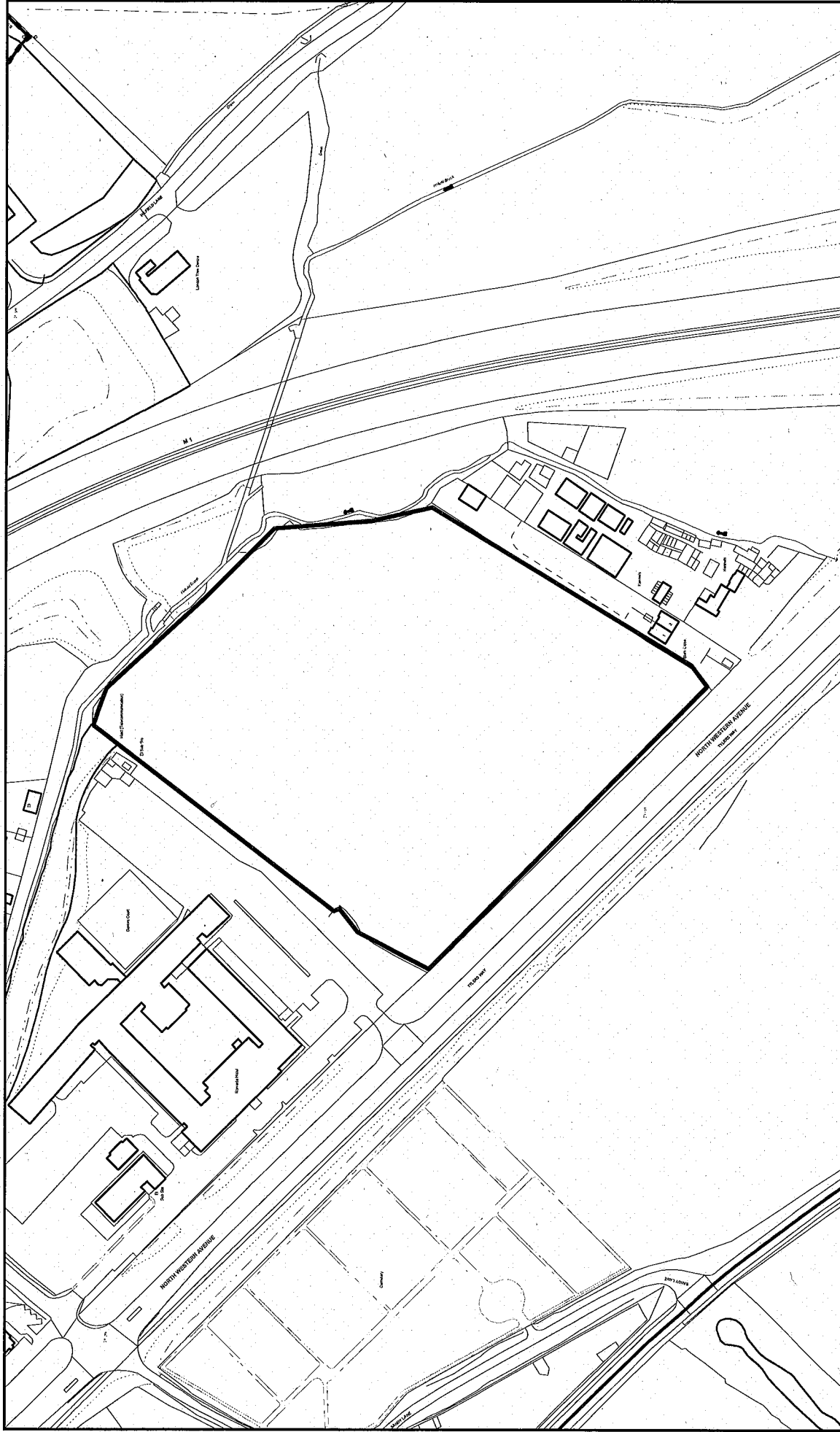

Reproduced from the Ordnance Survey mapping with the permission of the controller of Her Majesty's Stationery Office. Crown copyright. Unauthorised reproduction infringes Crown copyright and may lead to prosecution or civil proceedings.

Hertsmere Borough Council. Licence No: 10017428

Scale: 1:2500

Date: 28.10.2009





Hertsmere Borough Council. Licence No:10017428



Scale: 1:2500  
Date: 28.10.2009

# S33 Land at Bushey Hall Golf Club, Bushey



Reproduced from the Ordnance Survey mapping with the permission of the controller of Her Majesty's Stationery Office. Crown copyright. Unauthorised reproduction infringes Crown copyright and may lead to prosecution or civil proceedings.

Hertsmere Borough Council. Licence No:10017428



Date: 02.10.2009

## S34 Land off Hartspring Lane, Bushey



Reproduced from the Ordnance Survey mapping with the permission of the controller of Her Majesty's Stationery Office. Crown copyright. Unauthorised reproduction infringes Crown copyright and may lead to prosecution or civil proceedings.

Hertsmere Borough Council. Licence No:10017428



Scale: 1:1250

Date: 29.10.2009

## S36 Land East of Farm Way, Bushey.



Reproduced from the Ordnance Survey mapping with the permission of the controller of Her Majesty's Stationery Office. Crown copyright. Unauthorised reproduction infringes Crown copyright and may lead to prosecution or civil proceedings.

Hertsmere Borough Council. Licence No:10017428



Scale: 1:1250

Date: 28.10.2009

## S38 White Cottage and Roundcroft Kennels, Sandy Lane, Bushey

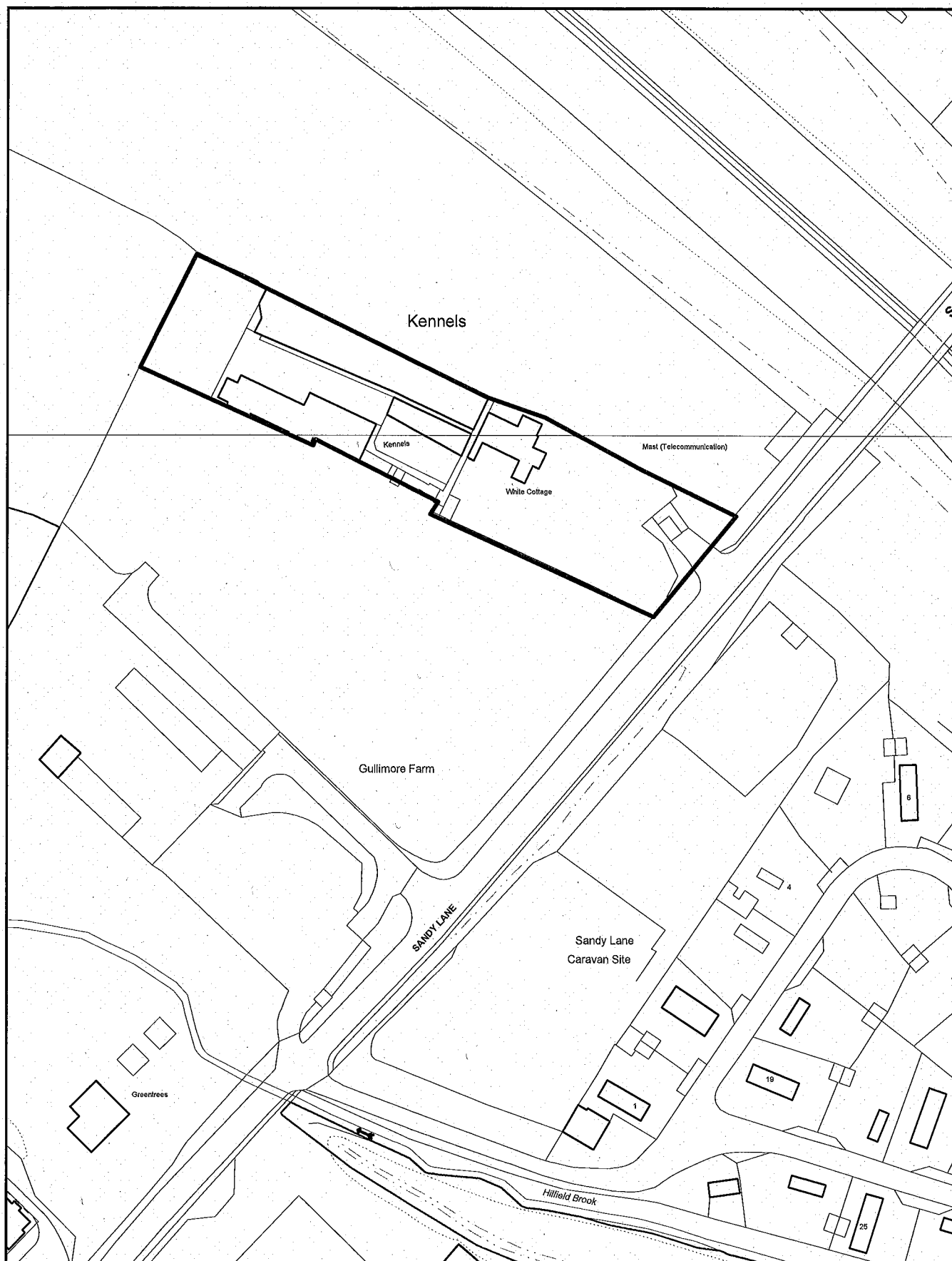

Reproduced from the Ordnance Survey mapping with the permission of the controller of Her Majesty's Stationery Office. Crown copyright. Unauthorised reproduction infringes Crown copyright and may lead to prosecution or civil proceedings.

Hertsmere Borough Council. Licence No:10017428



Scale: 1:1250

Date: 28.10.2009

# S41 Attenborough's Fields, Merryhill Road, Bushey



Reproduced from the Ordnance Survey mapping with the permission of the controller of Her Majesty's Stationery Office. Crown copyright. Unauthorised reproduction infringes Crown copyright and may lead to prosecution or civil proceedings.

Hertsmere Borough Council. Licence No:10017428



Scale: 1:2500  
Date: 30.10.2009

## S42 land at Little Bushey Lane, Bushey

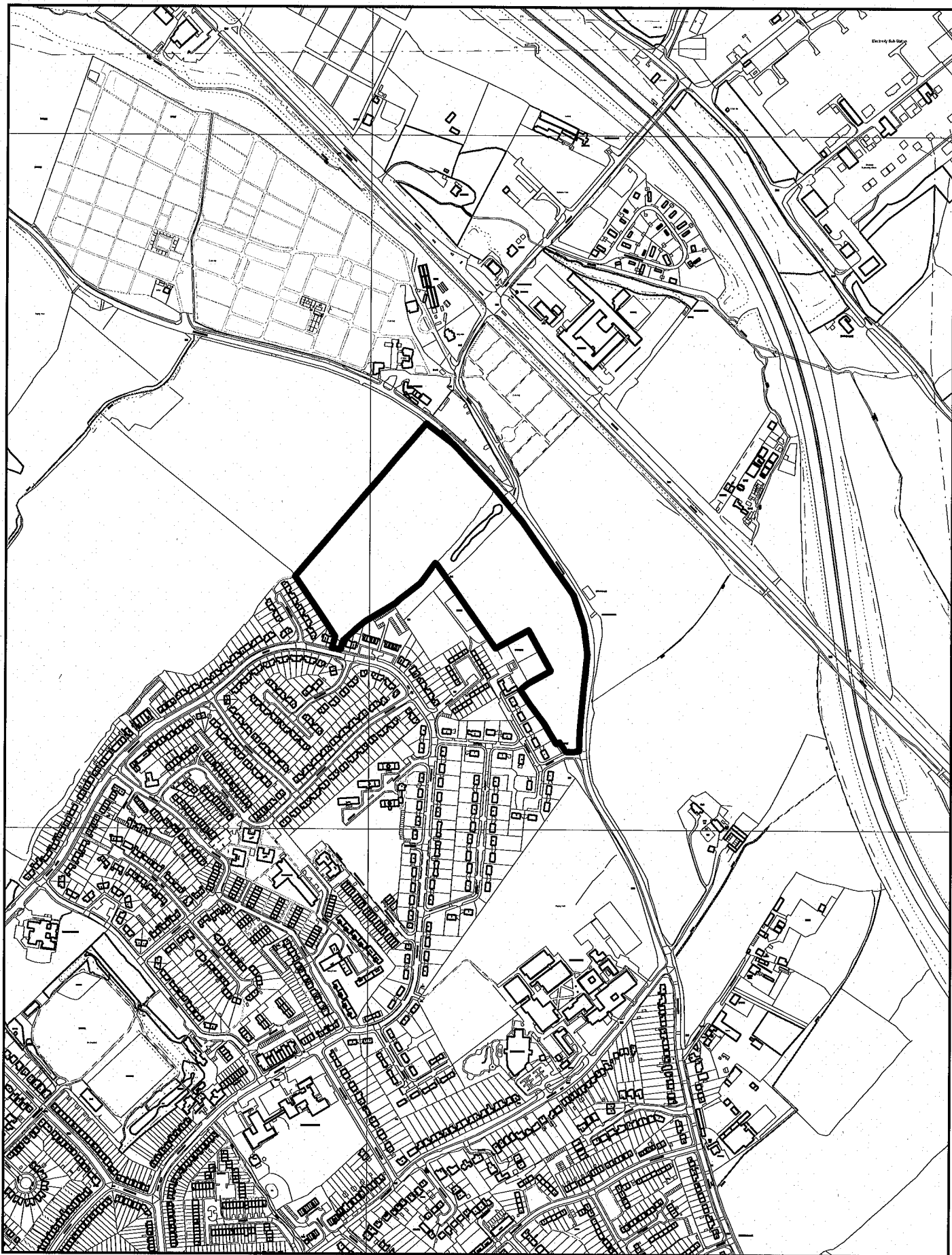

Reproduced from the Ordnance Survey mapping with the permission of the controller of Her Majesty's Stationery Office. Crown copyright. Unauthorised reproduction infringes Crown copyright and may lead to prosecution or civil proceedings.

Hertsmere Borough Council. Licence No:10017428



Not to Scale  
Date: 28 October 2009

# S43 Winfield Yard, Bushey

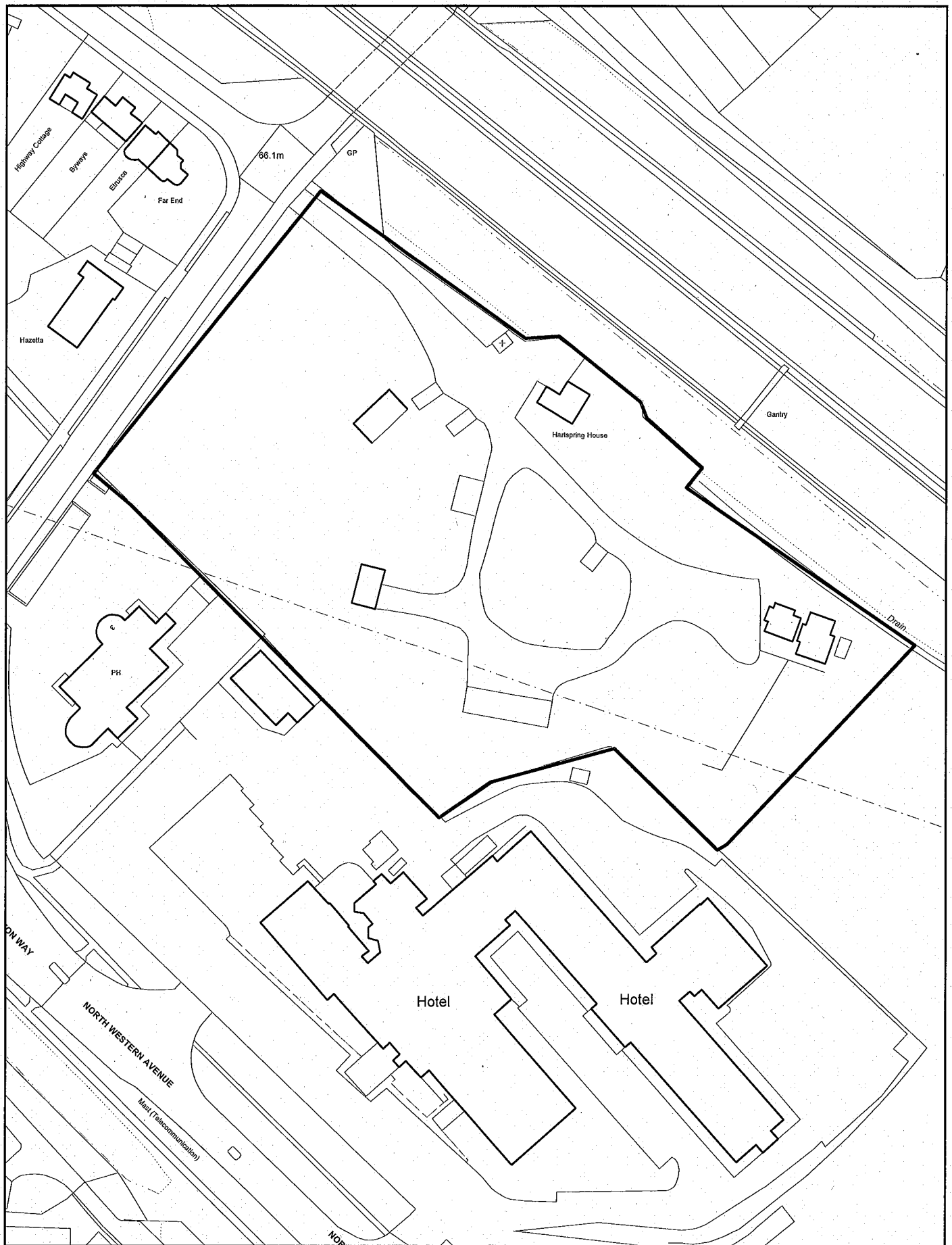

Reproduced from the Ordnance Survey mapping with the permission of the controller of Her Majesty's Stationery Office. Crown copyright. Unauthorised reproduction infringes Crown copyright and may lead to prosecution or civil proceedings.

Hertsmere Borough Council. Licence No:10017428



Scale: 1:1250

Date: 28.10.2009



Hertsmere Borough Council. Licence No:10017428



**Date: 28.10.2009**

# **S49 Land to the rear of Richfield Road and Clarks Mead**

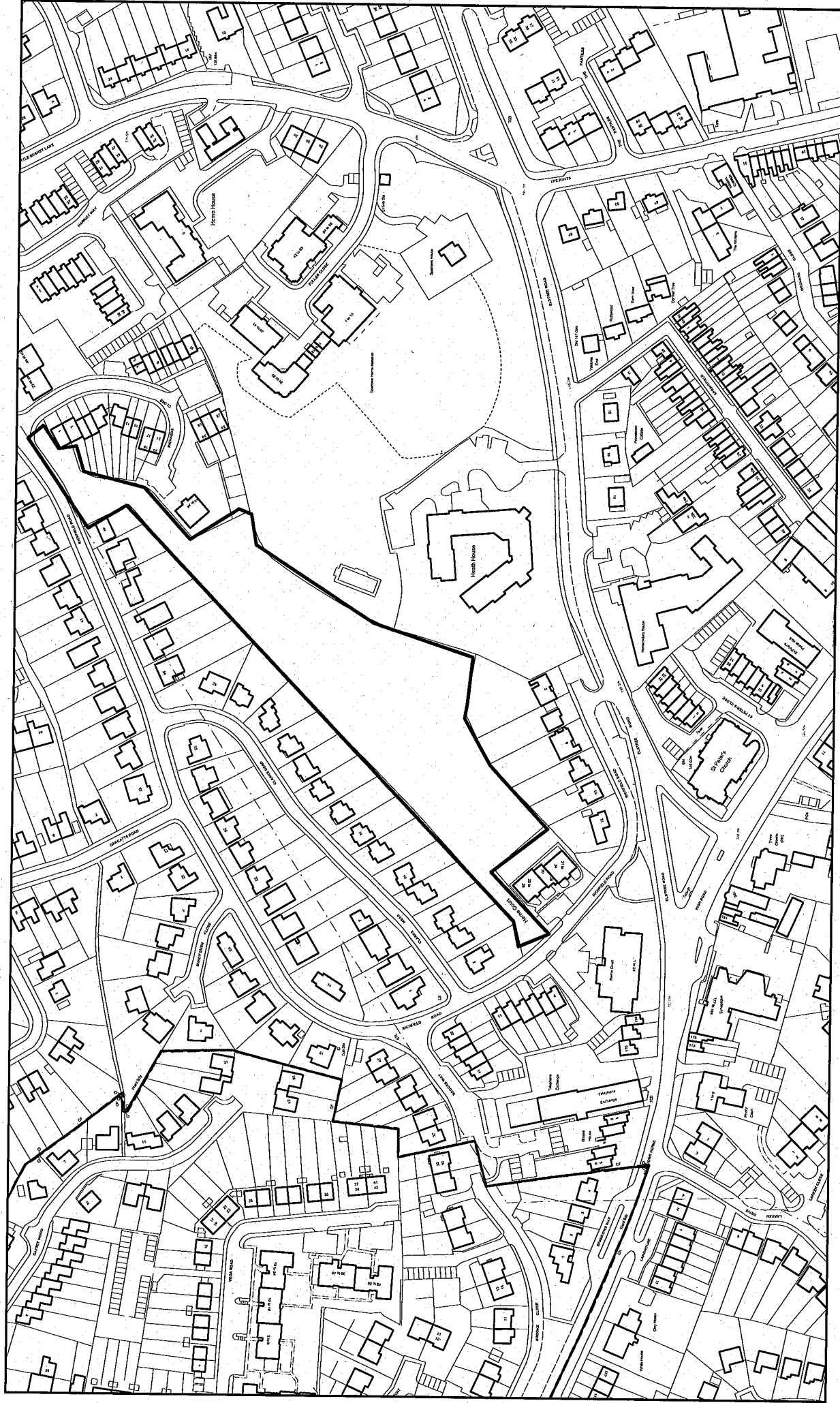

**Scale: 1:2500**  
**Date: 20091028**



Reproduced from the Ordnance Survey mapping with the permission of the controller of Her Majesty's Stationery Office. Crown copyright. Unauthorised reproduction infringes Crown copyright and may lead to prosecution or civil proceedings.

Hertsmere Borough Council. Licence No:10017428

# S57 Haydon Dell Industrial Estate, Bushey

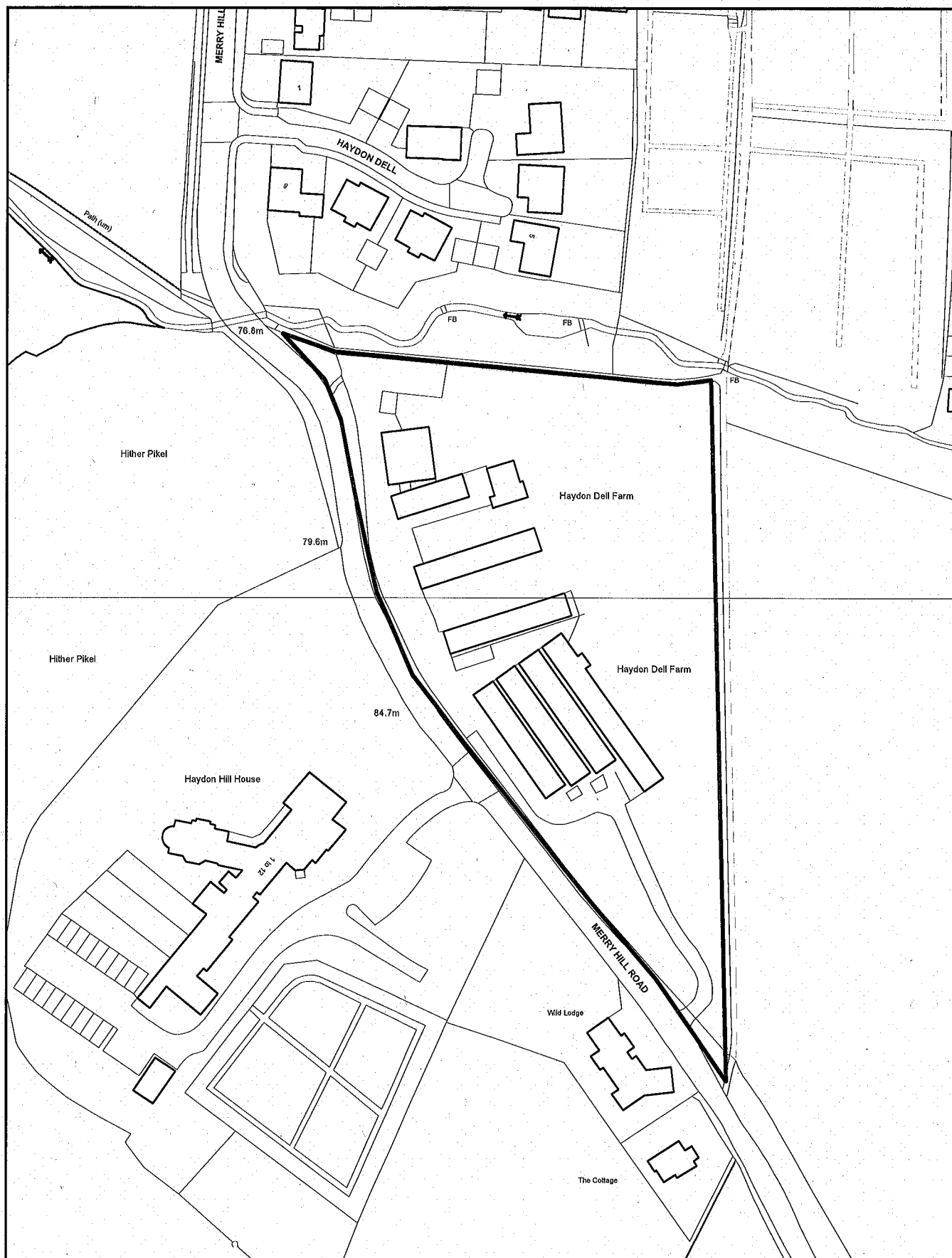

Reproduced from the Ordnance Survey mapping with the permission of the controller of Her Majesty's Stationery Office. Crown copyright. Unauthorised reproduction infringes Crown copyright and may lead to prosecution or civil proceedings.

Hertsmere Borough Council. Licence No:10017428



Scale: 1:1250

Date: 20091028

# S58 Land off Bushey Hall Road, East of rail line, Bushey

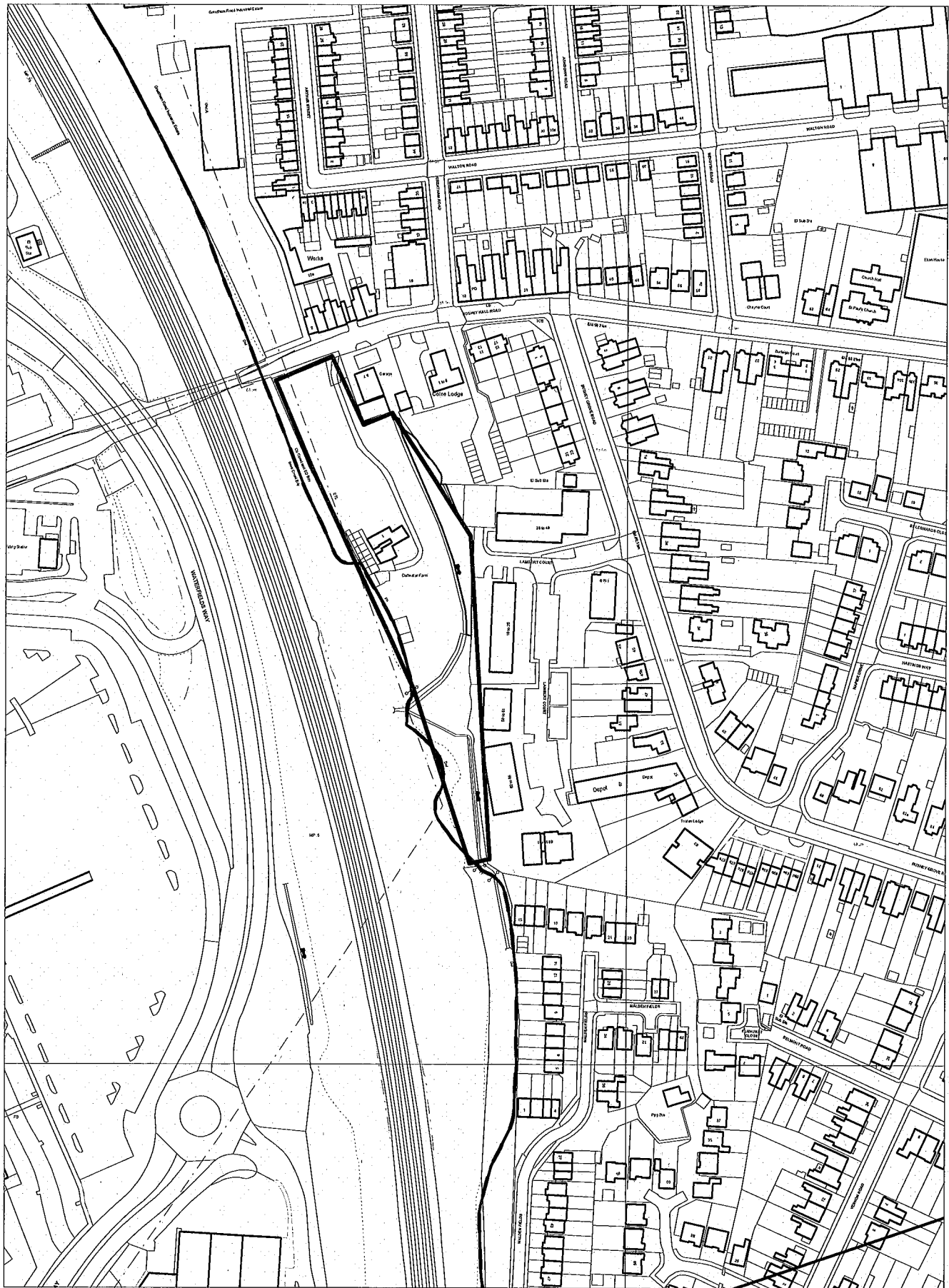

Reproduced from the Ordnance Survey mapping with the permission of the controller of Her Majesty's Stationery Office. Crown copyright. Unauthorised reproduction infringes Crown copyright and may lead to prosecution or civil proceedings.

Hertsmere Borough Council. Licence No:10017428



Scale: 1:2500  
Date: 28.10.2009

# S72 Rossway Industrial Estate, Bushey



Reproduced from the Ordnance Survey mapping with the permission of the controller of Her Majesty's Stationery Office. Crown copyright. Unauthorised reproduction infringes Crown copyright and may lead to prosecution or civil proceedings.

Hertsmere Borough Council. Licence No:10017428



Scale: 1:2500  
Date: 28.10.2009

# S74 121 - 123 Aldenham Road, Bushey



Reproduced from the Ordnance Survey mapping with the permission of the controller of Her Majesty's Stationery Office. Crown copyright. Unauthorised reproduction infringes Crown copyright and may lead to prosecution or civil proceedings.

Hertsmere Borough Council. Licence No:10017428



Scale: 1:1250

Date: 28.10. 2009

## S77 4 Clarence Close, Bushey



Reproduced from the Ordnance Survey mapping with the permission of the controller of Her Majesty's Stationery Office. Crown copyright. Unauthorised reproduction infringes Crown copyright and may lead to prosecution or civil proceedings.

Hertsmere Borough Council. Licence No:10017428



Scale: 1:1250

Date: 28.10.2009

# S78 Land rear of 24 Melbourne Road, Bushey

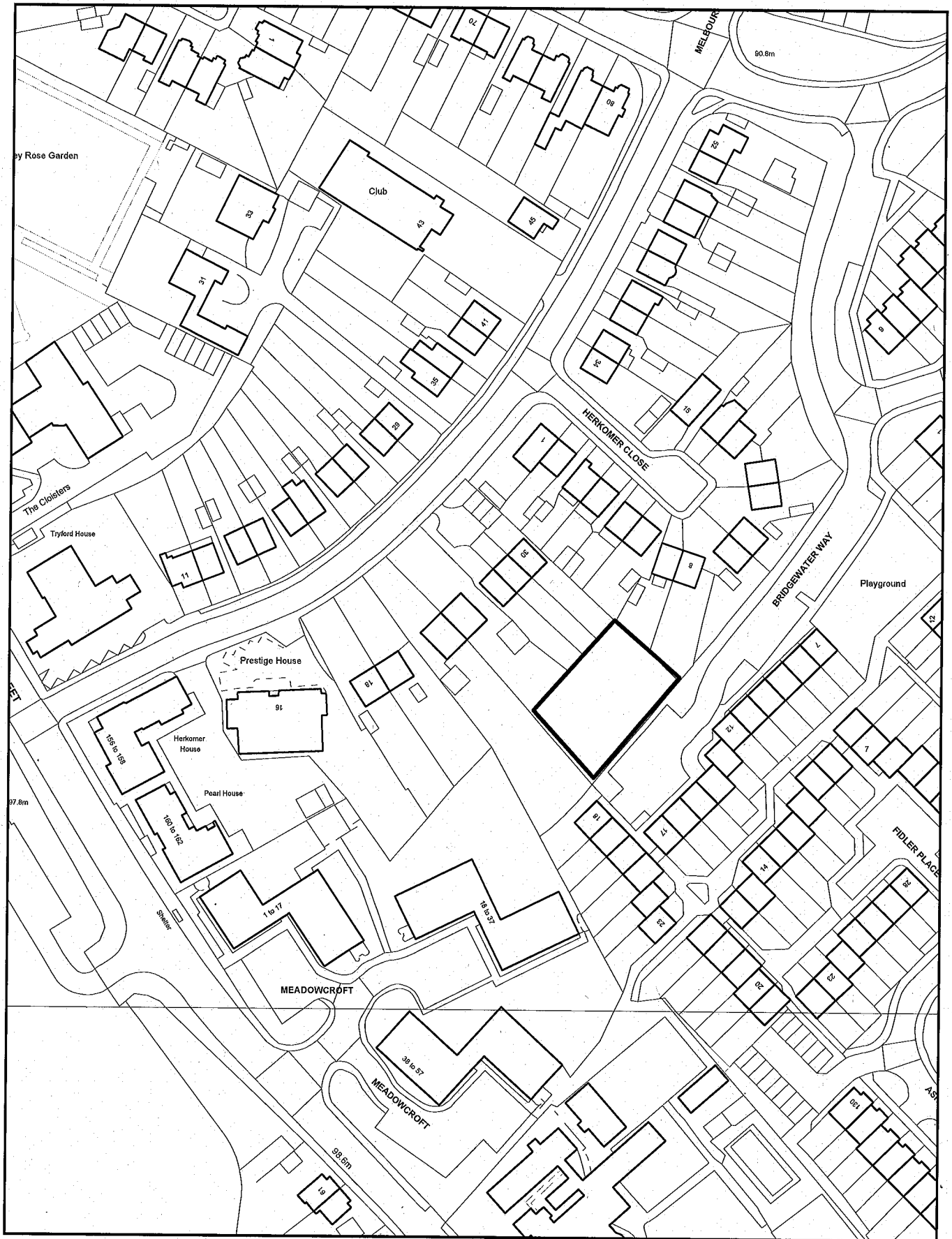

Reproduced from the Ordnance Survey mapping with the permission of the controller of Her Majesty's Stationery Office. Crown copyright. Unauthorised reproduction infringes Crown copyright and may lead to prosecution or civil proceedings.

Hertsmere Borough Council. Licence No:10017428



Scale: 1:1250

Date: 28.10.2009



# S80 Roundbush Garage, Roundbush Lane.

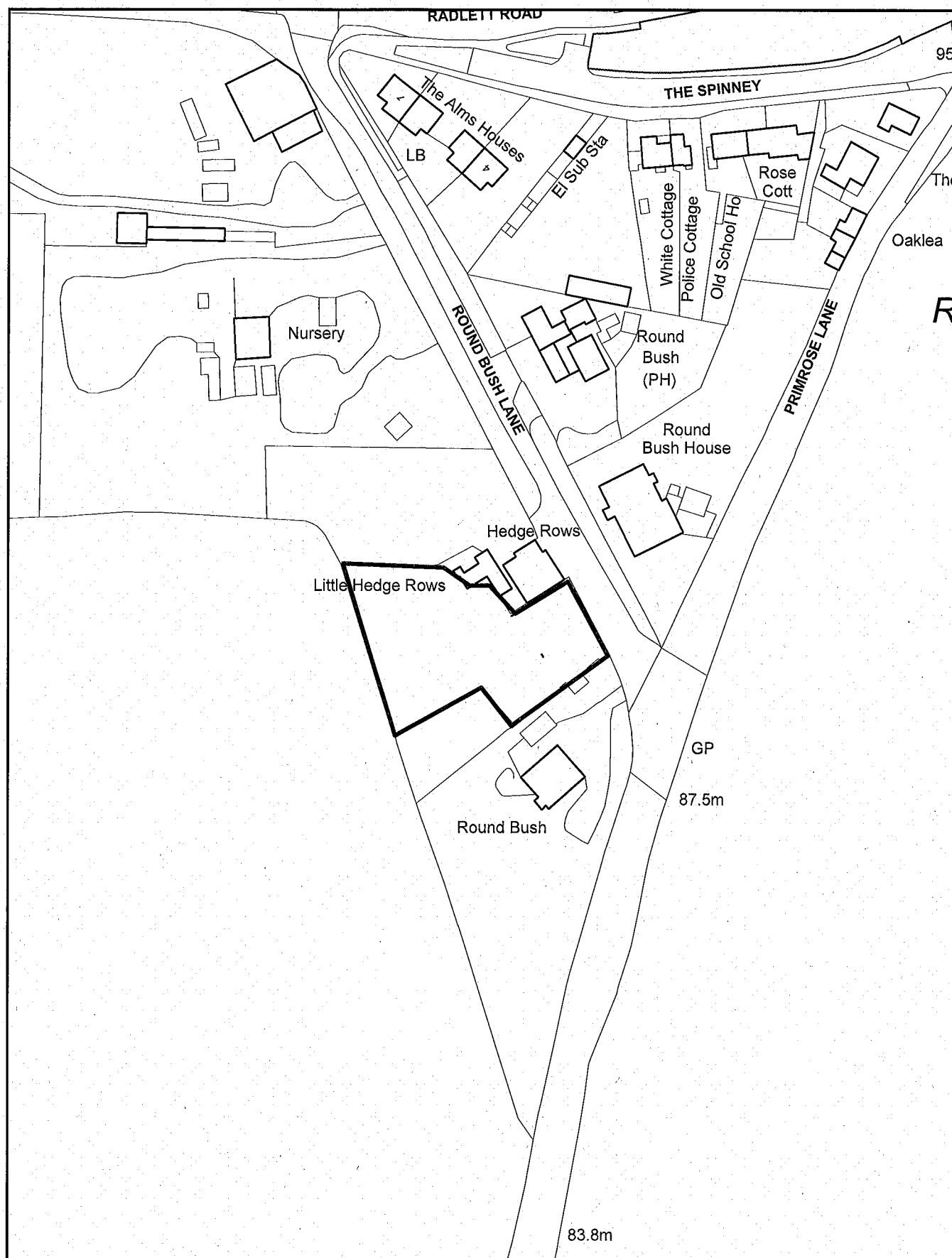

Reproduced from the Ordnance Survey mapping with the permission of the controller of Her Majesty's Stationery Office. Crown copyright. Unauthorised reproduction infringes Crown copyright and may lead to prosecution or civil proceedings.

Hertsmere Borough Council. Licence No:10017428



Scale: 1:1250

Date: 28.10.2009

# S81 125-127 High Road, Bushey



Reproduced from the Ordnance Survey mapping with the permission of the controller of Her Majesty's Stationery Office. Crown copyright. Unauthorised reproduction infringes Crown copyright and may lead to prosecution or civil proceedings.

Hertsmere Borough Council. Licence No:10017428



Scale: 1:1250

Date: 28.10.2009

# S84 2a Windmill Lane and 164-168 High Road, Bushey

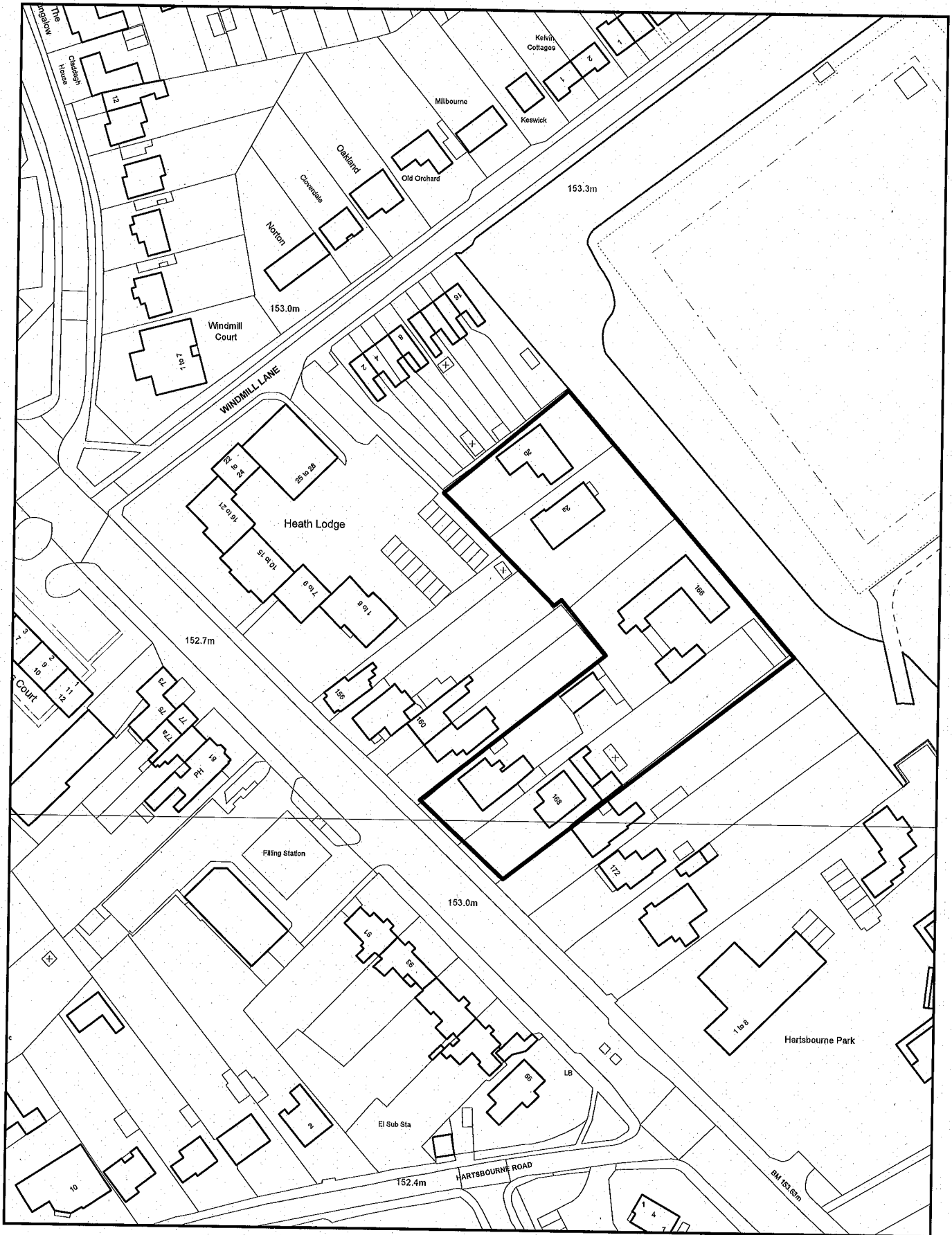

Reproduced from the Ordnance Survey mapping with the permission of the controller of Her Majesty's Stationery Office. Crown copyright. Unauthorised reproduction infringes Crown copyright and may lead to prosecution or civil proceedings.

Hertsmere Borough Council. Licence No:10017428



Scale: 1:1250

Date: 28.10.2009

# S87 2-8 Hartsbourne Road, Bushey

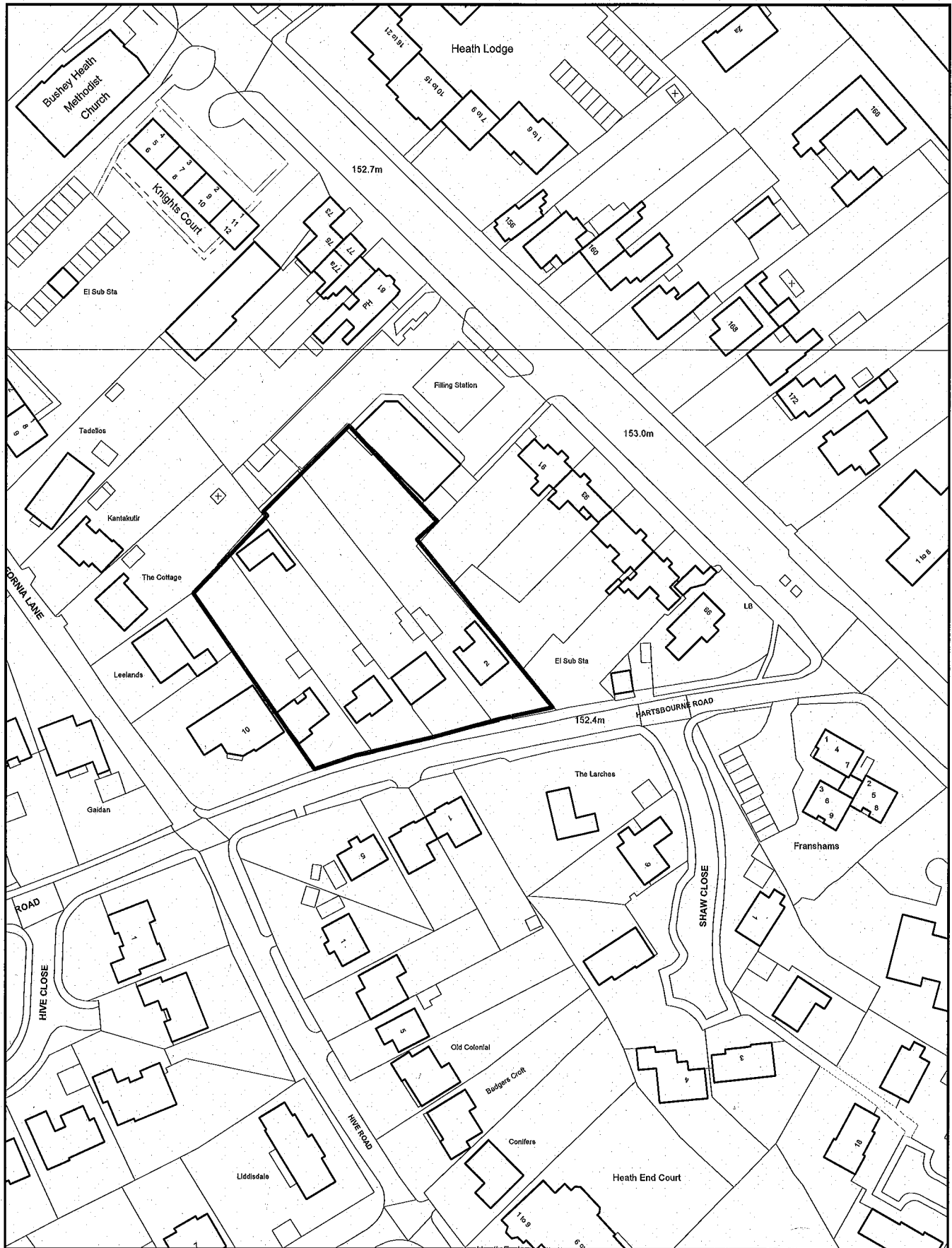

Reproduced from the Ordnance Survey mapping with the permission of the controller of Her Majesty's Stationery Office. Crown copyright. Unauthorised reproduction infringes Crown copyright and may lead to prosecution or civil proceedings.

Hertsmere Borough Council. Licence No:10017428



Scale: 1:1250

Date: 28.10.2009

# S134 The Otter Public House, Bushey Mill Lane, Bushey



Reproduced from the Ordnance Survey mapping with the permission of the controller of Her Majesty's Stationery Office. Crown copyright. Unauthorised reproduction infringes Crown copyright and may lead to prosecution or civil proceedings.

Hertsmere Borough Council. Licence No:10017428



Scale: 1:1250

Date: 28.10.2009

# S135 Herne House, 3 Little Bushey Lane, Bushey

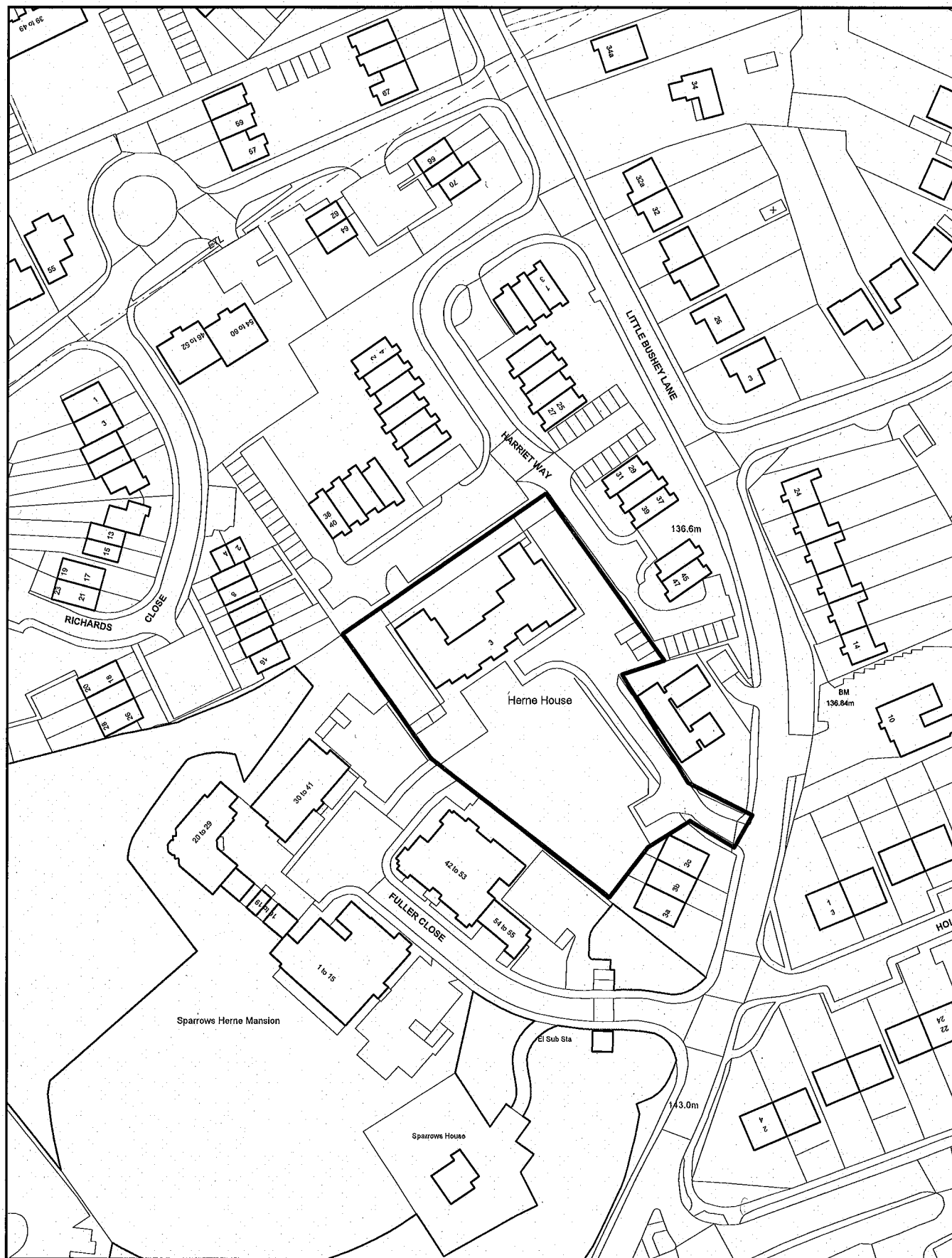

Reproduced from the Ordnance Survey mapping with the permission of the controller of Her Majesty's Stationery Office. Crown copyright. Unauthorised reproduction infringes Crown copyright and may lead to prosecution or civil proceedings.

Hertsmere Borough Council. Licence No:10017428



Scale: 1:1250

Date: 28.10.2009

## S136 Land at Caldecote Gardens, Bushey



Reproduced from the Ordnance Survey mapping with the permission of the controller of Her Majesty's Stationery Office. Crown copyright. Unauthorised reproduction infringes Crown copyright and may lead to prosecution or civil proceedings.

Hertsmere Borough Council. Licence No:10017428



Scale: 1:1250

Date: 28.10.2009

# S152 5 Grange Road, Bushey



Reproduced from the Ordnance Survey mapping with the permission of the controller of Her Majesty's Stationery Office. Crown copyright. Unauthorised reproduction infringes Crown copyright and may lead to prosecution or civil proceedings.

Hertsmere Borough Council. Licence No:10017428



Scale: 1:1250

Date: 28.10.2009



# S300 Pegmire Lane, Patchetts Green

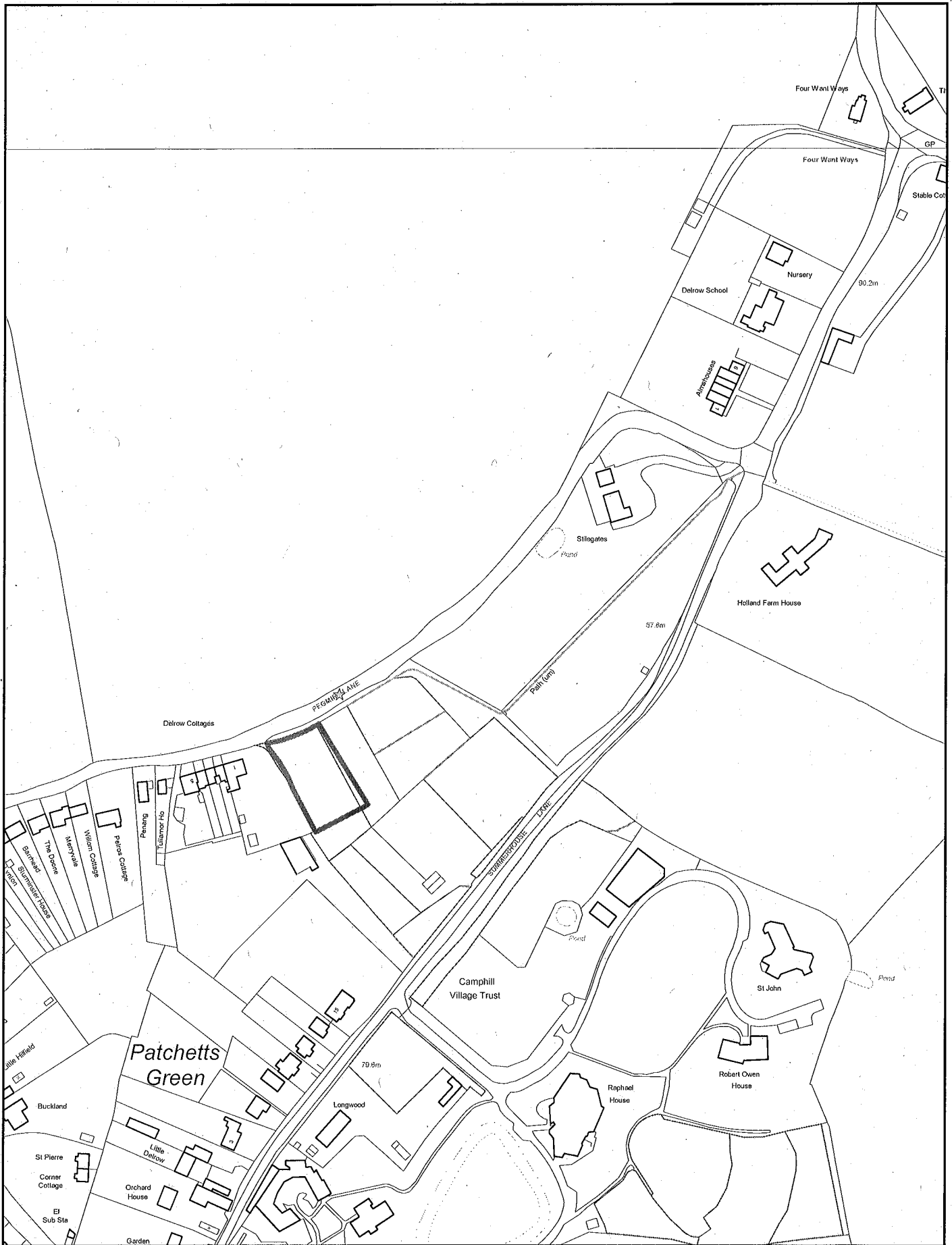

Reproduced from the Ordnance Survey mapping with the permission of the controller of Her Majesty's Stationery Office. Crown copyright. Unauthorised reproduction infringes Crown copyright and may lead to prosecution or civil proceedings.

Hertsmere Borough Council. Licence No:10017428



**Not to Scale**  
**Date: 28 October 2009**